

Mounting instruction



LD BOX TRADITIONAL MATING STALL



ACO FUNKI A/S
Kirkevænget 5
DK-7400 Herning

Tel. +45 9711 9600
www.acofunki.com
www.egebjerg.com



Danish Design | German Quality | Global Experience

PARTITION FOR LD-BOX

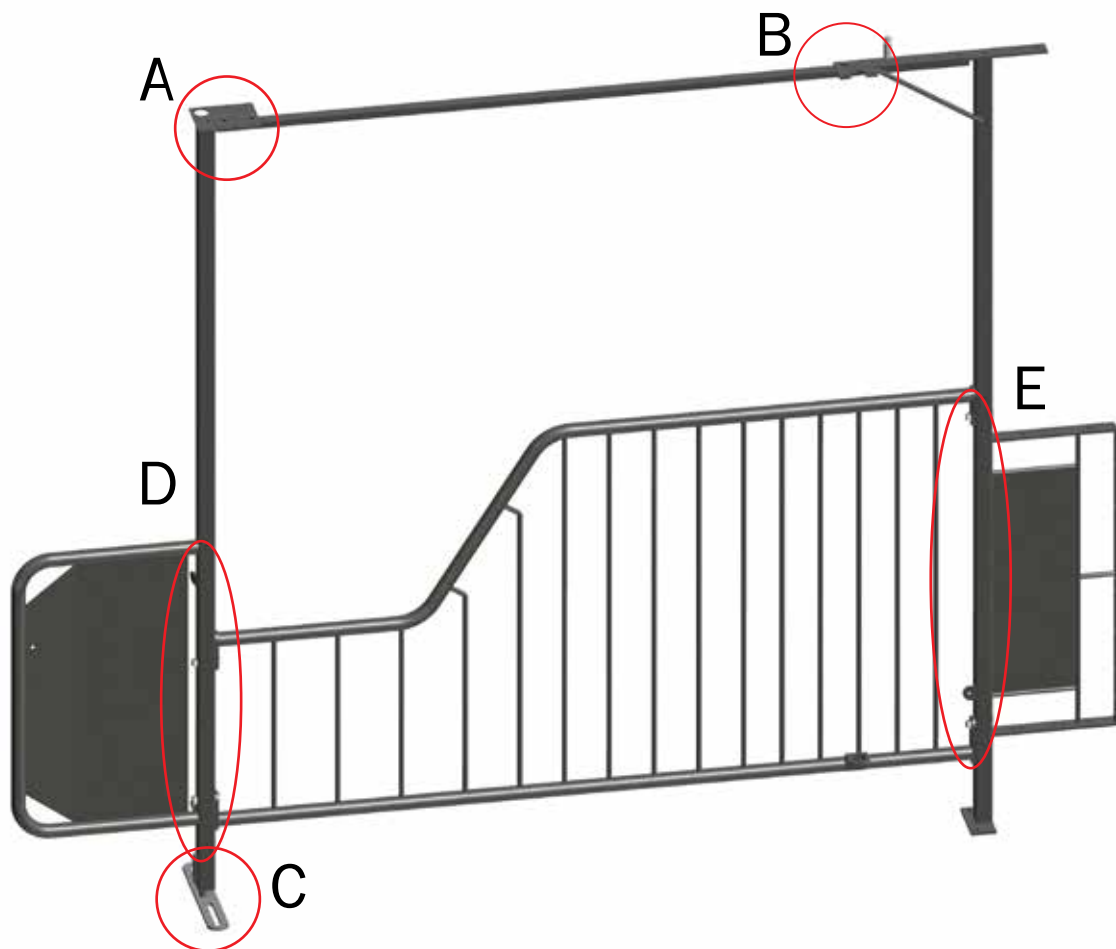

Item	QTY	Part Number	Description
1	1	58369HG	Ai Front Part 40 X 40 W/40Mm Front Grill
2	1	1220852	Foundation Plate For Partition
3	1	58425HG	LD-Box Middle Part With Bars
4	1	58418HG	LD Rear Part 40 X 40 Post
5	1	58438HG	Support Lengthwise Ai Box Galv.
6	4	30310060	Set Screw M10X60 A2 Din 933
7	4	35600038	Face Plate 10 MM ST Din 125
8	4	33510017	Nut M10 A2 Din 934
9	3	30308025	Set Screw M8X25 A2 Din 933
10	3	33908001	Lock Nut M8 A2 Din 985
11	2	38310016	Pointed Screw M10X16 W/Point A2 Din 914

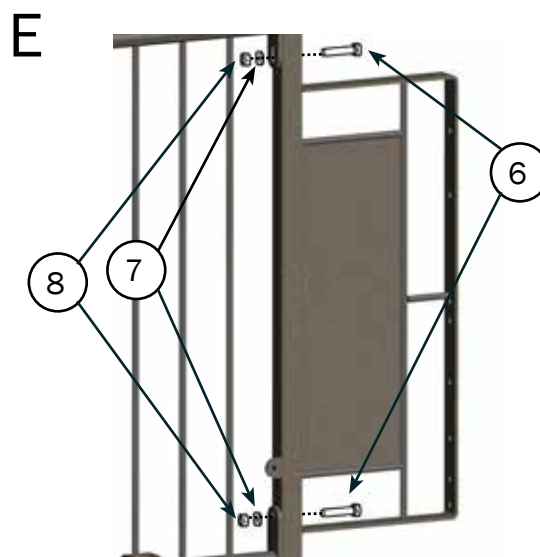
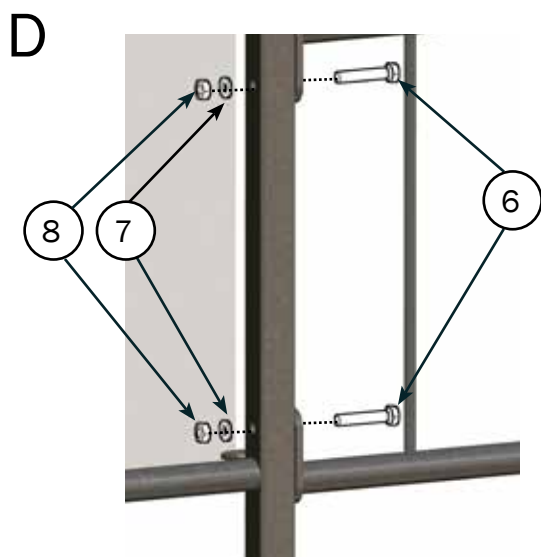
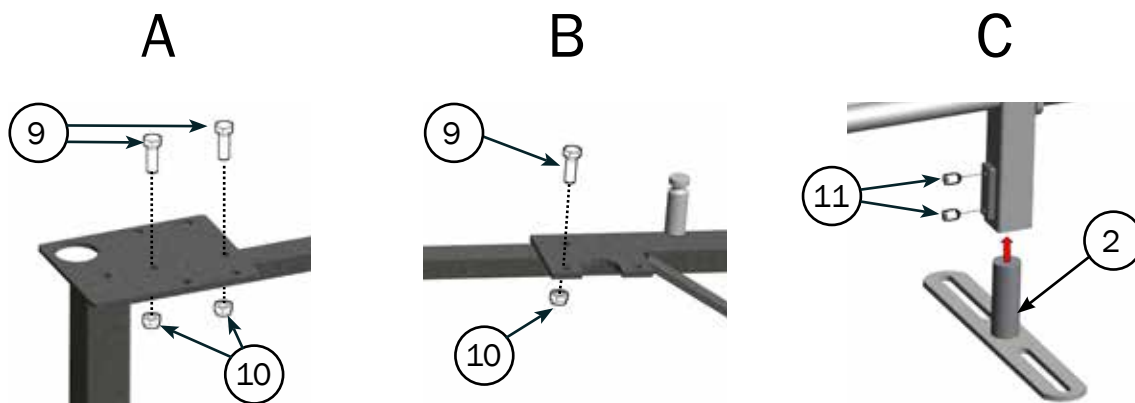
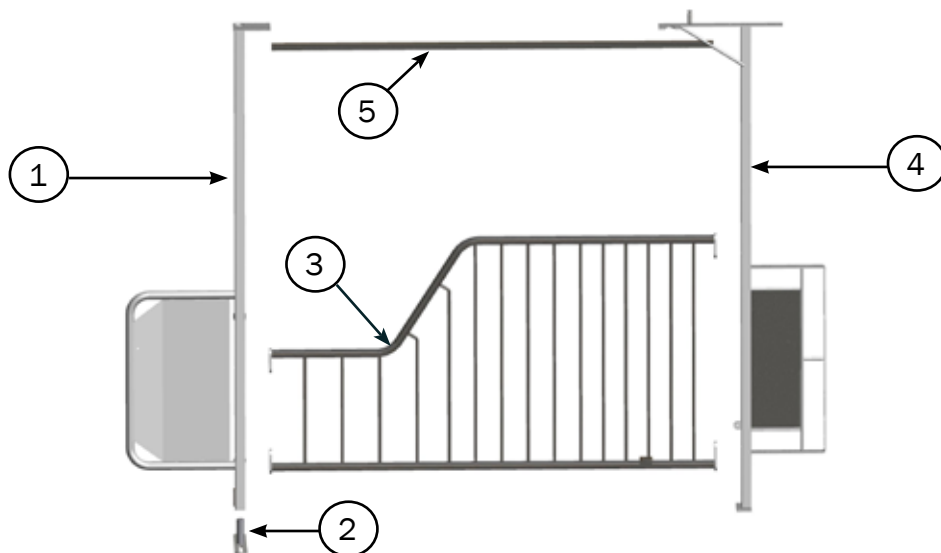

PIPES AND WATER SUPPLY

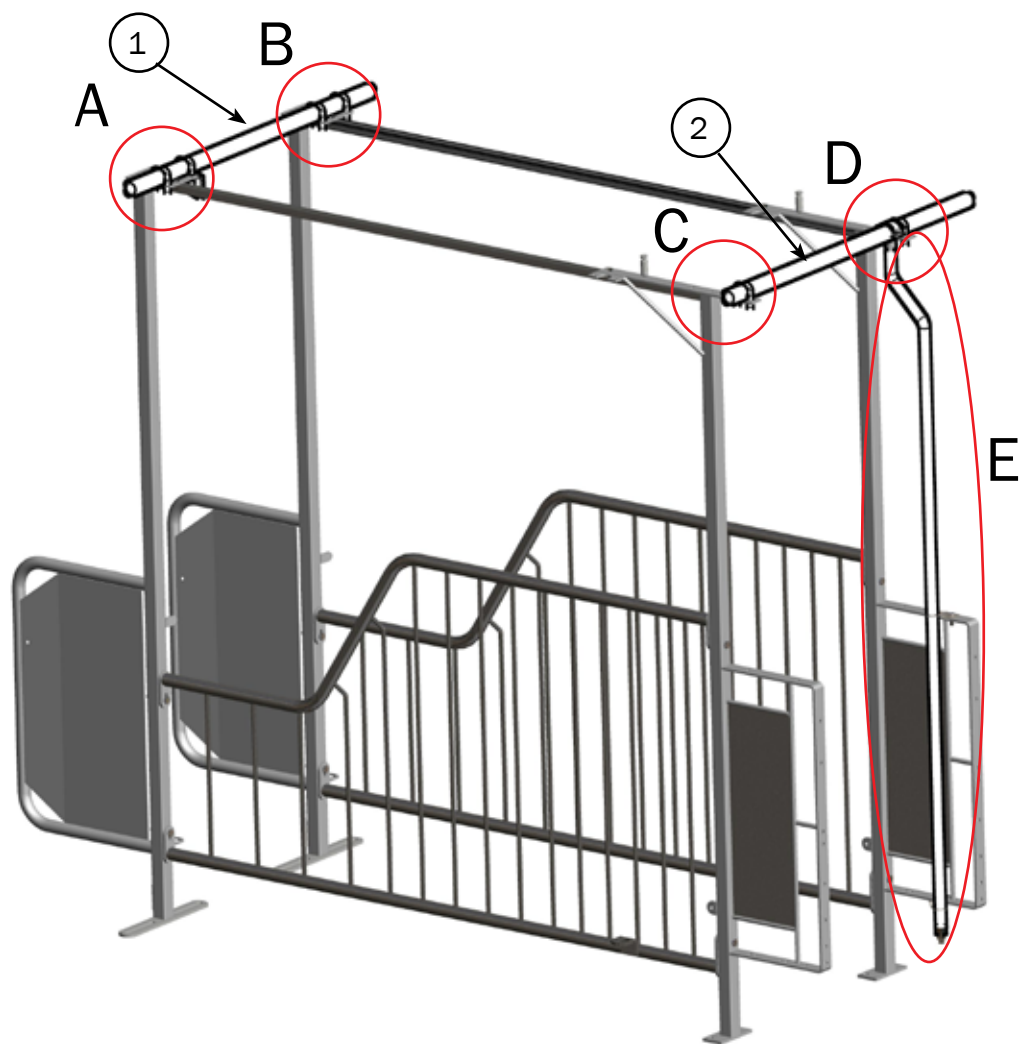

Item	QTY	Part Number	Description
1	6m	94001	1' Pipe Galvanized Without Thred, Incl. Pipe Connector
2	6m	1900250	Pipe 1' Stainless Steel, W/Splicing Sleeve
3	6	90100062	U-Bolt 1' Stainless
4	12	33508013	Nut M8 A2 Din 934
5	1	58416	Stop F/Ai Rear Gate
6	1	12100343	Pipe Clamp Fitting Stainless 1'-1/2' Type 14
7	1	8150097	½ St Pipe For High Pipeline, LD Box With Stainless Steel Trough
8	2	20001	Water Pipe Brac. Univ.F/Free Access 2011
9	2	30310025	Set Screw M10X25 A2 Din 933
10	2	33900029	Lock Nut M10 A2 Din 985
11	1	93305	Press Nipple SS Internal Thread

PIPES

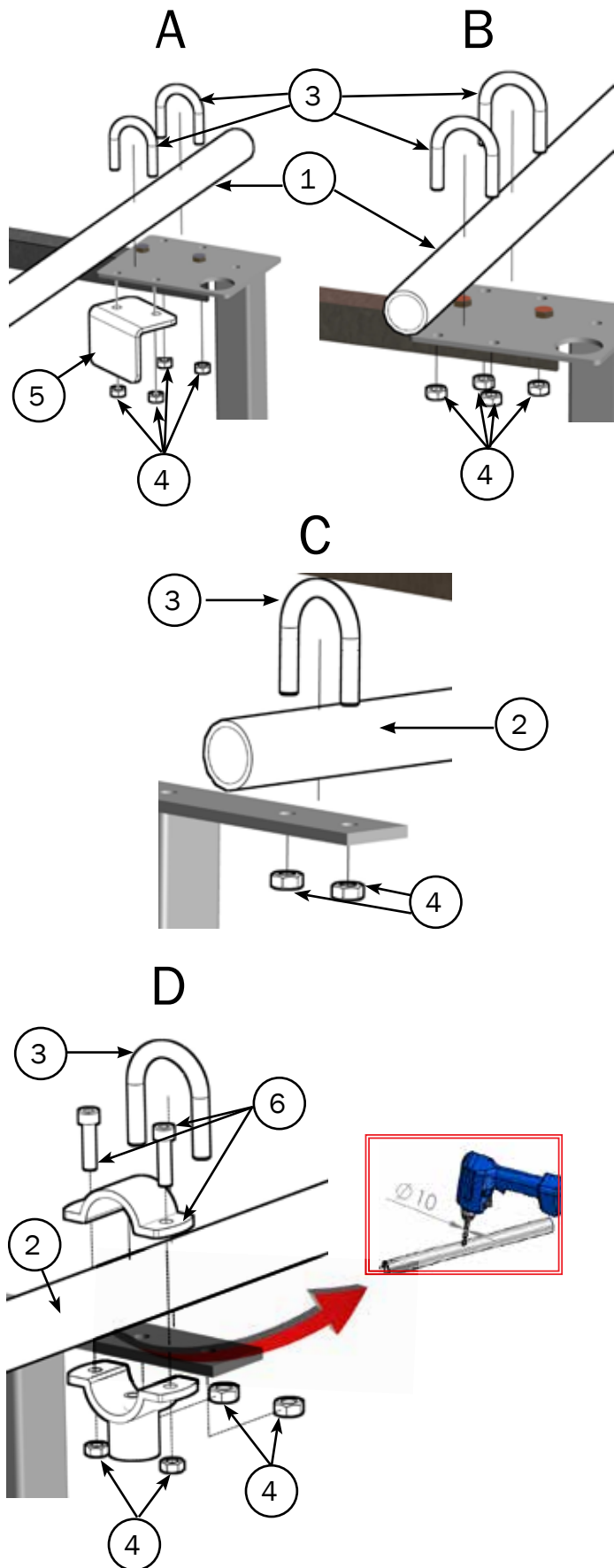

WATER SUPPLY

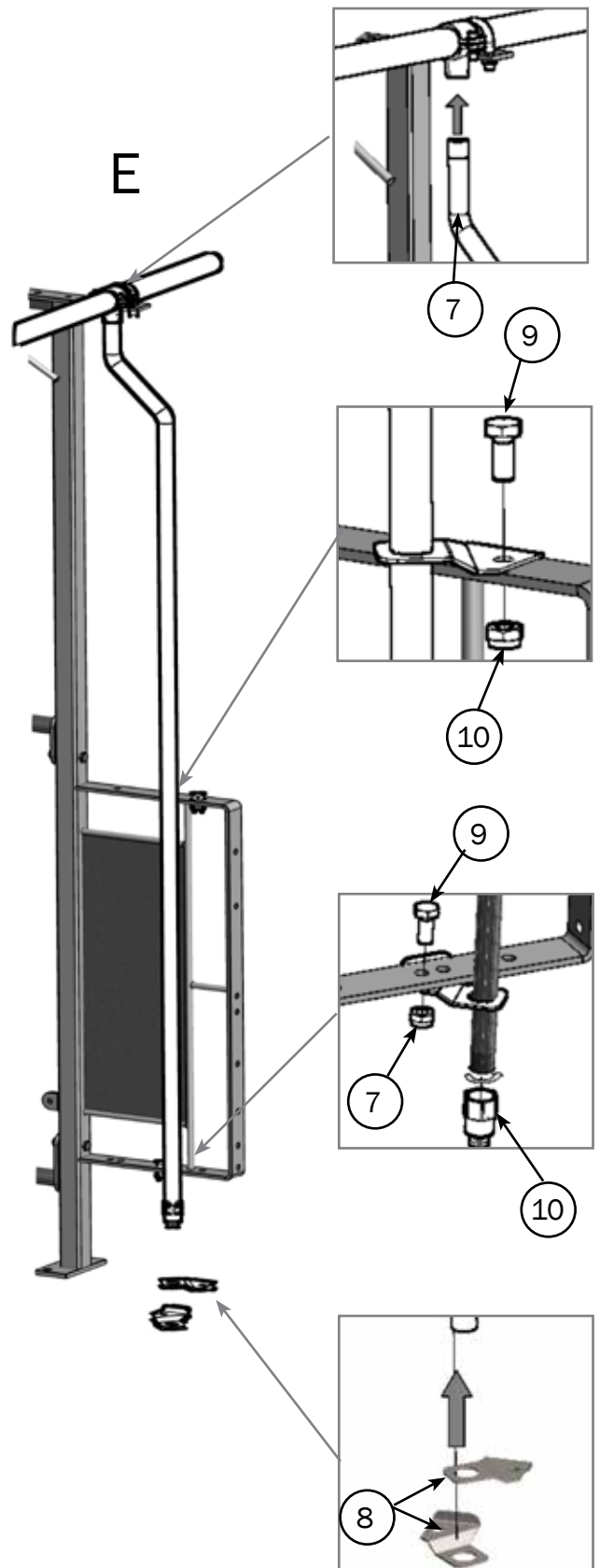

FRONT GATE



Item	QTY	Part Number	Description
6	1	58443	Connecting Rod For AI-Gate, Cpl.
7	2	30310060	Set Screw M10X60 A2 Din 933
8	2	33900029	Lock Nut M10 A2 Din 985
9	2	58158	Rubber Shoe 8 X 16, Oil Resistant
10	4	33908001	Lock Nut M8 A2 Din 985
11	1	58440HG	Front Gate AI Box Galv.
12	1	59601	Guide Sleeve Top Part F Front Gate
13	1	59602	Guide Sleeve Bott Part F Front Gate
14	1	59603	Guide Sleeve Middel For Front Gate
15	2	30308025	Set Screw M8X25 A2 Din 933
16	1	58538	Spring 5.5 X 38 X 200 Mm, Free Access

FRONT GATE

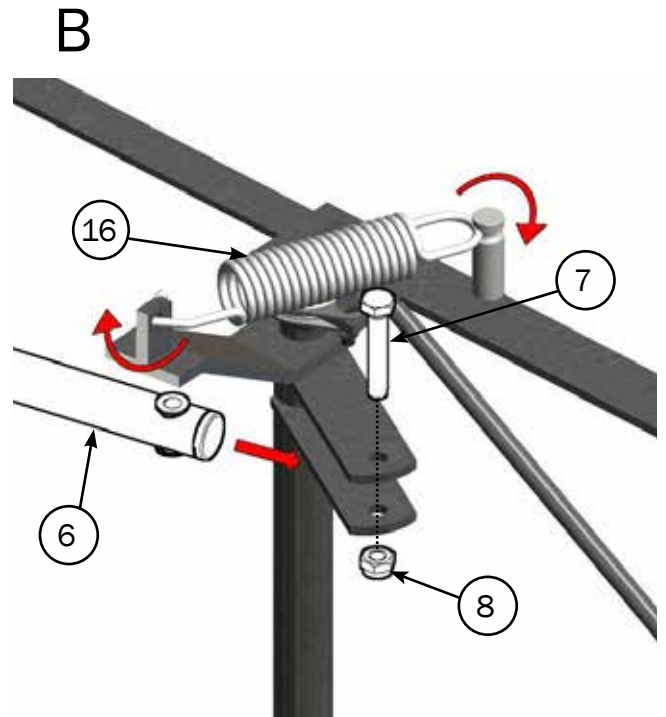
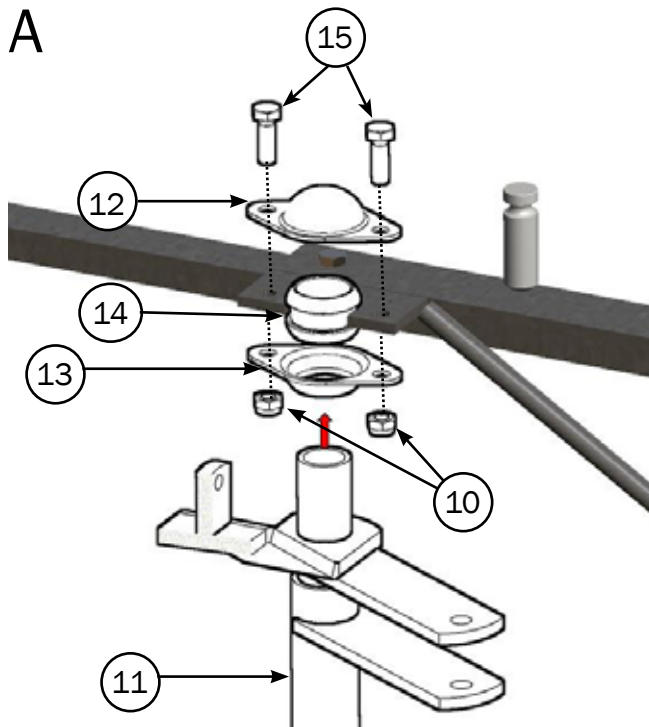

C

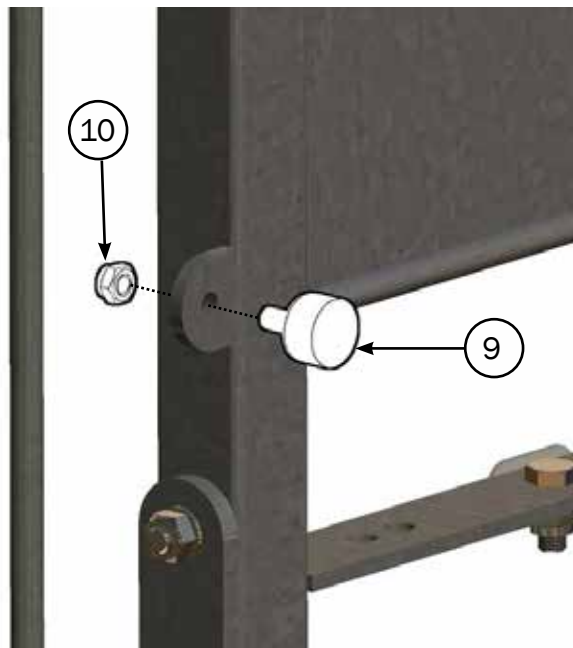

REAR GATE

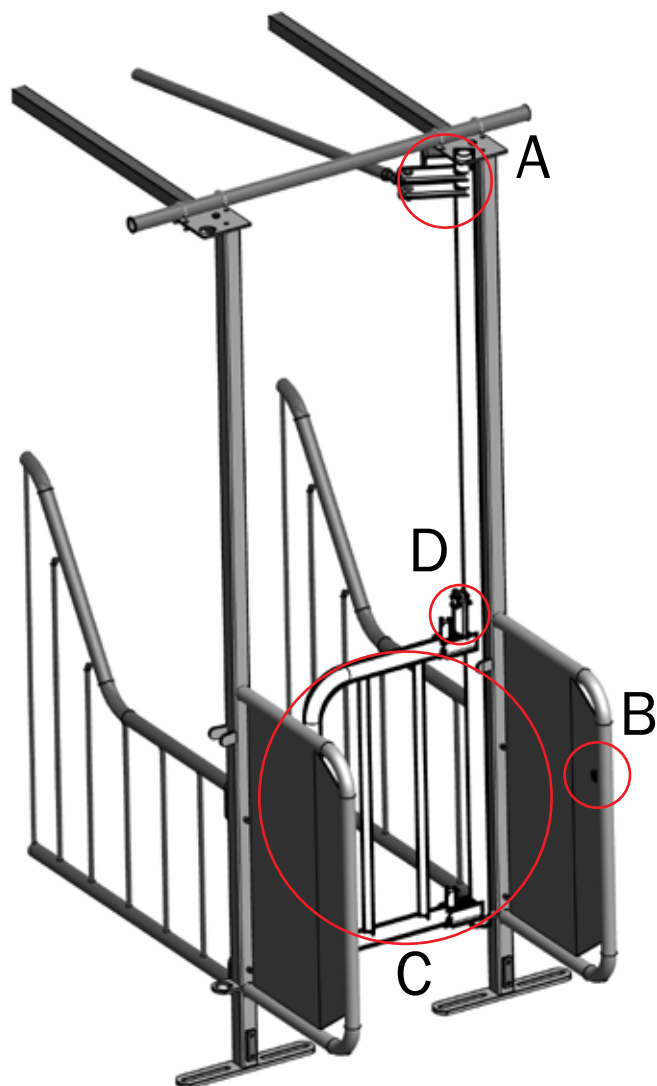

Item	QTY	Part Number	Description
1	1	58433HG	Frame F/Rear Gate Al Box Galv.
2	3	35900095	Split 4X40 A2 DIN 94
3	1	58436HG	Lock Pawl F/Rear Gate Al
4	1	58432HG	Peg For Rear Gate Al Box Galv.
5	1	68910	5 X 50 Pin Galv.
6	1	58443	Connecting Rod For Al-Gate, Cpl.
7	2	30310060	Set Screw M10X60 A2 DIN 933
8	2	33900029	Lock Nut M10 A2 DIN 985
9	2	58158	Rubber Shoe 8 X 16, Oil Resistant
10	4	33908001	Lock Nut M8 A2 DIN 985

REAR GATE

A

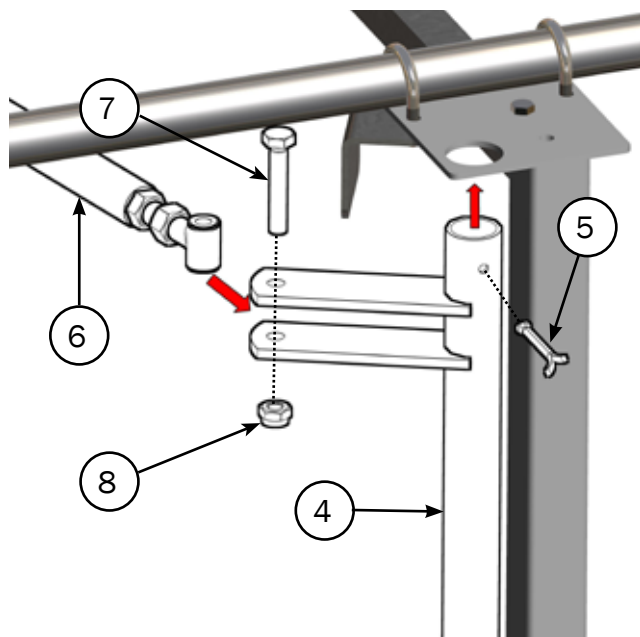

B

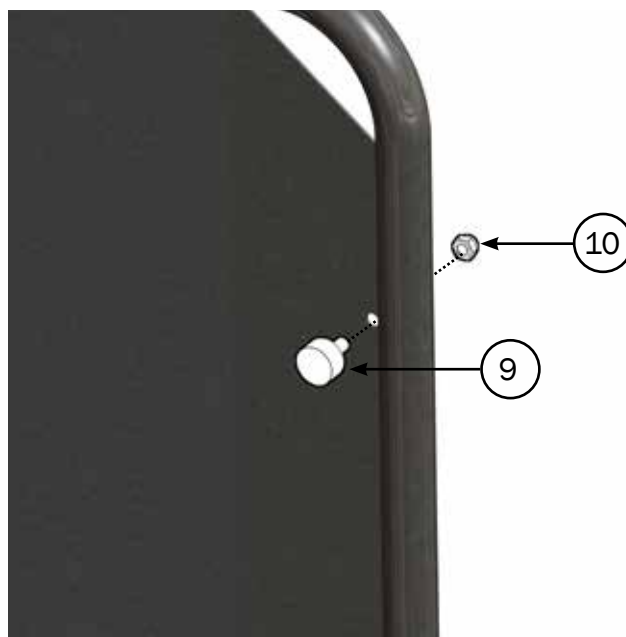

C

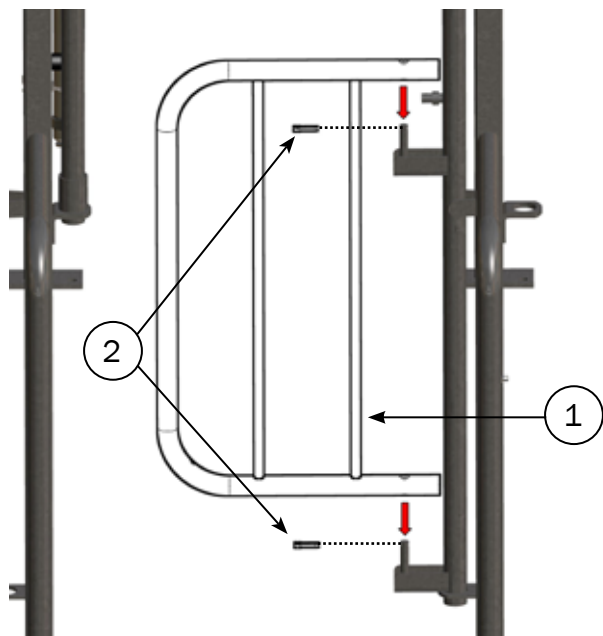

D

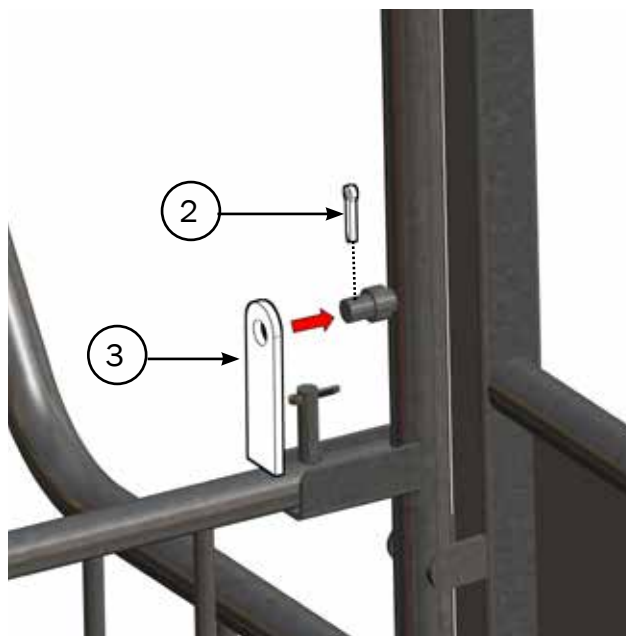

LOCKING SYSTEM AND CENTRAL OPENING AND CLOSING DEVICE

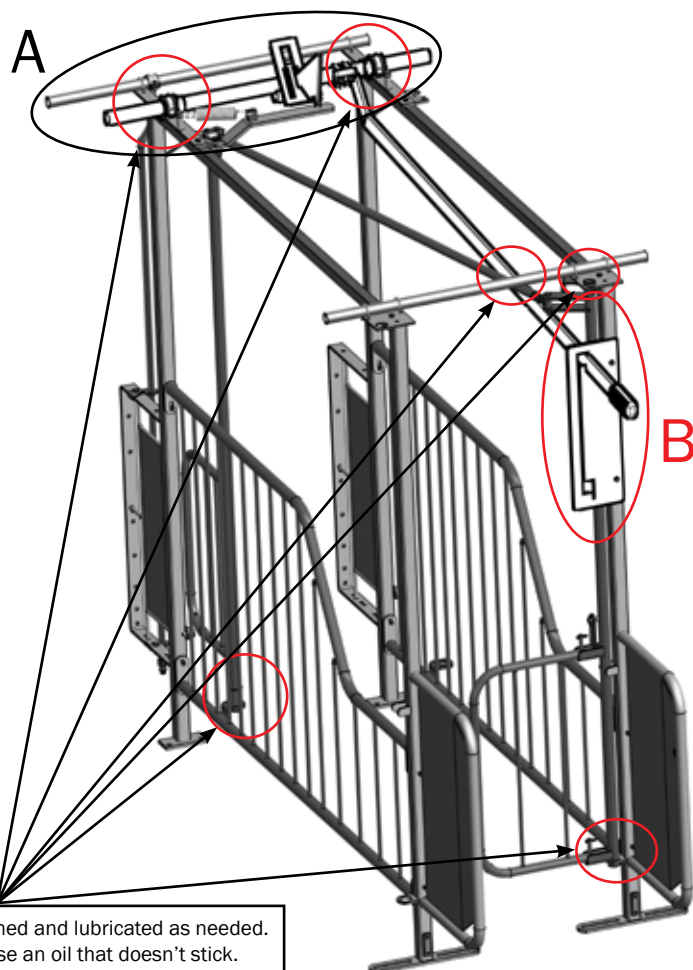

All movable parts is tightened and lubricated as needed.
It's recommended to use an oil that doesn't stick.

Item	QTY	Part Number	Description
1	6m	94001	1' Pipe Galv, Without Thred, Incl. Pipe Connector
2	1	58525	Lock Pawl
3	2	4620015	Locking Ring For 1' Pipe
4	2	38308020	Pointed Screw M8X20 DIN 914
5	2	58510	Plastic Bearing For 40 MM 1 Joint Openi"
6	2	58509	'Bracket F Plastic Bearing 40 MM F 1 Ope"
7	2	30310050	Set Screw M10X50 A2 DIN 933
8	2	33900029	Lock Nut M10 A2 DIN 985
9	1	58523HG	Guide Bracket LD
10	1	58529HG	Friction Pad
11	2	90100062	U-Bolt 1' Stainless
12	4	33908001	Lock Nut M8 A2 DIN 985
13	4	33208014	Nut M8 Fzv DIN 934
14	1	58571	Opening Bar Ai Box 2000 Mm
15	1	58527	Retainer For Opening Bar
16	2	30308060	Set Screw M8X60 A2 Din 933
17	1	59444	Handle For Opening Lever

LOCKING SYSTEM

A

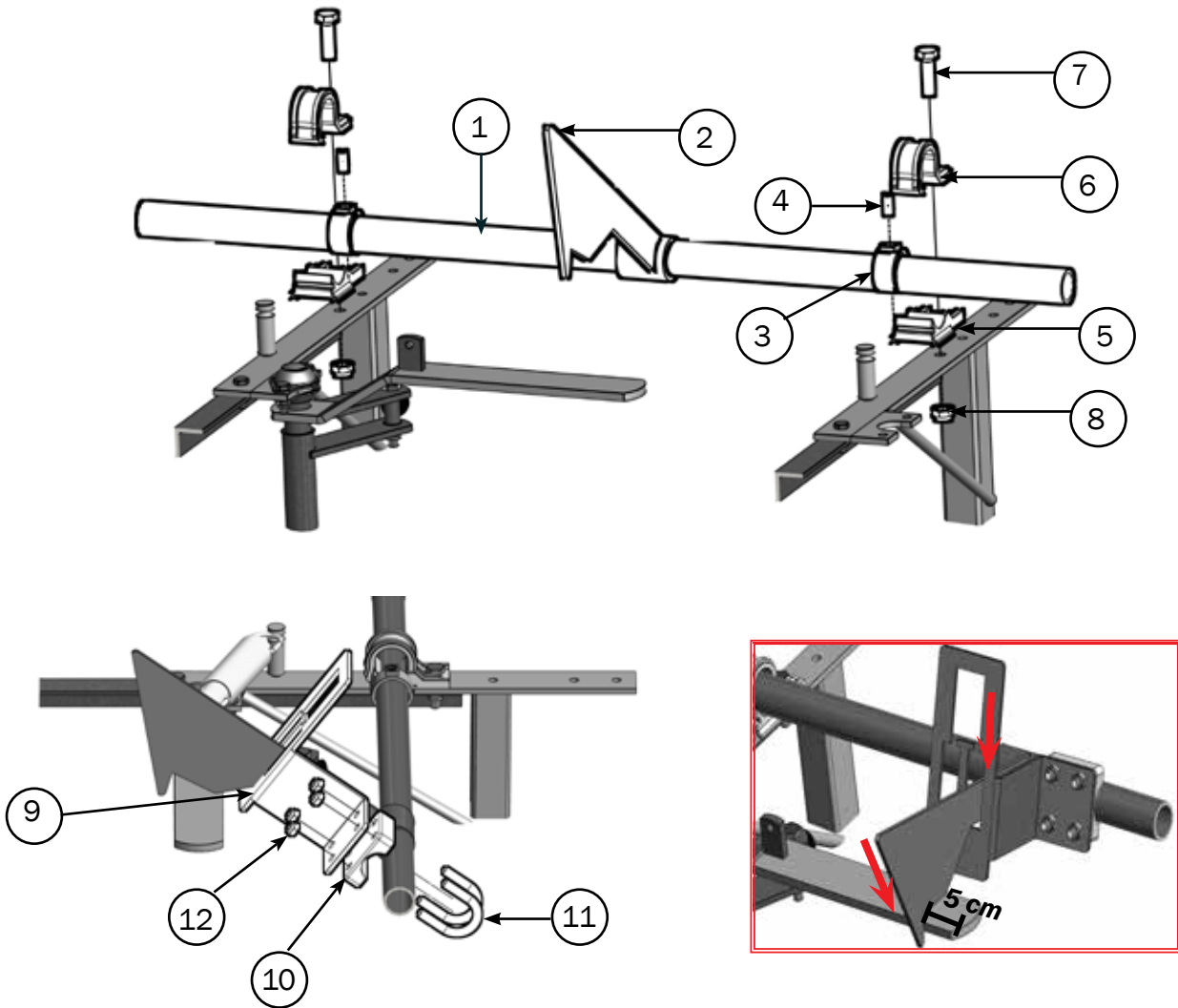

CENTRAL OPENING AND CLOSING DEVISE

B

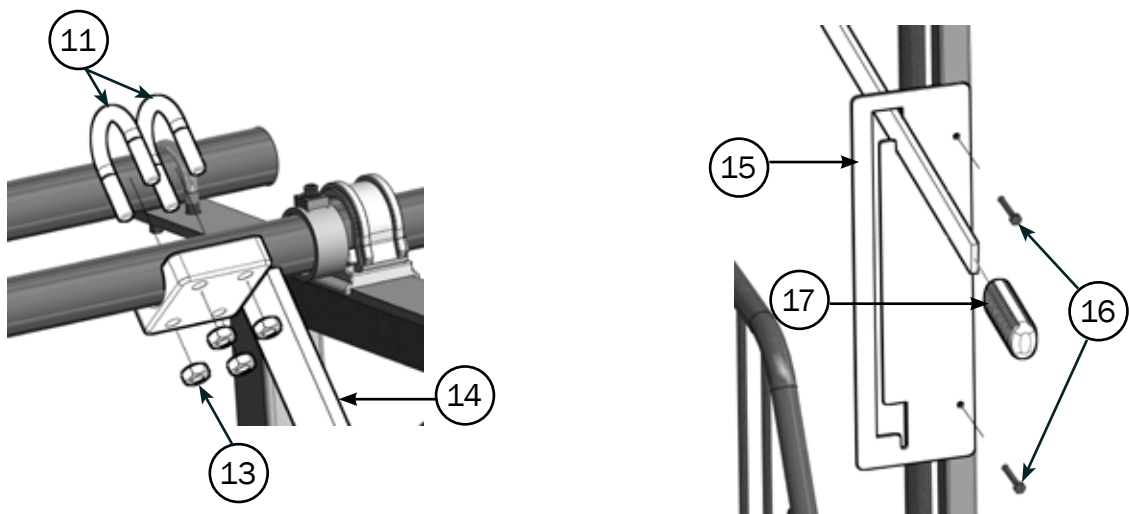

END PARTITION

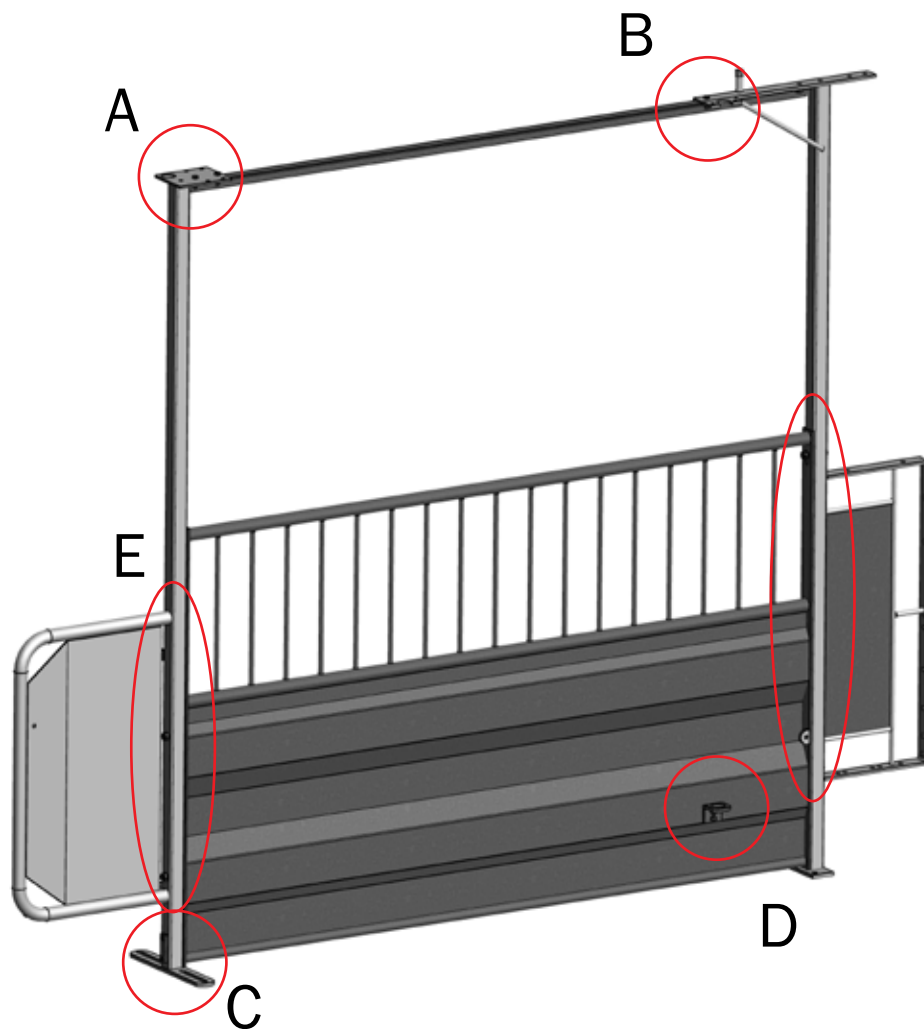

Item	QTY	Part Number	Description
1	1	58369HG	Al Front Part 40 X 40 W/40MM Front Grill
2	1	1220852	Foundation Plate For Partition
3	1	58428HG	LD Middle Part Plate Ending Galv
4	1	58418HG	LD Rear Part 40 X 40 Post
5	1	58438HG	Support Lengthwise Al Box Galv.
6	4	30310060	Set Screw M10X60 A2 DIN 933
7	4	35600038	Face Plate 10 MM ST DIN 125
8	4	33510017	Nut M10 A2 DIN 934
9	3	30308025	Set Screw M8X25 A2 DIN 933
10	3	33908001	Lock Nut M8 A2 DIN 985
11	2	38310016	Pointed Screw M10X16 W/Point A2 DIN 914
12	2	30308030	Set Screw M8X30 A2 DIN 933
13	2	33908001	Lock Nut M8 A2 DIN 985
14	1	1720015	Bracket For Frontdoor LD Box

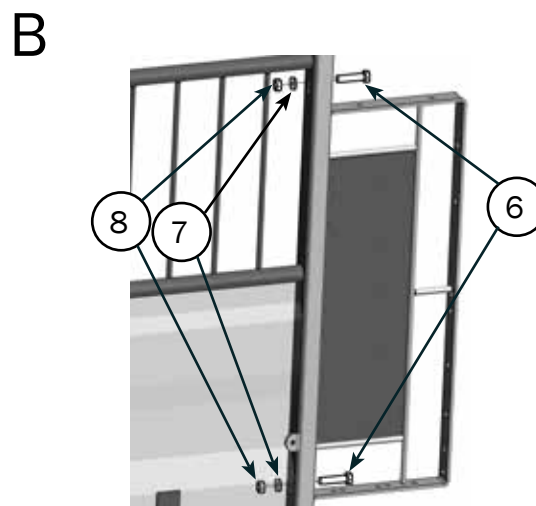
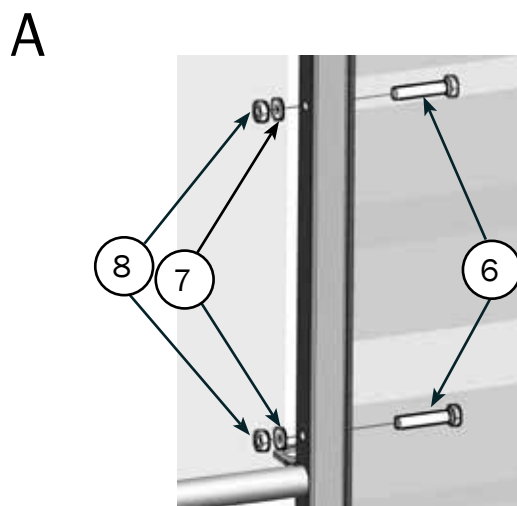
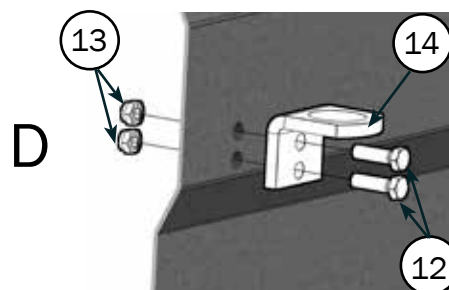
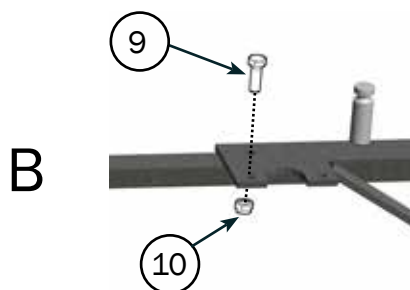
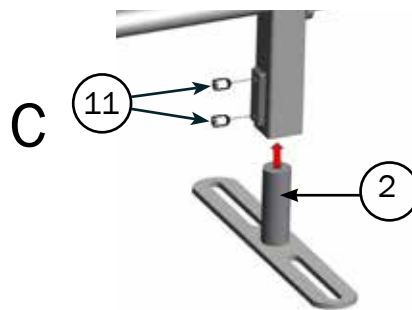
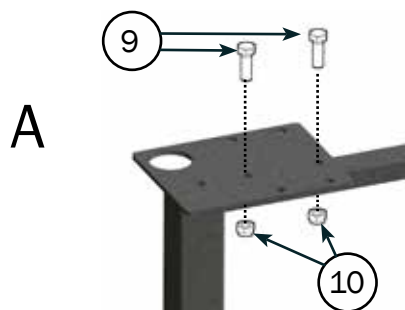
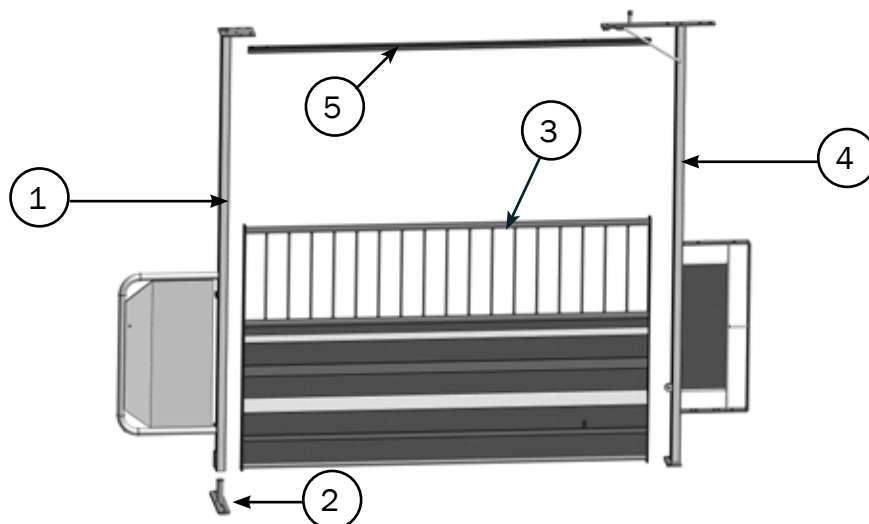

Description for LD Box

Procedure

1. The assembly starts with reviewing delivery note, packing slip and mold drawing.
2. The pen is measured.
3. Partitions are mounted.
4. Partitions are placed in shed.
5. Partitions are mounted into floor.
6. Gates are mounted.

Running and maintenance

- Pens for ... , delivered by ACO Funki, has a dimension for with a weight interval of 170-300 kg.
- Reservation is taken for inappropriate behavior from the staff, such as heavy beating, use of wrong tools, etc.
- Reservation is taken for inappropriate behavior from pigs, caused by external stress, etc
- The warranties do not cover ordinary wear and accidental damages.
- PVC Board profiles and other PVC parts must not be cleaned by high-pressure cleaning for longer periods with a constant beam, and/or with increased pressure from a short distance. The recommended pressure is max. 180 bar.
- Heating lamp, gear, motor, motor protection, controllers, signals, hand witch, relies system etc. must not be cleaned by high pressure cleaner.
- Cover for piglets must not be cleaned on the side with high pressure cleaner.
- Reservation is taken for inappropriate use of chemicals in connection with cleaning that could discolor or harm in form of etching.
- All water systems have to be cleaned frequently and decalcified.
- In connection with cleaning, the stable must dry out, in order for the components not to be exposed to constant moisture.
- All mounted and movable parts must be cleaned ongoing, retighten and lubricated. However if the parts gets lose within the first month after start up, ACO Funki has to be contacted immediately. We recommend lubricating with grease and oil on all movable iron parts, like hinges, locks, gates, brackets, corner wheels, drive units etc.
- All wearing part is not reclaimable, because these parts are considered as consumables.
- Smaller spots of corrosion on stainless steel parts must be expected. Warranties are only valid for rust perforation.
- ACO Funki products can be damaged by outdoors storage. We recommend maximum 1 month outdoors storage. However one can expect changes in the surface such as discoloring, rust spots etc. already within the first month.
- ACO Funkis complaint-handling is according to current legislation.