

M-6214_GB

MOUNTING INSTRUCTION

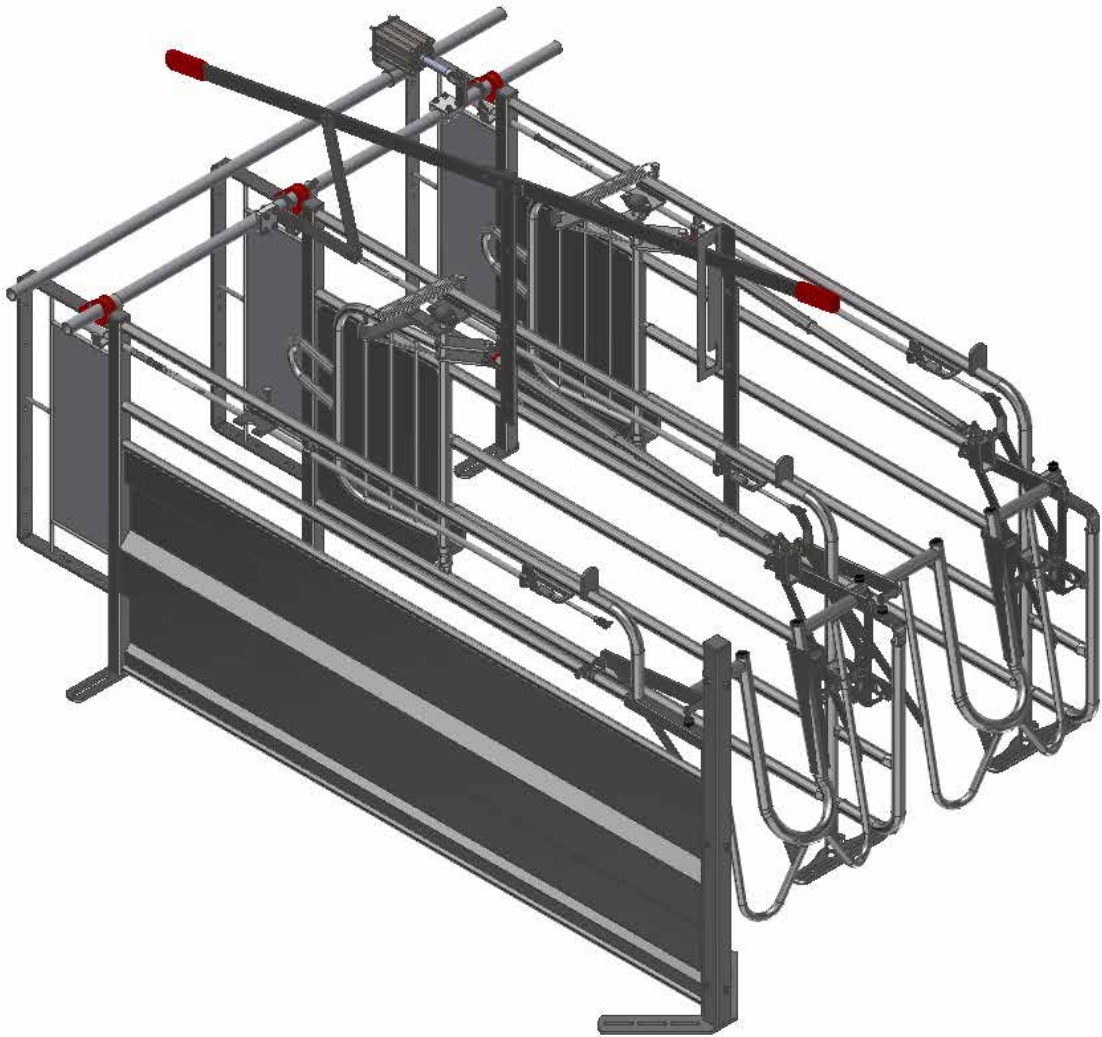

FREE ACCESS BOX



ACO FUNKI A/S
Kirkevænget 5
DK-7400 Herning

Tel. +45 9711 9600
Fax +45 9711 9677
www.acofunki.com

DANISH DESIGN | GERMAN QUALITY | GLOBAL EXPERIENCE

PARTITION FOR FREE ACCESS BOX 234 CM

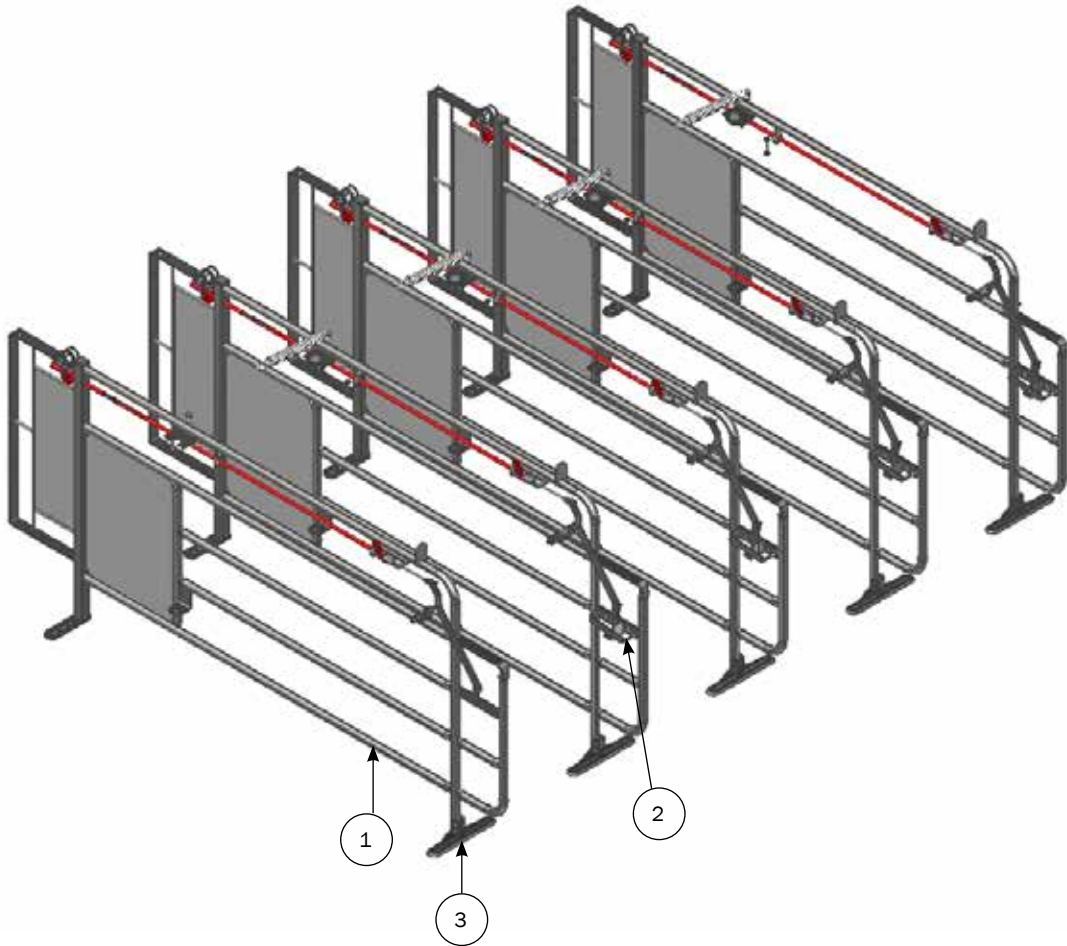

PARTS LIST			
No.	PCS.	ITEM No.	DESCRIPTION
		G62051	PARTITION FREE ACCESS 234 CM
1	1	59047	PARTITION FREE ACCESS STALL 200 CM '11 M
2	1	59511	ACCESSORIES FREE ACCESS 2011
3	1	1220420	ADJUSTABLE SUPPORT Ø25 CONFINE BOX

SPARE PARTS FOR PARTITION FOR FREE ACCESS STALL 200 CM '11 MONT.

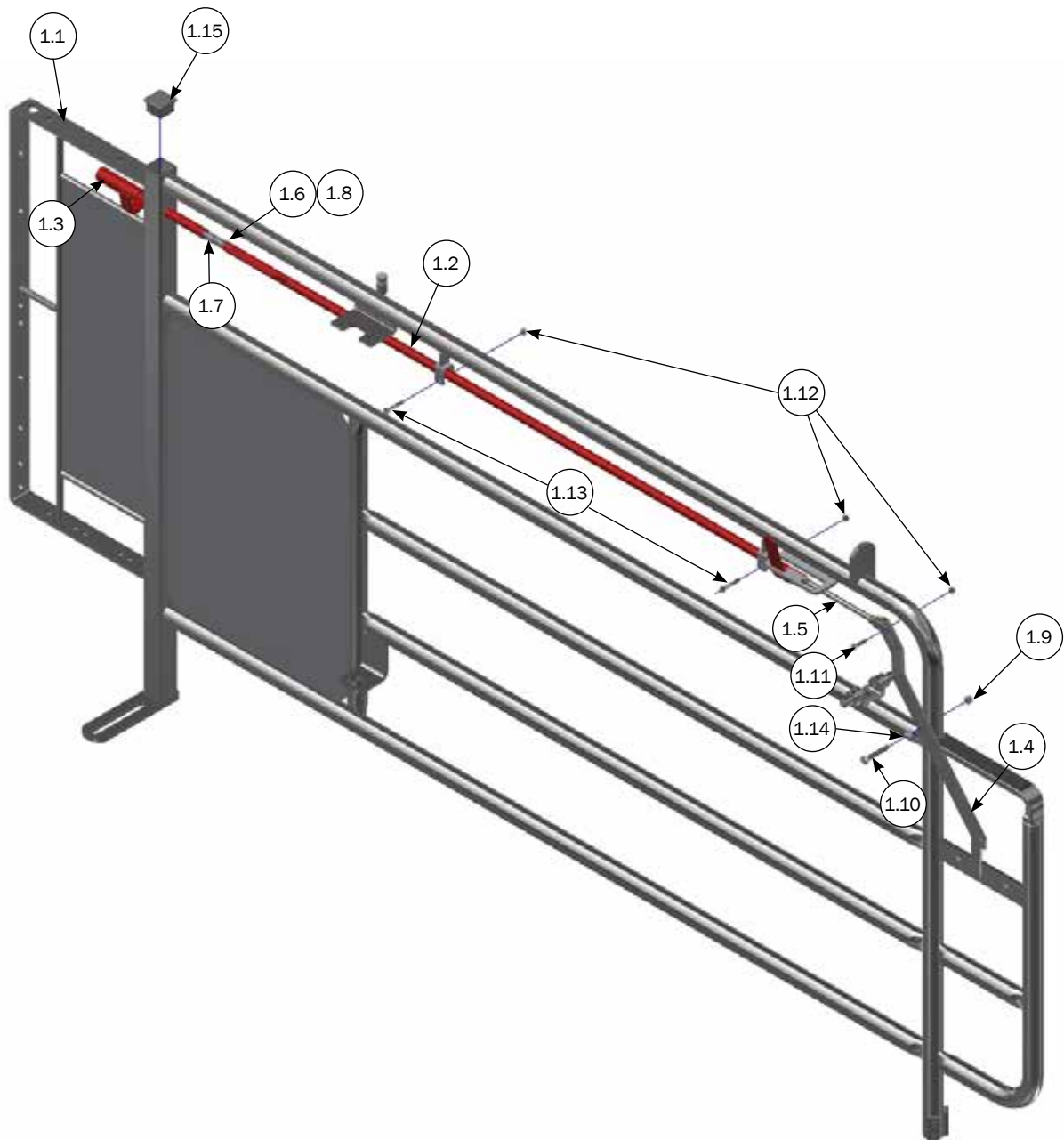

No.	PCS.	ITEM No.	DESCRIPTION
1	1	59047	PARTITION FREE ACCESS STALL 200 CM '11 M
1.1	1	not available	FREE ACCESS BOX 200CM 2011
1.2	1	not available	EXTENSION ARM FIXATION LOCK FREE ACCESS BOX 2011
1.3	1	not available	CONNECTION ARM FREE ACCESS BOX
1.4	1	not available	UPPER LOCKING ARM REAR GATE FREE ACCESS BOX 2011
1.5	1	not available	PIPE WITH FORK. LOCK FREE ACCESS BOX
1.6	1	not available	SPRING 1.5X15X100 MM SS
1.7	2	58535	SPRING 1.5 X 15 X 45.5 MM
1.8	2	not available	3.2X20 MM COTTAR DIN 94-A2
1.9	1	33908001	LOCK NUT M8 A2 DIN 985
1.10	1	30308050	SET SCREW M8X50 A2 DIN 933
1.11	1	30306025	SET SCREW M6X25 FZB DIN 933
1.12	3	33596010	LOCK NUT M6 A2 DIN 985
1.13	2	67220	M6 X 35 HEX SCREW SS DIN 931
1.14	1	59523	BUSHING LOCK ENDPARTITION FREE ACCESS BOX
1.15	1	9960003	CAP 40 X 40 X 1.5 - 4.0

ACCESSORIES FOR FREE ACCESS 2011

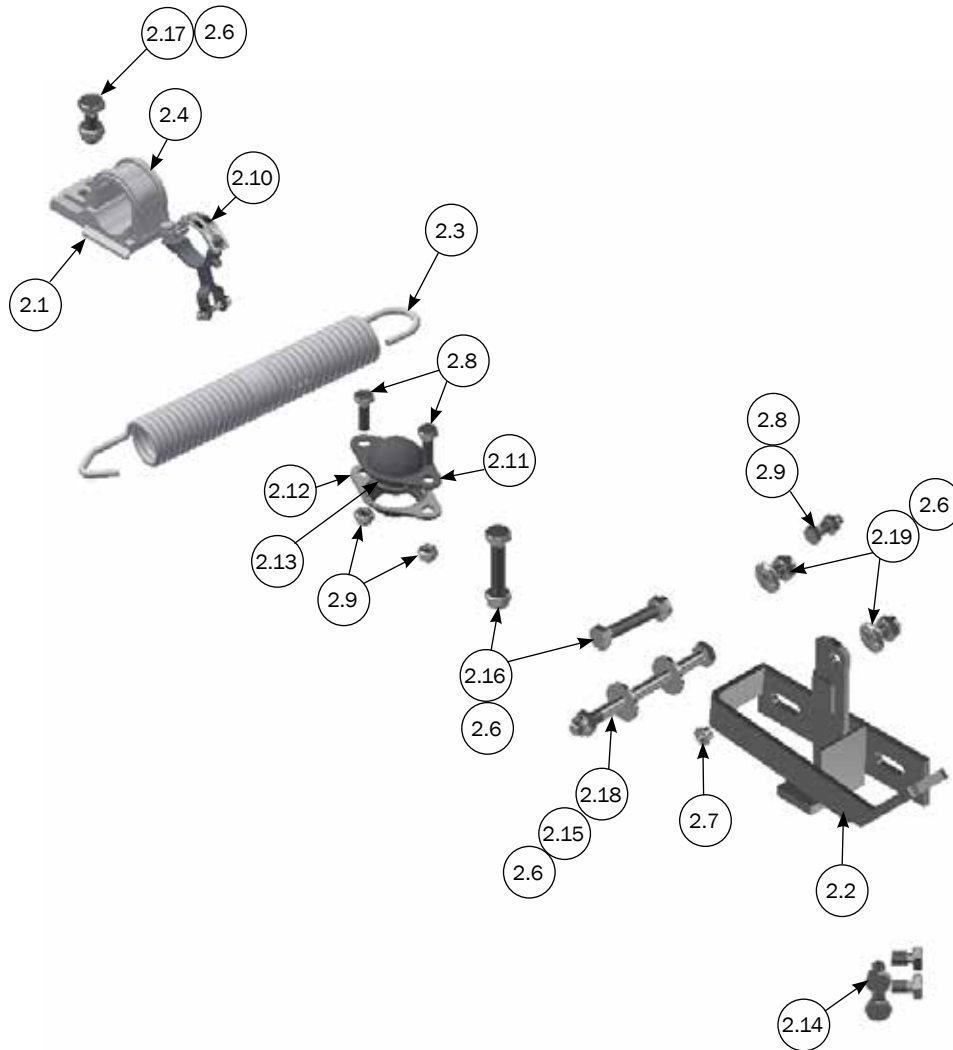

No.	PCS.	ITEM No.	DESCRIPTION
2	1	59511	ACCESSORIES FREE ACCESS 2011
2.1	1	58510	PLASTIC BEARING FOR 40 MM 1 JOINT OPEN
2.2	1	58129	LOCKING MECHANISM BRACKET FREE ACCESS BOX
2.3	1	58538	SPRING 5.5 X 38 X 200 MM, FREE ACCESS
2.4	1	58509	BRACKET F PLASTIC BEARING 40MM F 1 OPEN
2.5	1	58127	LOWER LOCKING ARM FOR REAR GATE 2011
2.6	6	33900029	LOCK NUT M10 A2 DIN 985
2.7	1	59523	BUSHING LOCK ENDPARTITION FREE ACCESS BOX
2.8	3	30308025	SET SCREW M8X25 A2 DIN 933
2.9	3	33908001	LOCK NUT M8 A2 DIN 985
2.10	1	58660	DRIVER CLAMP
2.11	1	59601	LOCK NUT M6 A2 DIN 985
2.12	1	59602	GUIDE SLEEVE BOTT PART F FRONT GATE
2.13	1	59603	GUIDE SLEEVE MIDDEL FOR FRONT GATE
2.14	4	30310016	SET SCREW M10X16 A2 DIN 933
2.15	2	35900085	NUT WASHER Ø10X10,5/30/2,5 A2DIN 9021
2.16	2	30310060	SET SCREW M10X60 A2 DIN 933
2.17	1	30310030	SET SCREW M10X30 A2 DIN 933
2.18	1	67486	10 X 130 HEX HOLT SS
2.19	2	36310025	MUSHROOMHEADED BOLT M10X25 A2DIN 603
3	1	1220420	ADJUSTABLE SUPPORT Ø25 CONFINE BOX

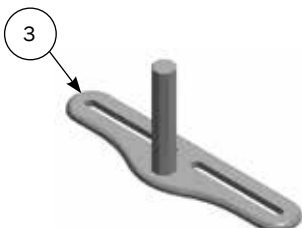

MOUNTING OF PARTITION

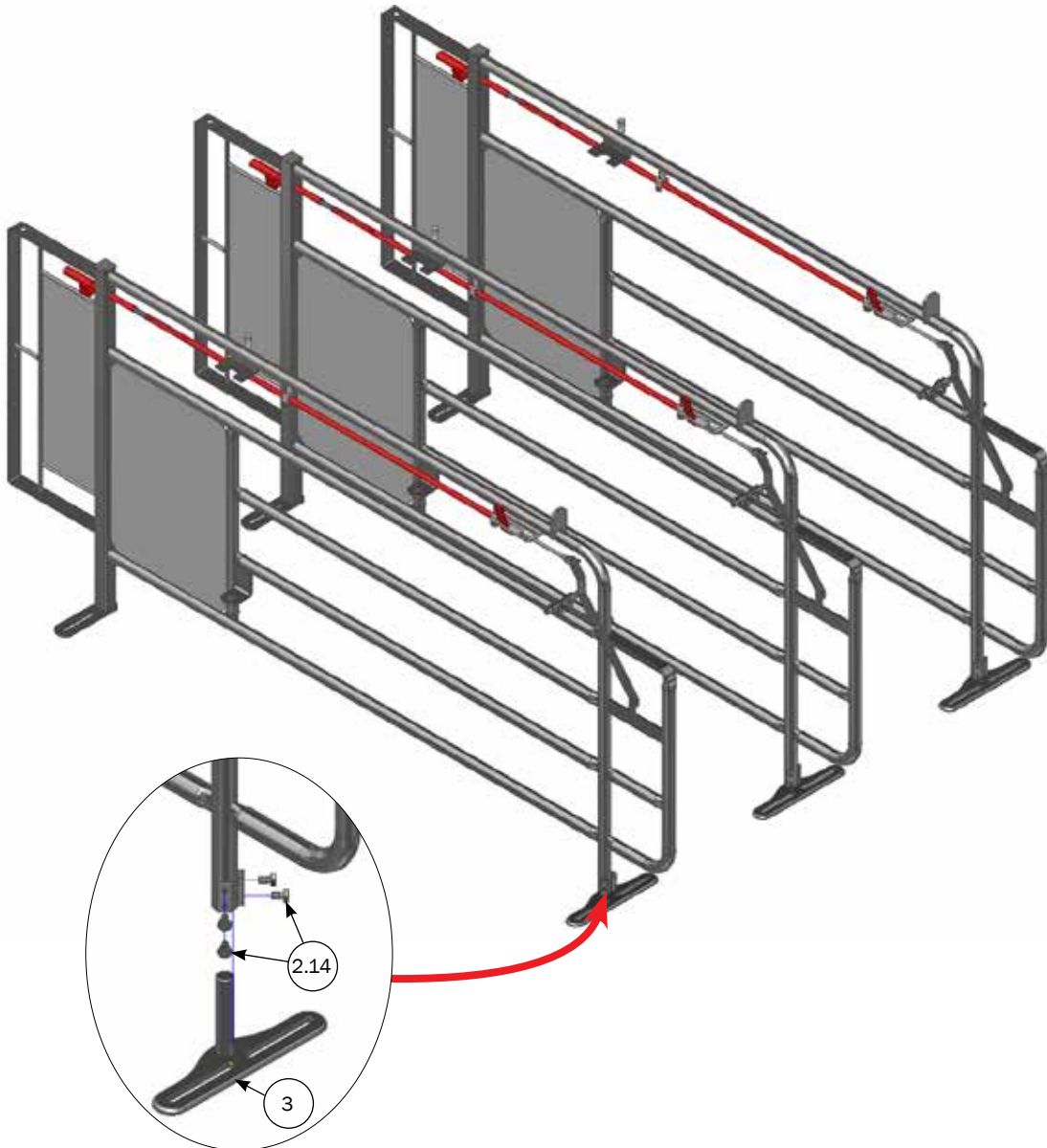
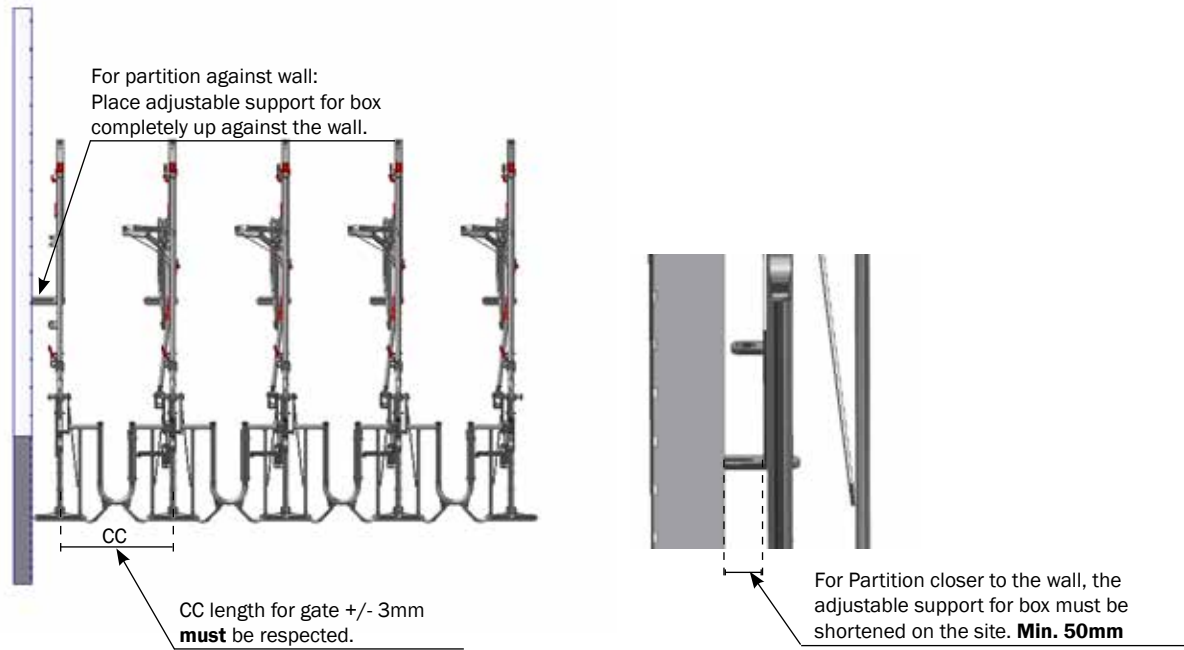

MOUNTING IN FULL SLATS FLOOR

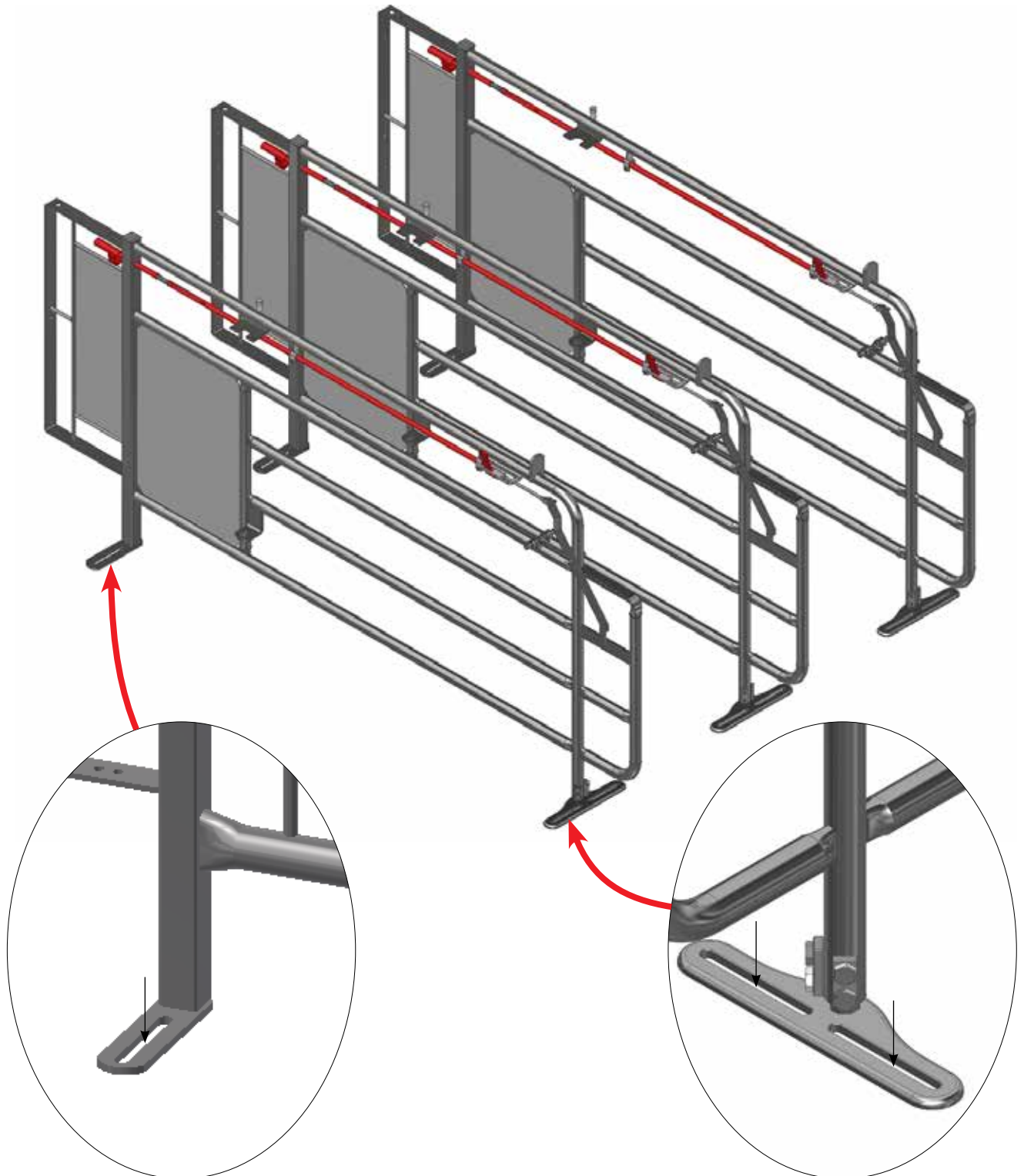

Must be bought separately.
For mounting in full slats floor use:
1 Pcs "4800020"

Must be bought separately.
For mounting in full slats floor use:
1 Pcs "4800020"

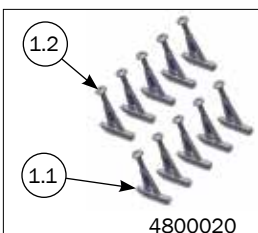

PARTS LIST			
NO.	PCS.	ITEM NO.	DESCRIPTION
1	1	4800020	10 PCS. T-BOLT FOR CONCRETE SLATS STAINLESS STEEL
1.1	(10) 3	90100078	T-BOLT CAST M10 STAINLESS STEEL
1.2	(10) 3	30310080	BUTTON HEAD TORX 50 M10X80 STAINLESS STEEL

M-6214_GB

MOUNTING IN PARTIAL SLATS FLOOR

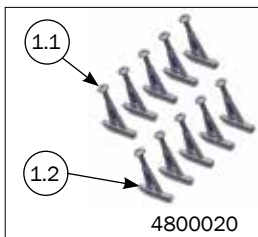
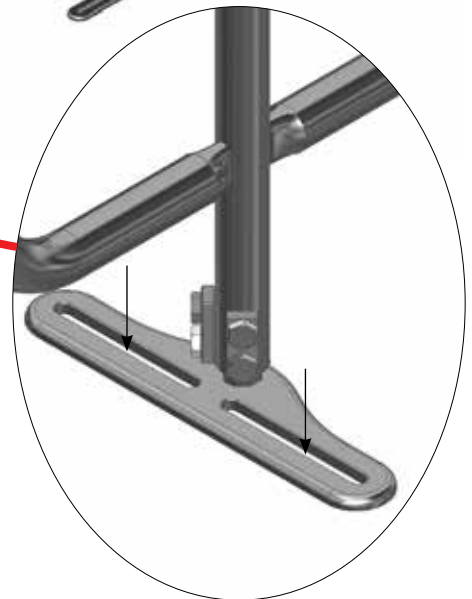
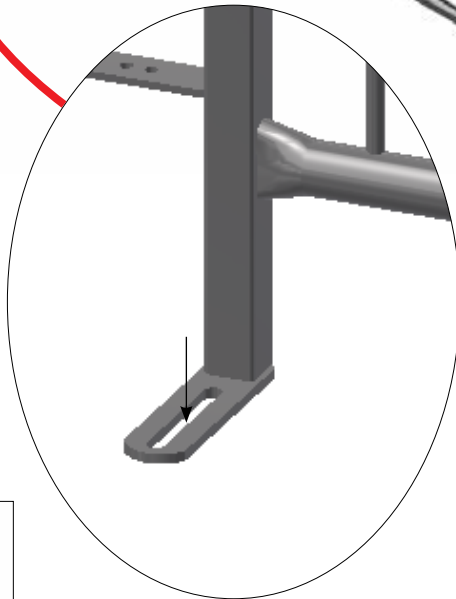
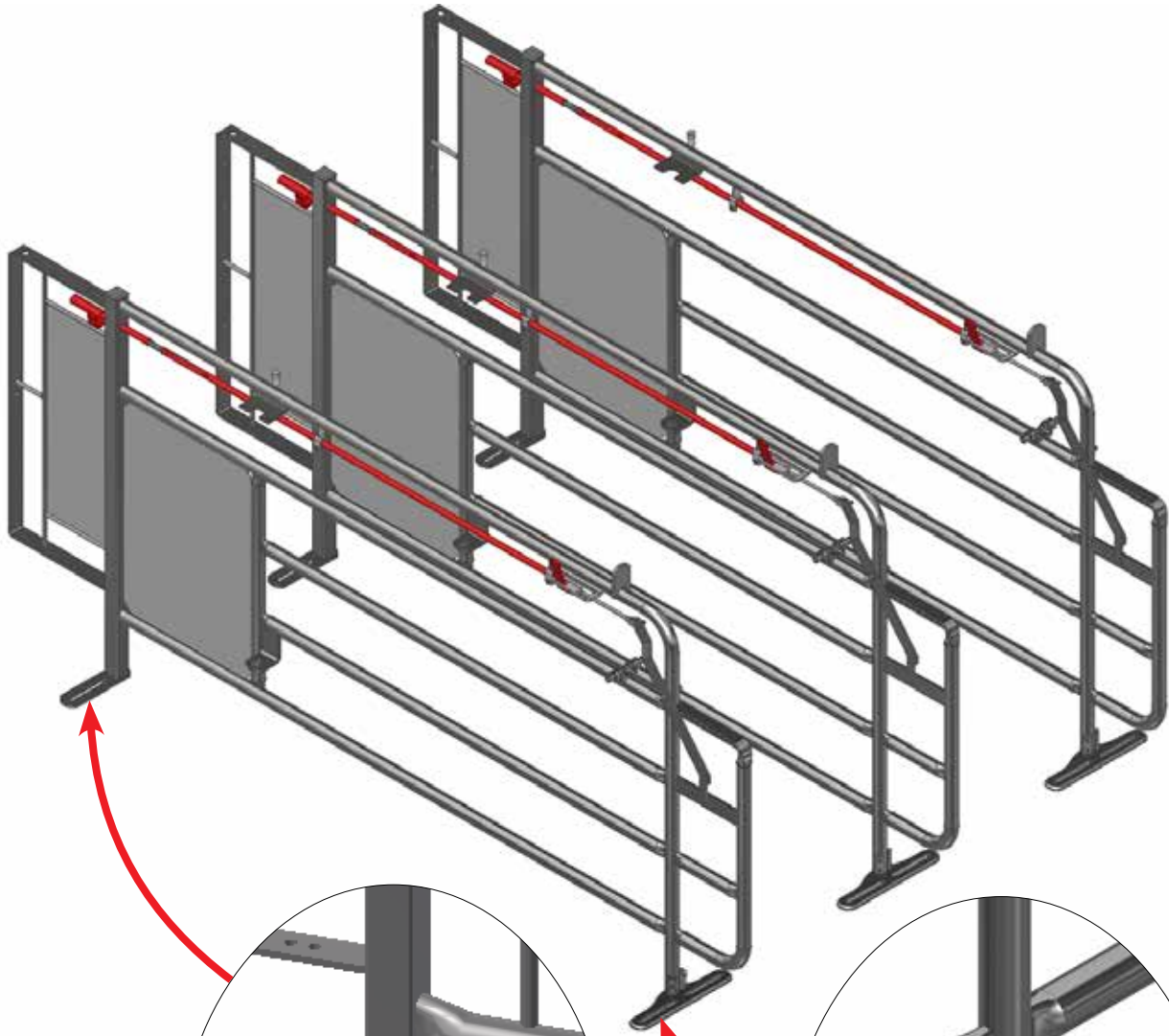

Must be bought separately.
For mounting in partial slats floor use:
1 Pcs "4800010"

Must be bought separately.
For mounting in partial slats floor use:
1 Pcs "4800020"

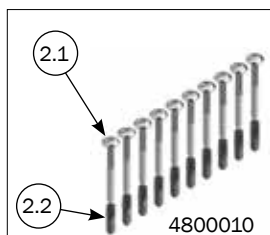

PARTS LIST			
NO.	PCS.	ITEM NO.	DESCRIPTION
1	1	4800020	10 PCS. T-BOLT FOR CONCRETE SLATS STAINLESS STEEL
1.1	(10) 2	90100078	T-BOLT CAST M10 STAINLESS STEEL
1.2	(10) 2	30310080	BUTTON HEAD TORX 50 M10X80 STAINLESS STEEL
2	1	4800010	10 PCS. SS BUTTON HEAD SCREWS 10X70 + WALL PLUG
2.1	(10) 1	67444	10 X 70 BUTTON HEAD TORX 50 STAINLESS STEEL
2.2	(10) 1	39900001	WALL PLUG 12X60 MM

MOUNTING OF LOCK BRACKET ON SIDE

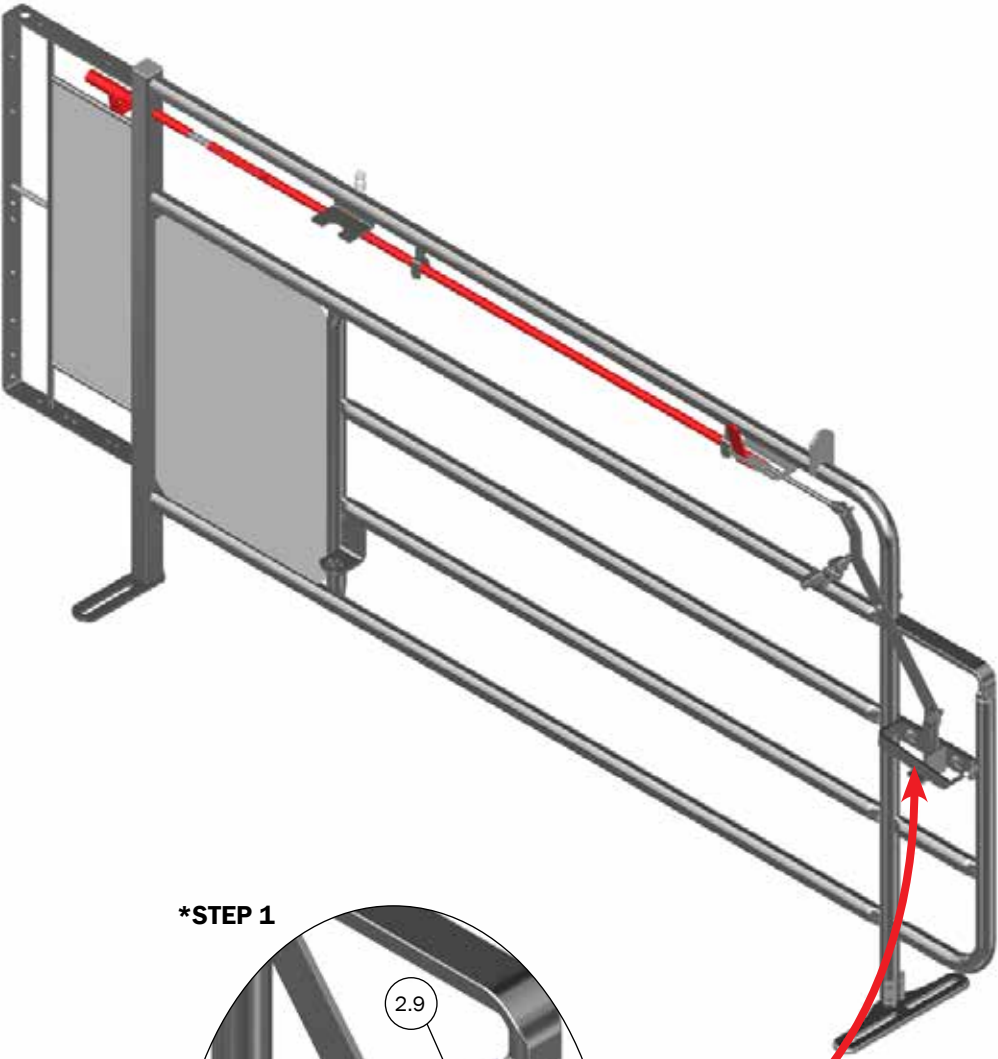

***STEP 1**

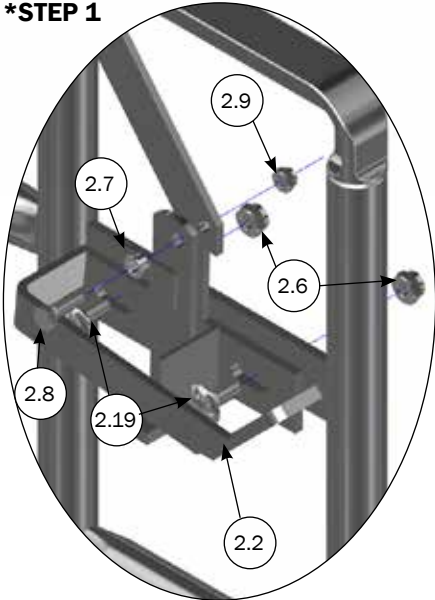

For parts list look at page 4
M-6214_GB

END PARTITION 200CM FREE ACCESS FOR LOOSE POST

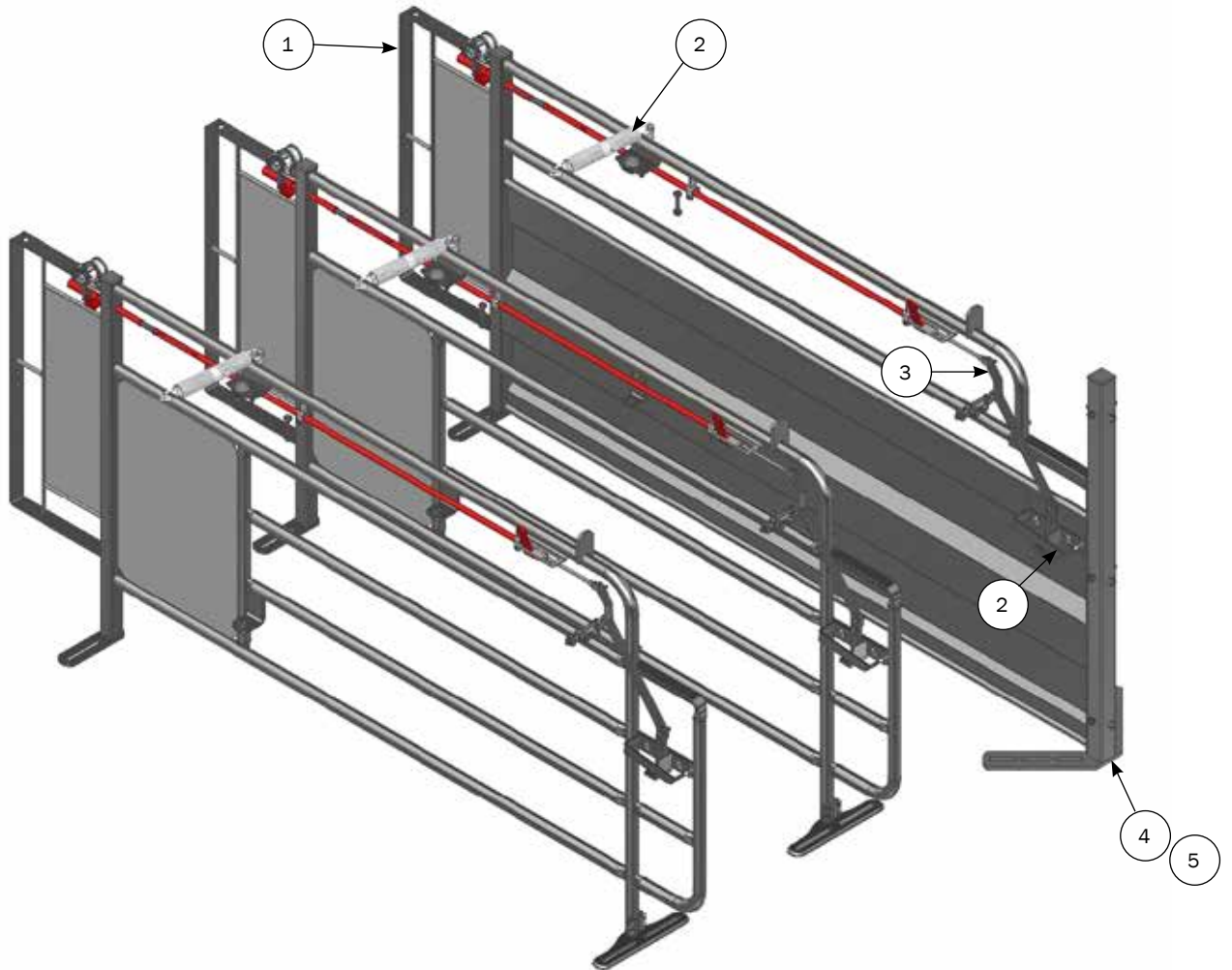

PARTS LIST			
NO.	PCS.	ITEM NO.	DESCRIPTION
		G62067	END PARTITION FREE ACCESS 200CM FOR LOOSE POST
1	1	59147	END PARTITION FREE ACCESS BOX2011 MOUNTING KIT
2	1	59511	ACCESSORIES FREE ACCESS 2011
3	1	59504	ACCESSORIES BOX END PARTITIONFREE ACCESS 2011
(4)	1	4000642*	LOW POST INCL. SCREWS AND NUTS
(5)		4000643*	HIGH POST INCL. SCREWS AND NUTS

* Look at page 12.

() Must be bought separately.

M-6214_GB

SPARE PARTS FOR END PARTITION 200 CM FREE ACCESS BOX 2011 MOUNTING KIT

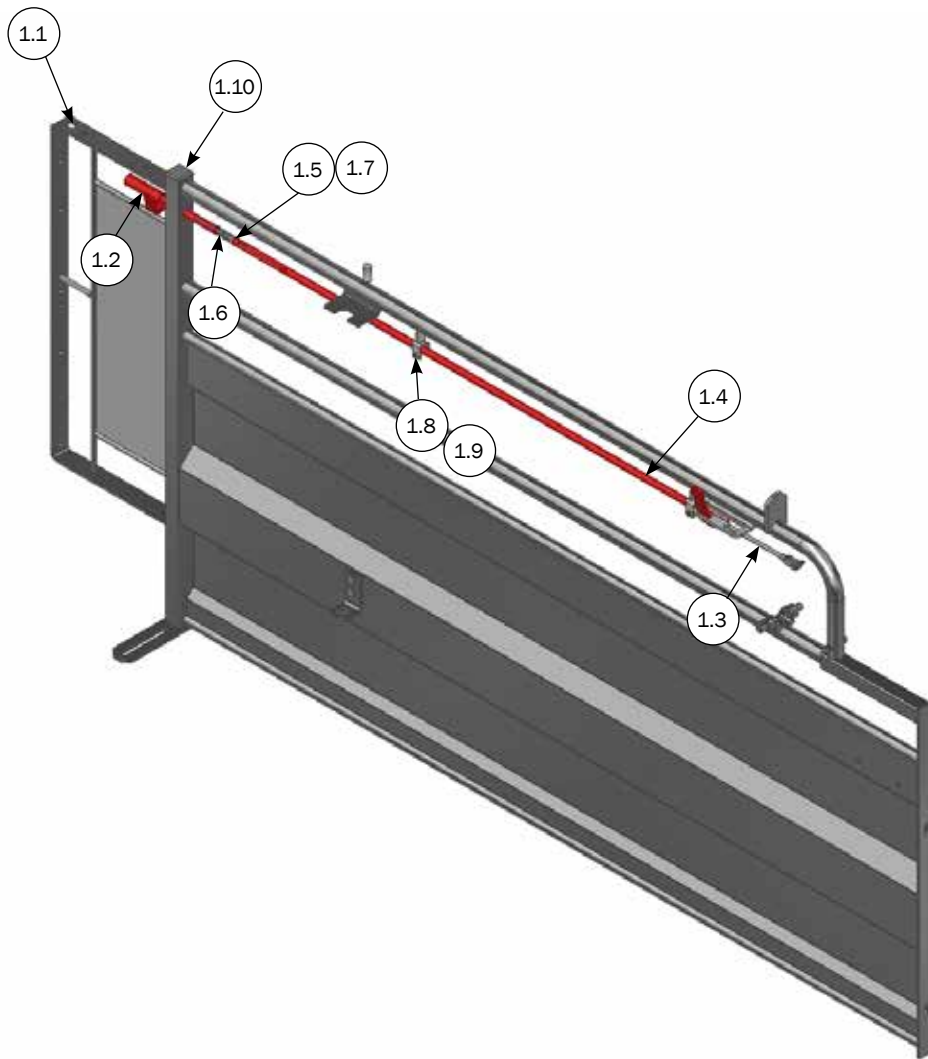

NO.	PCS.	ITEM NO.	DESCRIPTION
1	1	59147	END PARTITION FREE ACCESS BOX 2011 MOUNTING KIT
1.1	1	not available	END PARTITION 200 CM FREE ACCESS BOX 2011
1.2	1	not available	CONNECTION ARM FREE ACCESS BOX
1.3	1	not available	PIPE WITH FORK F. LOCK FREE ACCESS BOX
1.4	1	not available	EXTENSION ARM FIXATION LOCK FREE ACCESS BOX 2011
1.5	1	not available	3.2X20 COTTAR DIN 94-A2
1.6	2	58535	SPRING 1.5 X 15 X 45.5 MM
1.7	2	not available	SPRING 1,5X15X100MM SS
1.8	2	33596010	LOCK NUT M6 A2 DIN 985
1.9	2	67220	M6 X 35 HEX SCREW SS DIN 931
1.10	1	9960003	DUPSKO 40X40X2,5-4,0

ACCESSORIES FOR END PARTITION FREE ACCESS 2011

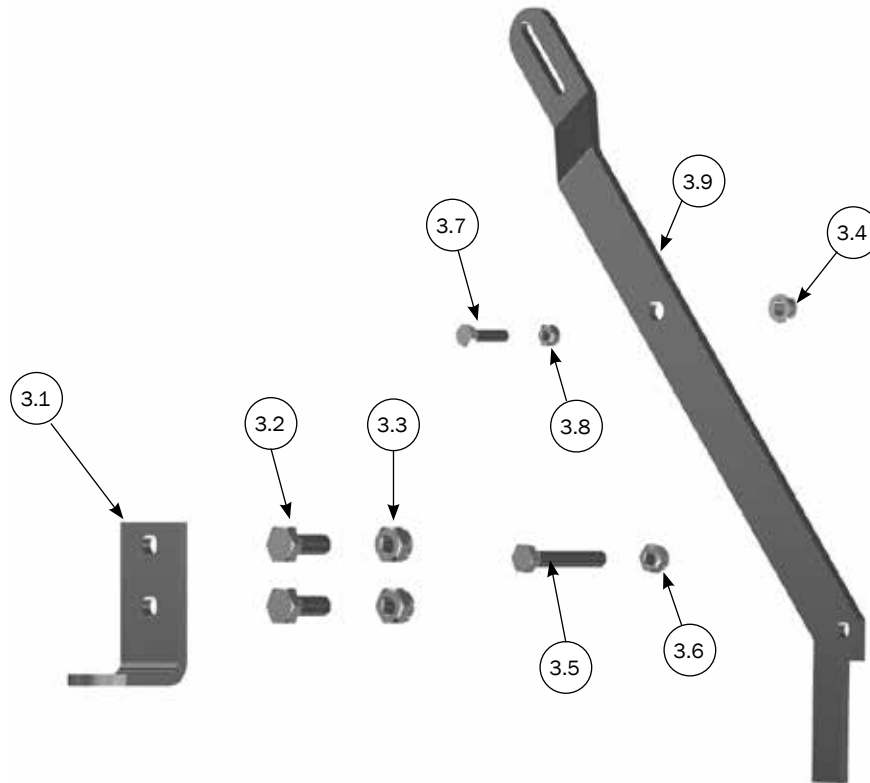

NO.	PCS.	ITEM NO.	DESCRIPTION
3	1	59504	ACCESSORIES BOX END PARTITION FREE ACCESS 2011
3.1	1	58121	FIXATION BRACKET END PARTITION FREE ACCESS BOX
3.2	1	30310025	SET SCREW M10X25 A2 DIN 933
3.3	1	33900029	LOCK NUT M10 A2 DIN 985
3.4	1	59523	BUSHING LOCK ENDPARTITION FREE ACCESS BOX
3.5	1	30308050	SET SCREW M8X50 A2 DIN 933
3.6	2	33908001	LOCK NUT M8 A2 DIN 985
3.7	2	30306025	SET SCREW M6X25 A2 DIN 933
3.8	2	33596010	LOCK NUT M6 A2 DIN 985
3.9	2	58128	UPPER LOCKING ARM FOR REAR GATE 2011

LOW/HIGH POST

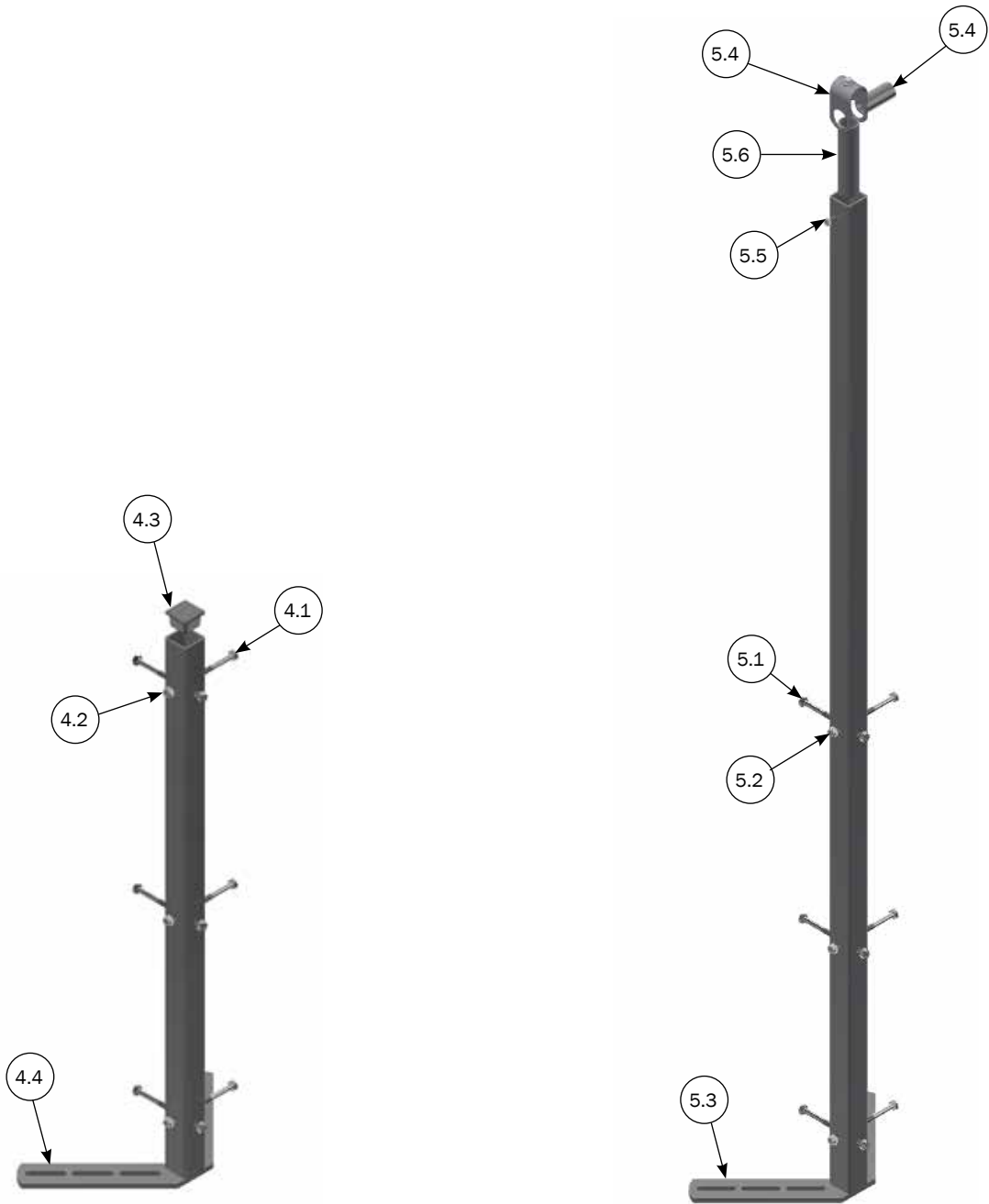

NO.	PCS.	ITEM NO.	DESCRIPTION
4	1	4000642	LOW POST INCL. SCREWS AND NUTS
4.1	6	32310075	MACHINE SCREW M10X75 A2 DIN 93
4.2	6	33900029	LOCK NUT M10 A2 DIN 985
4.3	1	9960005	CAP 50X50X5
4.4	1	4020642	LOW POST
5		4000643	HIGH POST INCL. SCREWS AND NUTS
5.1	6	32310075	MACHINE SCREW M10X75 A2 DIN 93
5.2	6	33900029	LOCK NUT M10 A2 DIN 985
5.3	1	4020643	HIGH POST
5.4	1	1910080	DOG CLAMP W/PIPE
5.5	1	30308016	SET SCREW M8X16 A2 DIN 933
5.6	1	8100240	1' GALV. PIPE L= 70MM

MOUNTING OF POST ON END PARTITION FREE ACCESS 2011

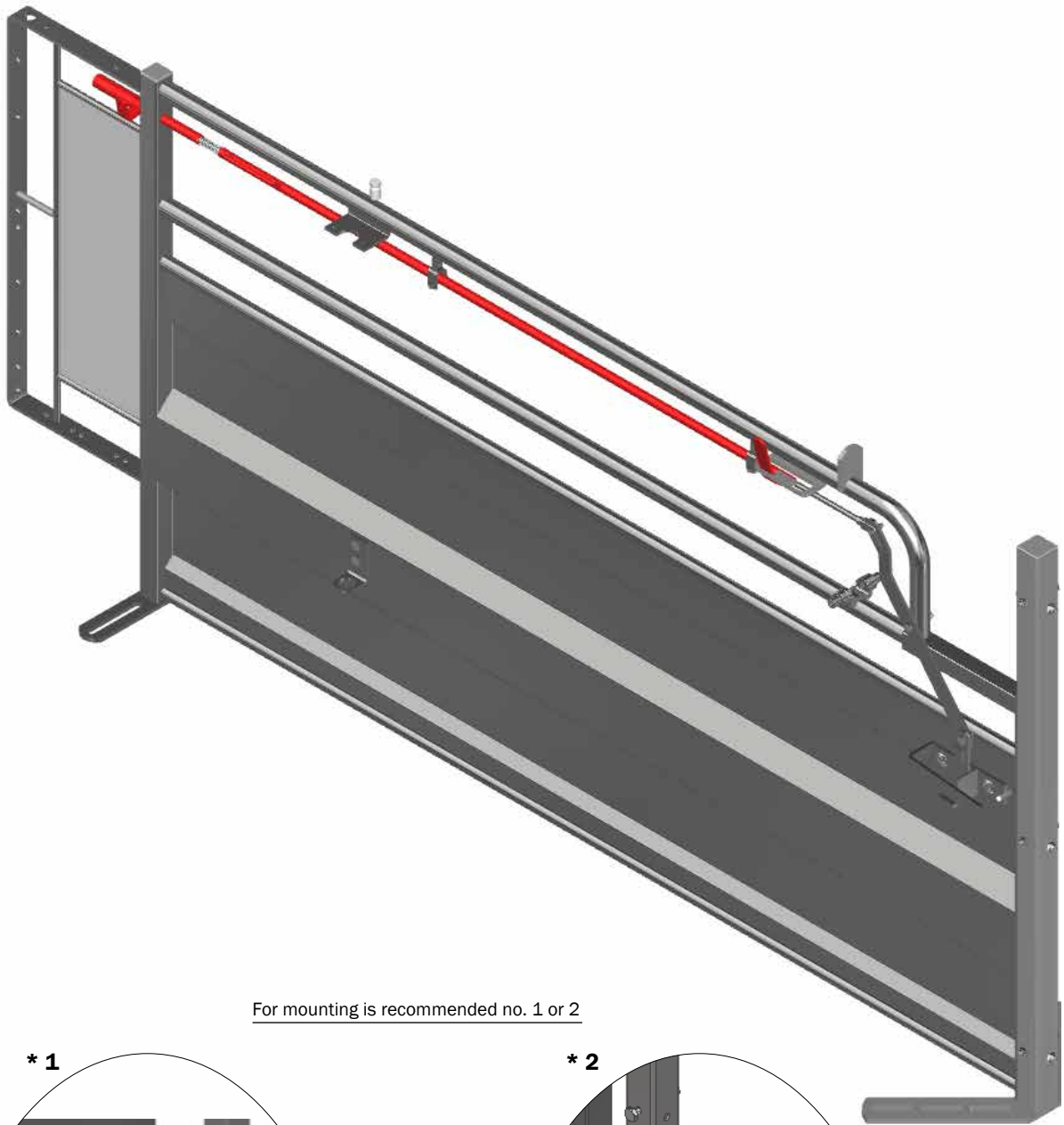

For mounting is recommended no. 1 or 2

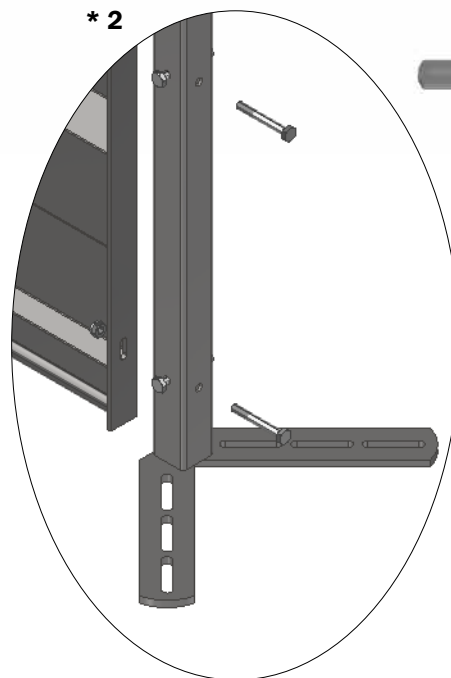
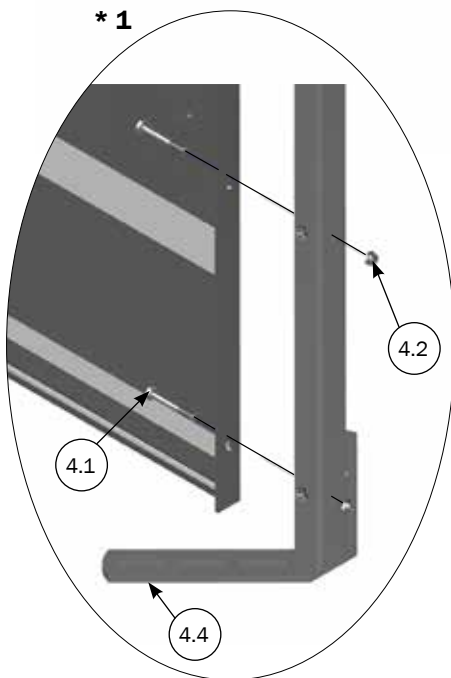

* For parts list look at page 12
M-6214_GB

MOUNTING OF BRACKET FOR FRONT GATE AND LOCK BRACKET

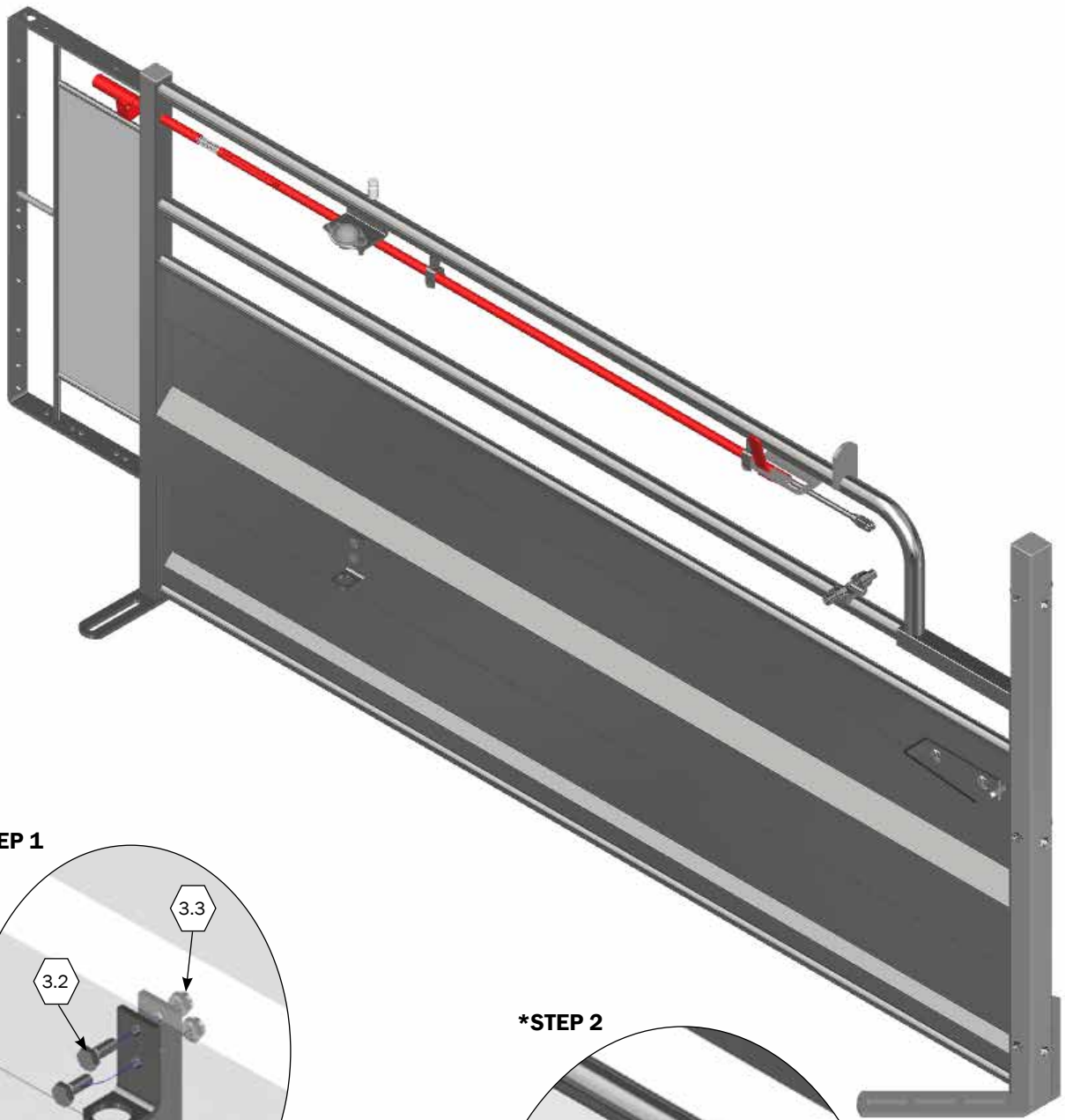

STEP 1

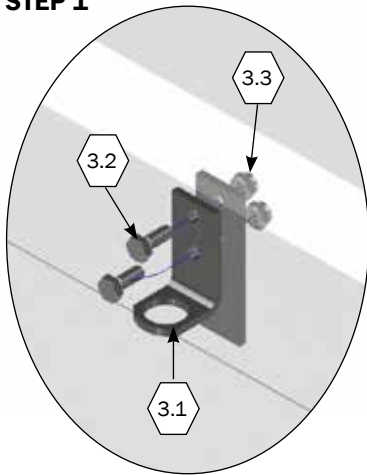

*STEP 2

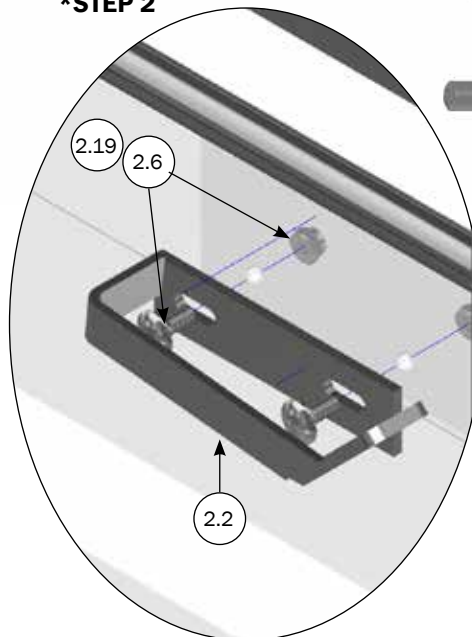

* For parts list look at page 4

⬡ For parts list look at page 11

M-6214_GB

MOUNTING OF UPPER LOCKING ARM FOR REAR GATE AND LOCK BRACKET

*STEP 1

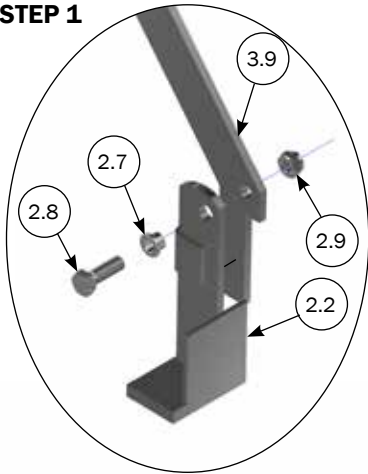

STEP 2

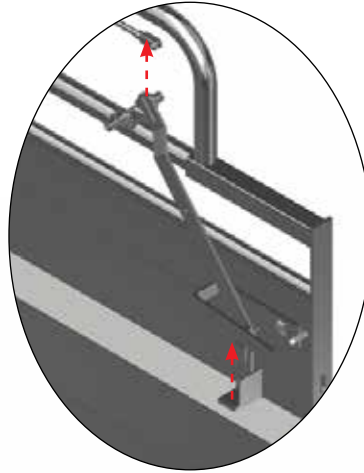

STEP 3

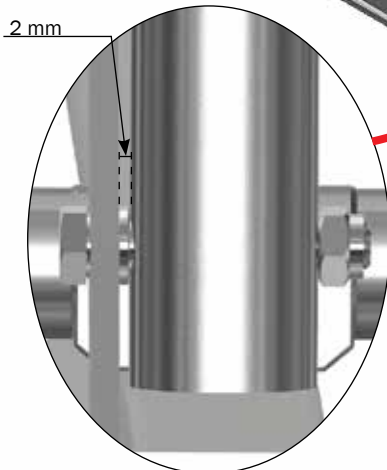
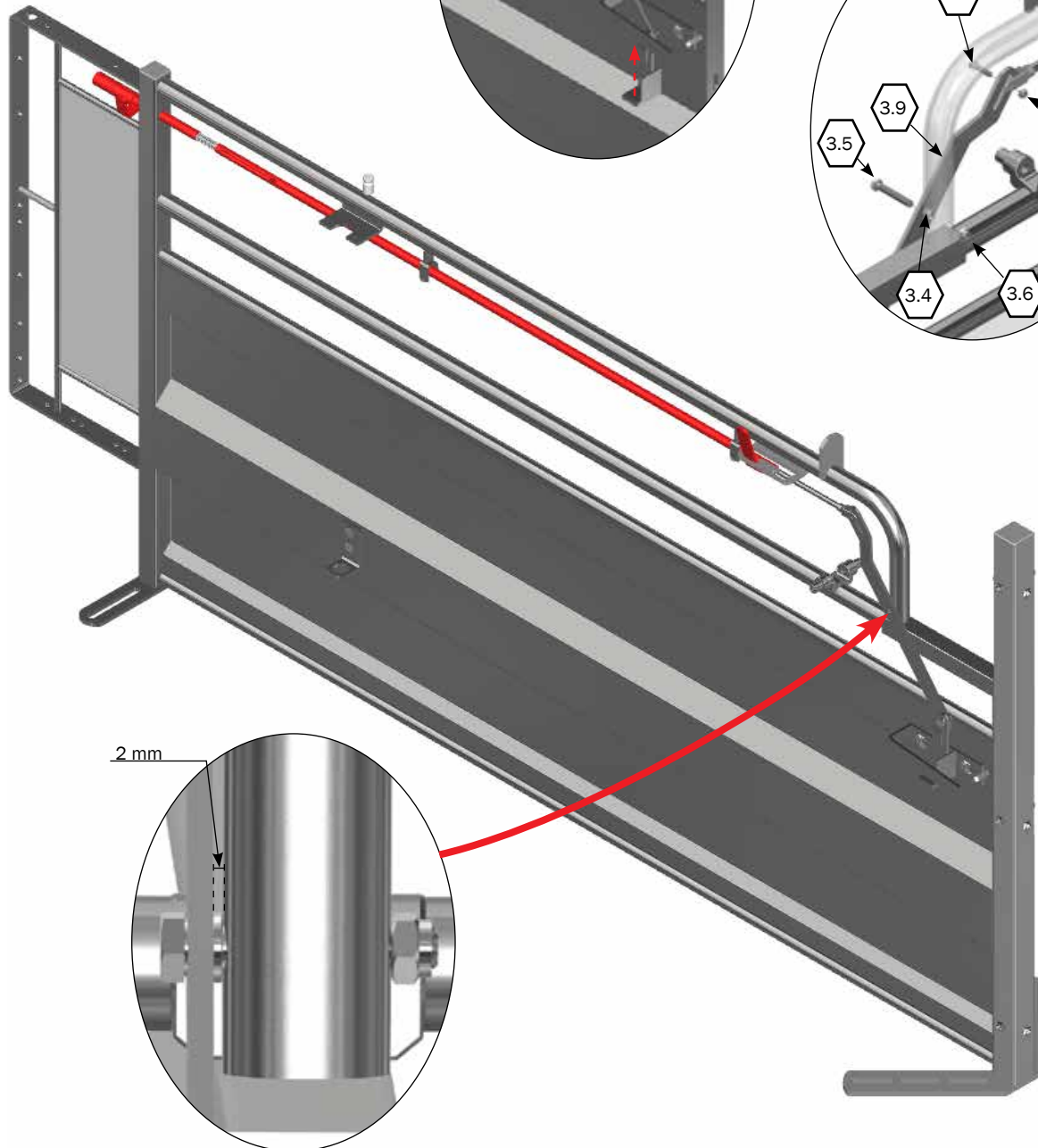
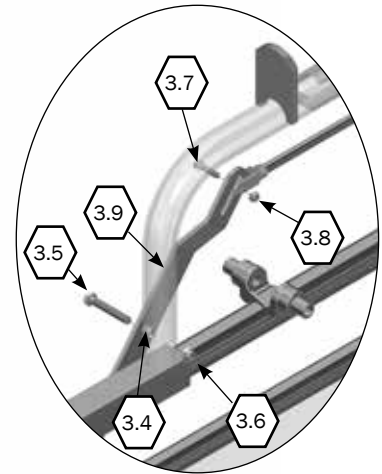

* For parts list look at page 4

⬡ For parts list look at page 11

M-6214_GB

FRONT/REAR GATE FOR PARTITION FREE ACCESS 234 CM

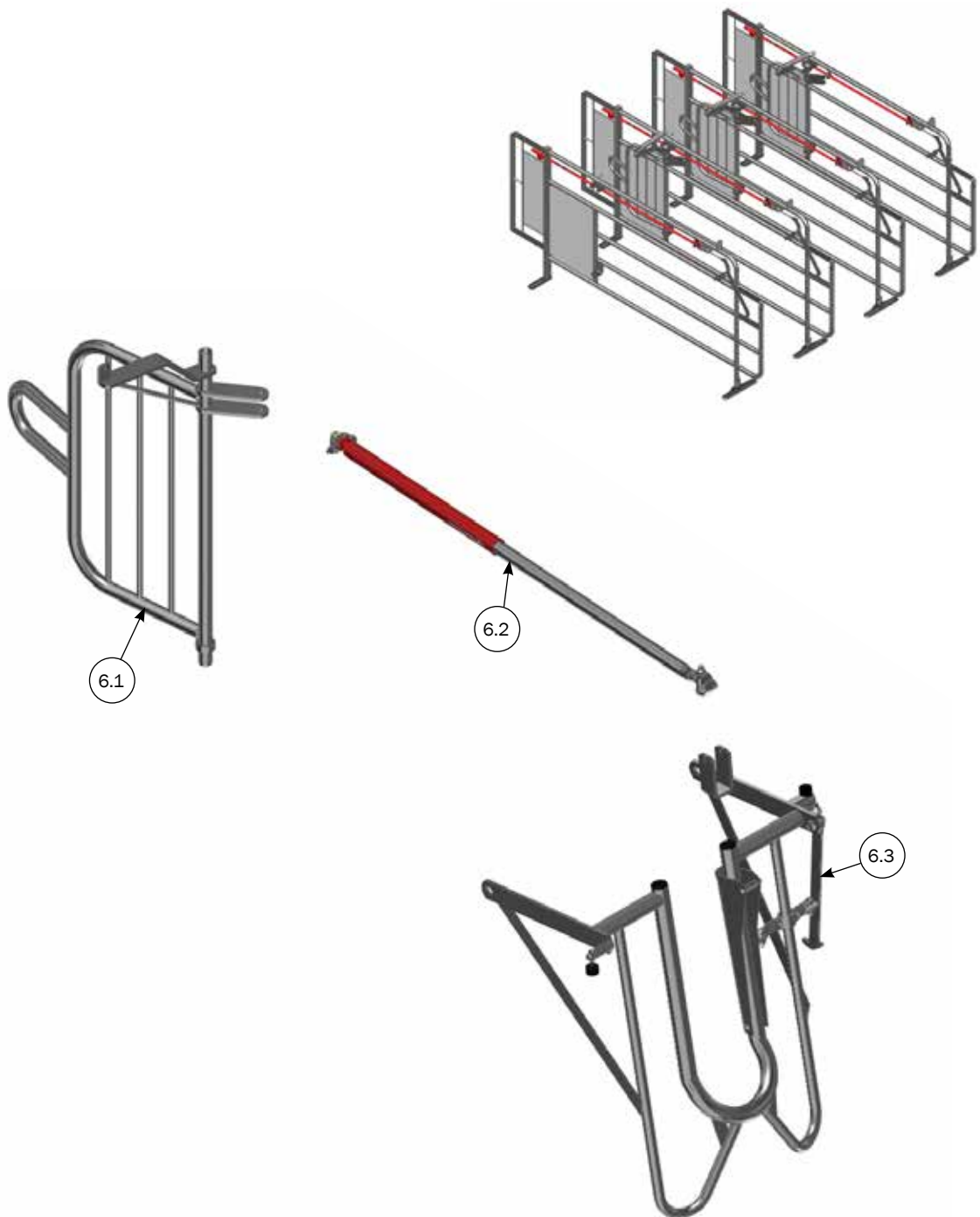

PARTS LIST			
NO.	PCS.	ITEM NO.	DESCRIPTION
		G62134	FRONT/REAR GATE WIDTH 60 CM
6	1	G62135	FRONT/REAR GATE WIDTH 65 CM
		G62136	FRONT/REAR GATE WIDTH 70 CM
6.1	1	59205HG	FRONT GATE FREE ACCESS STALL 2008
6.2	1	59652	CONNECTING ROD FREE ACCESS 105 CM 2011
6.3	1	59347	REAR GATE 650 MM FREE ACCESS BOX 2011 MOUNT.

MOUNTING OF FRONT GATE ON PARTITION/END PARTITION

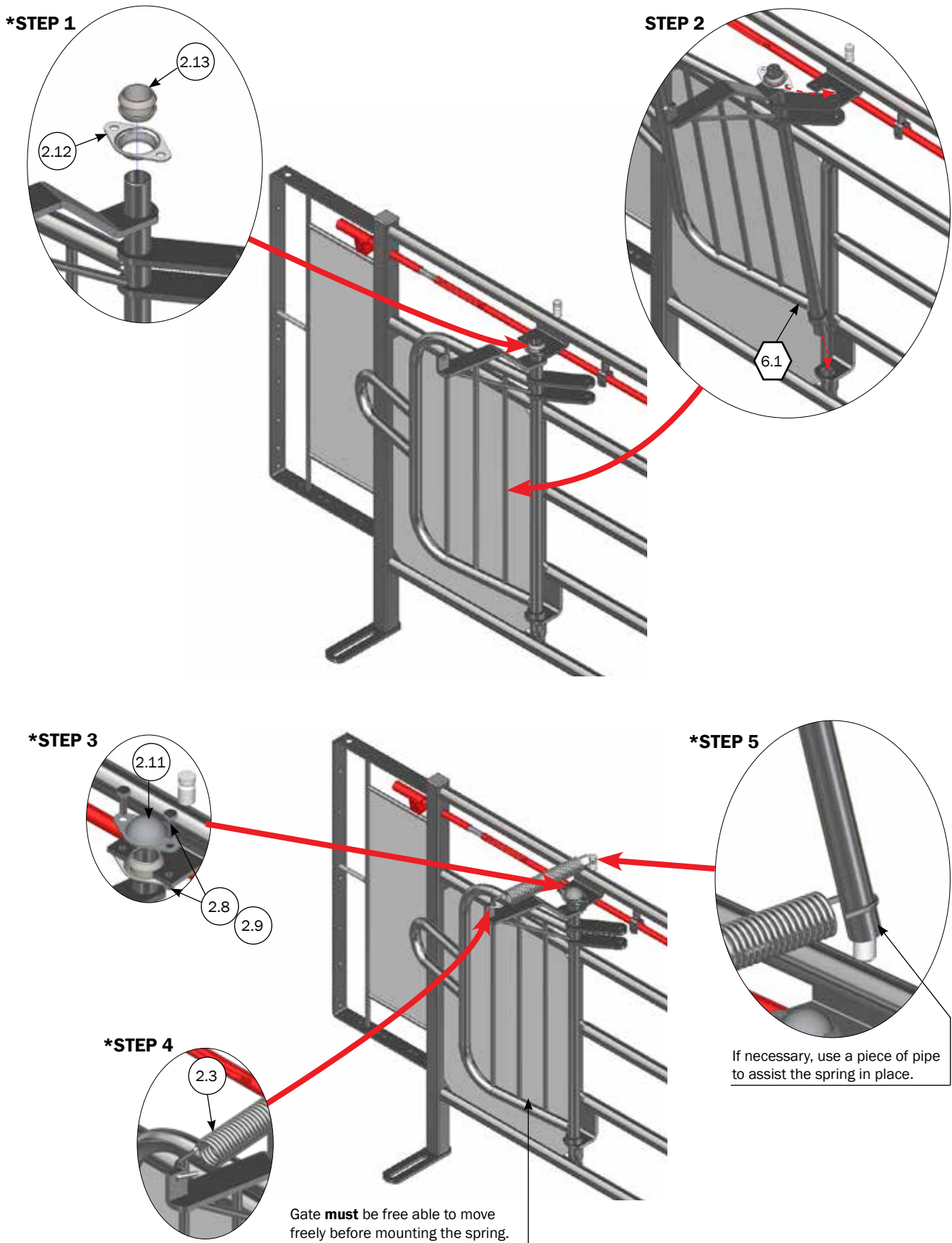

* For parts list look at page 4

⬡ For parts list look at page 16

M-6214_GB

MOUNTING OF REAR GATE ON PARTITION/END PARTITION

STEP 1

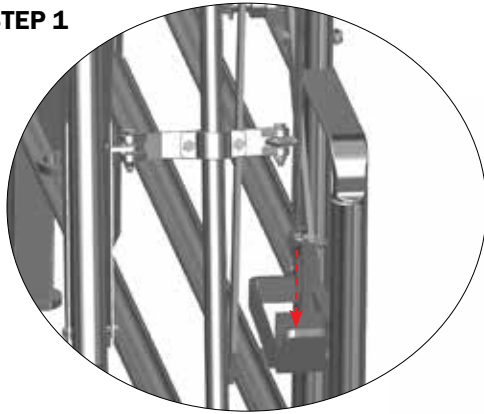

STEP 2

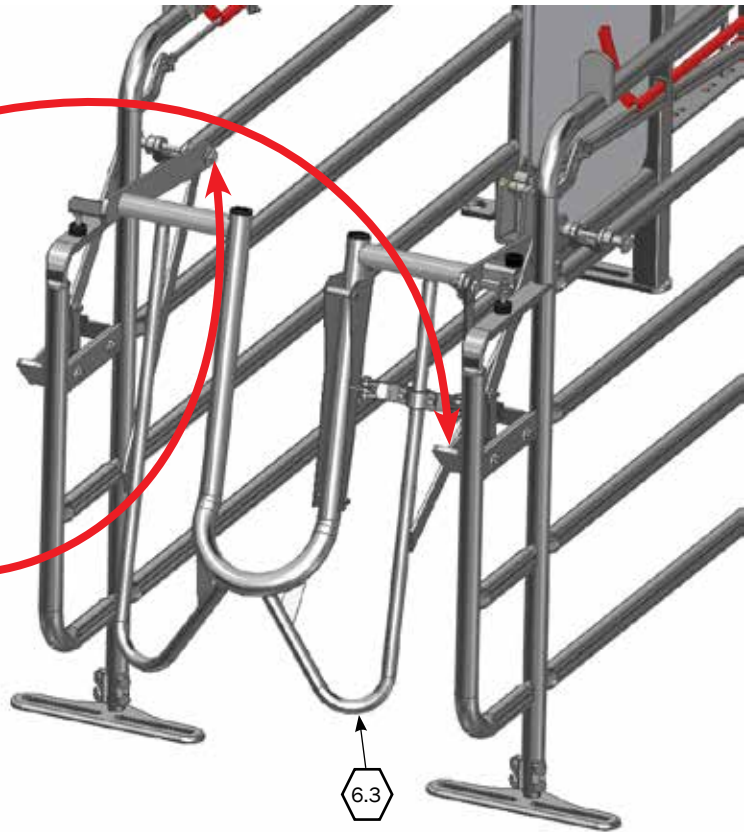
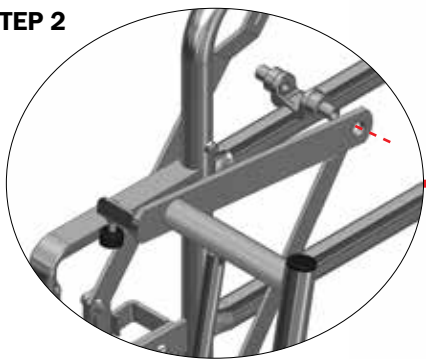

*STEP 3

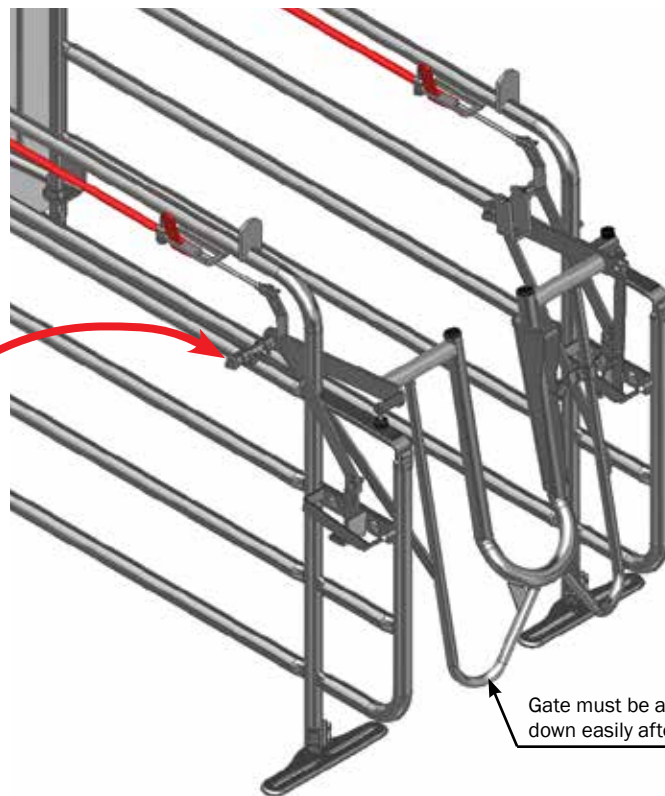
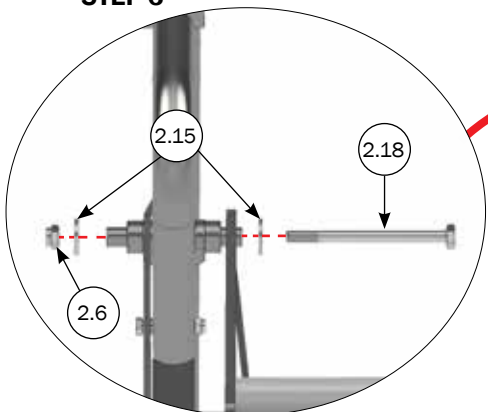

* For parts list look at page 4
⬡ For parts list look at page 16

M-6214_GB

MOUNTING OF CONNECTION ROD

*STEP 1

Illustration of correct setting of front/rear gate for connection rod adjustment.

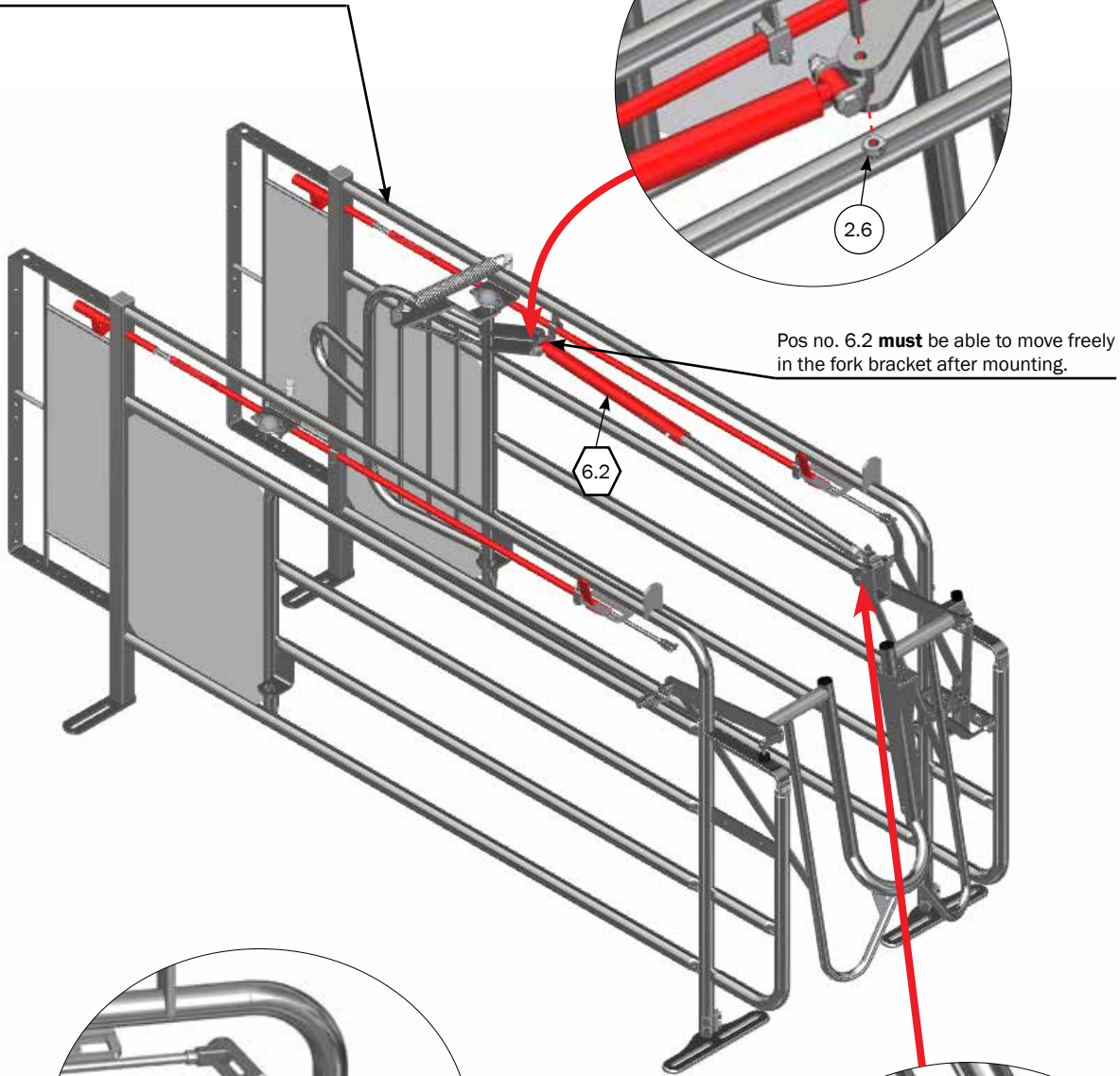

Pos no. 6.2 **must** be able to move freely in the fork bracket after mounting.

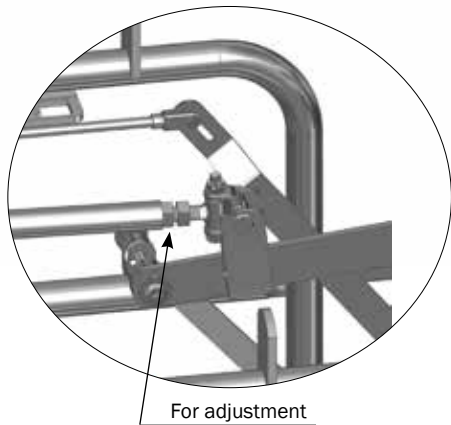

For adjustment

*STEP 2

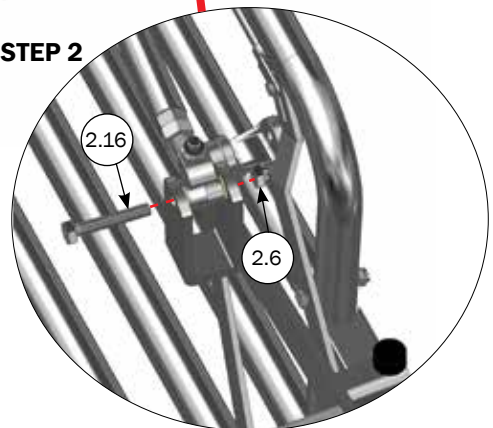

* For parts list look at page 4

⬡ For parts list look at page 16

M-6214_GB

MAINTENANCE OF FRONT-/REAR GATE

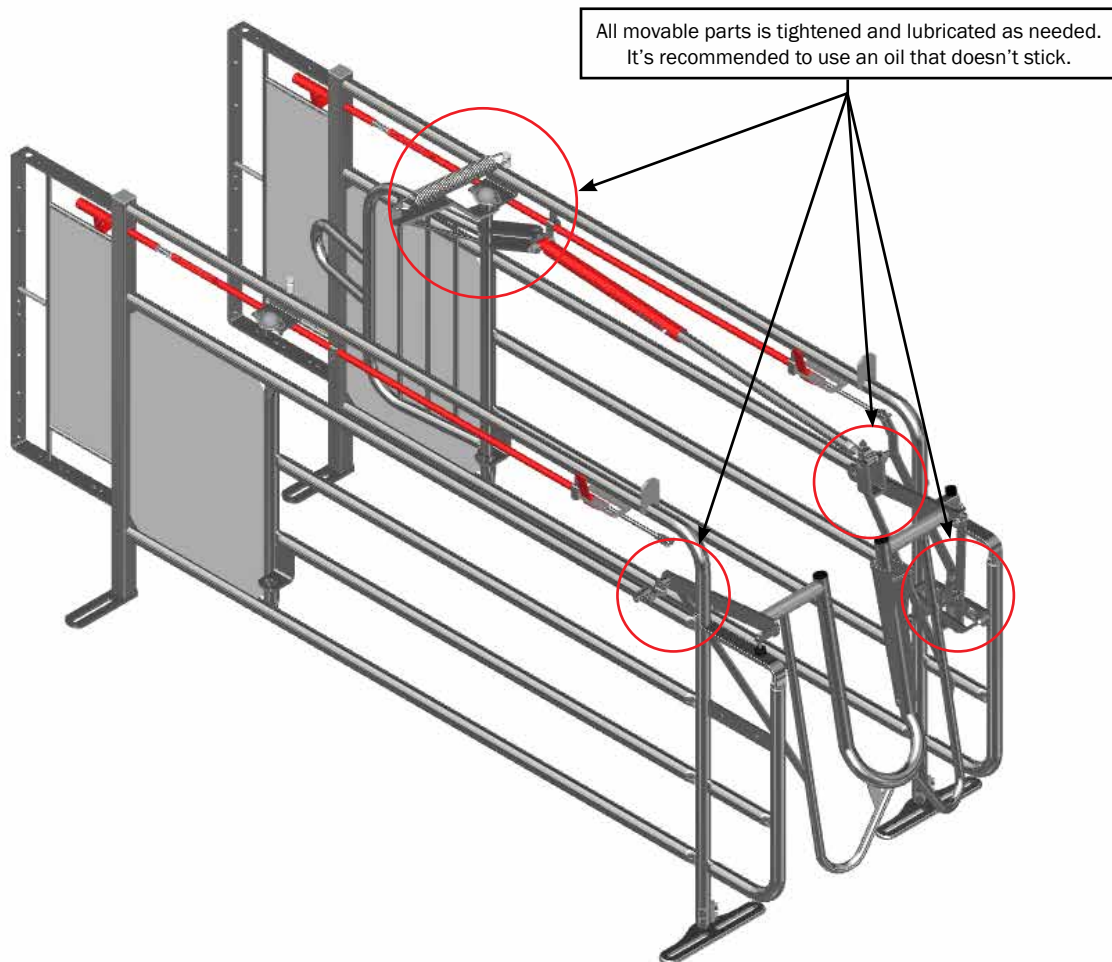

MOUNTING OF BRACKET F PLASTIC BEARING 40MM & DRIVER CLAMP FOR LOCK SYST.

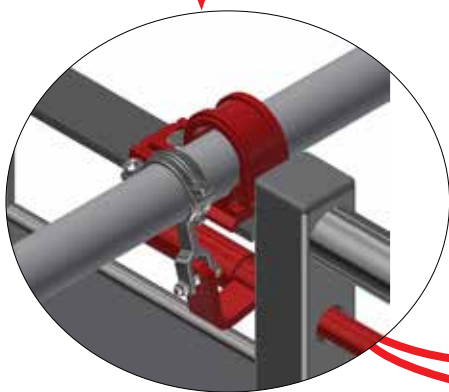
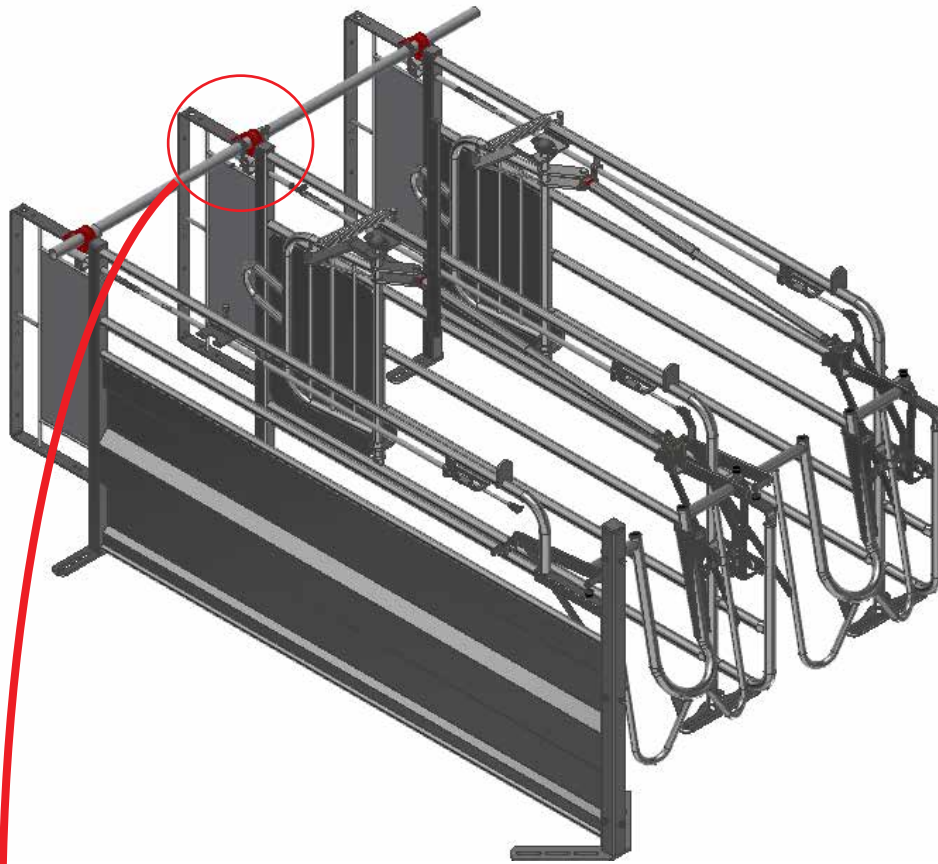

***STEP 1**

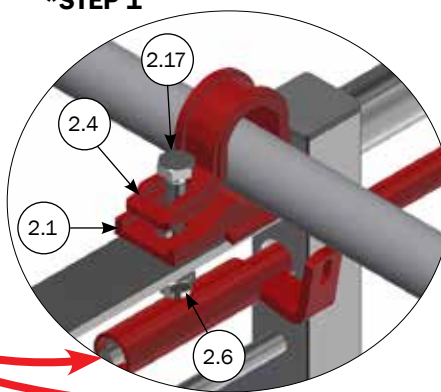

***STEP 2**

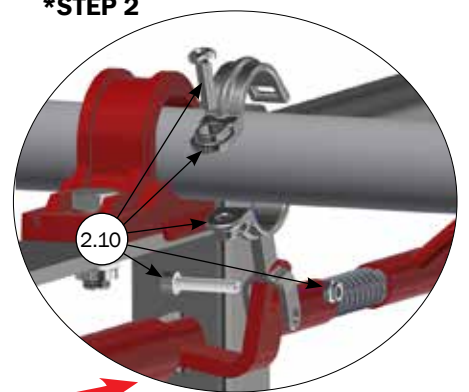

* For parts list look at page 4
M-6214_GB

SPARE PARTS FOR OPENING SYSTEM FREE ACCESS BOX MANUALLY

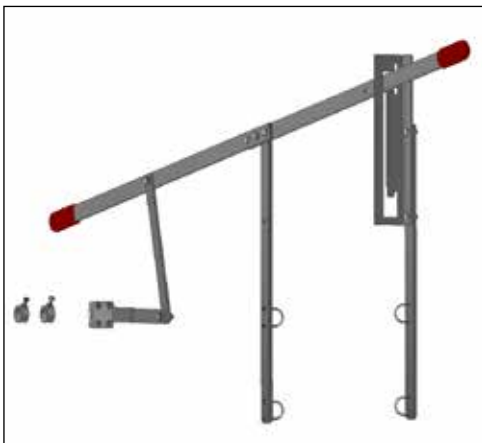
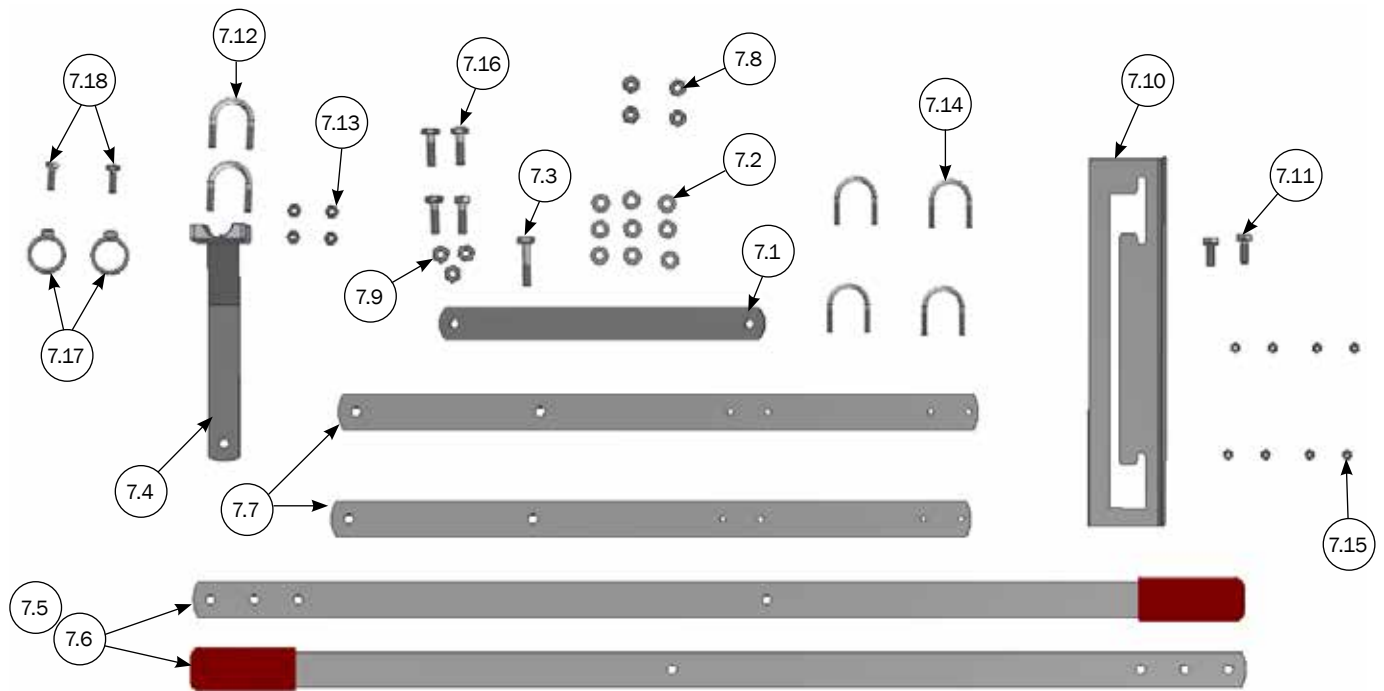

NO.	PCS.	ITEM NO.	DESCRIPTION
7	1	62142	OPENING SYSTEM FREE ACCESS STALLS MANUAL
7.1	1	not available	EXCHANGE 385MM J. OPEN/CLOSE ROD FREE ACCESS BOX
7.2	9	68746	10 MM WASHER, WHITE ZINC PLATED
7.3	1	32310050	MACHINE SCREW M10X50 A2 QUAL.10.9 DIN 931
7.4	1	not available	GEARLEVER 250MM
7.5	2	59444	HANDLE FOR OPENING LEVER
7.6	2	not available	OPENING LEVER 1195MM FREE ACCESS BOX
7.7	2	not available	STANCHION FOR OPENING LEVER 730MM FREE ACCESS BOX
7.8	4	33510017	NUT M10 A2 DIN 934
7.9	3	33900029	LOCK NUT M10 A2 DIN 985
7.10	1	not available	GUIDE BRACKET FOR LEVER
7.11	2	30310025	SET SCREW M10X25 A2 DIN 933
7.12	2	90100062	U-BOLT 1' STAINLESS
7.13	4	33508013	NUT M8 A2 DIN 934
7.14	4	not available	U-CLAMP 38MM/6MM
7.15	8	33506010	NUT M6 A2 DIN 934
7.16	4	32310035	SET SCREW M10X35 A2 DIN 933
7.17	2	4620015	LOCKING RING FOR 1' PIPE
7.18	2	30308025	SET SCREW M8X25 A2 DIN 933

MOUNTING OF STANCHION FOR OPENING LEVER FREE ACCESS BOX MANUALLY

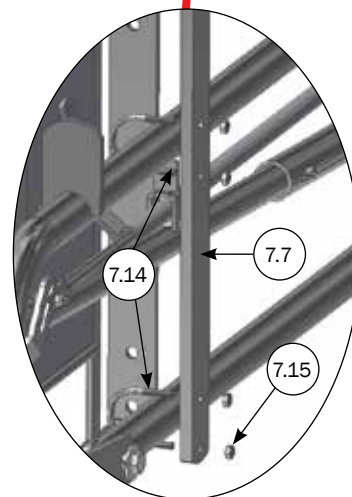
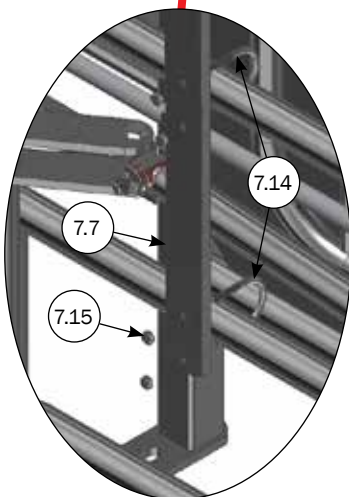
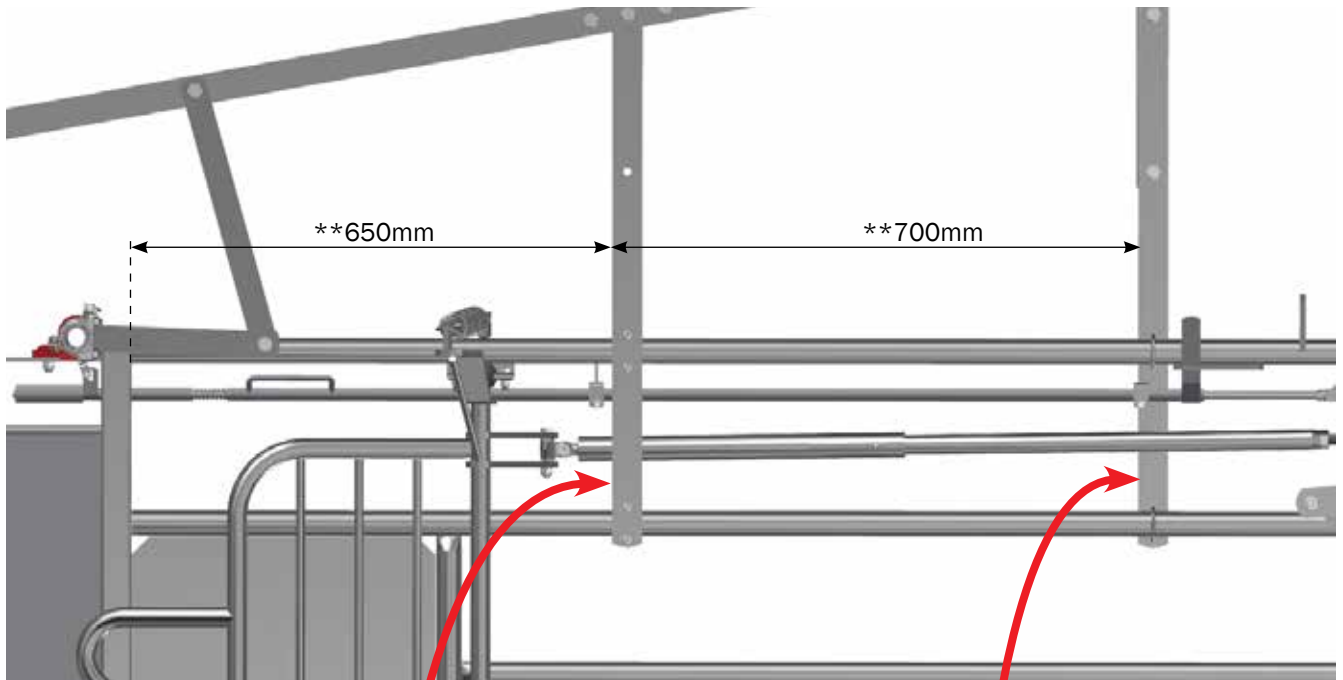

* For parts list look at page 22

**important that length is respected

M-6214_GB

MOUNTING OF GUIDE BRACKET AND OPENING LEVER

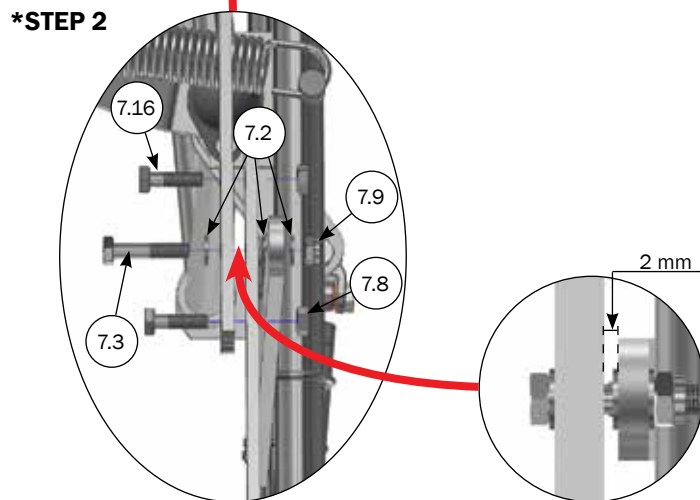
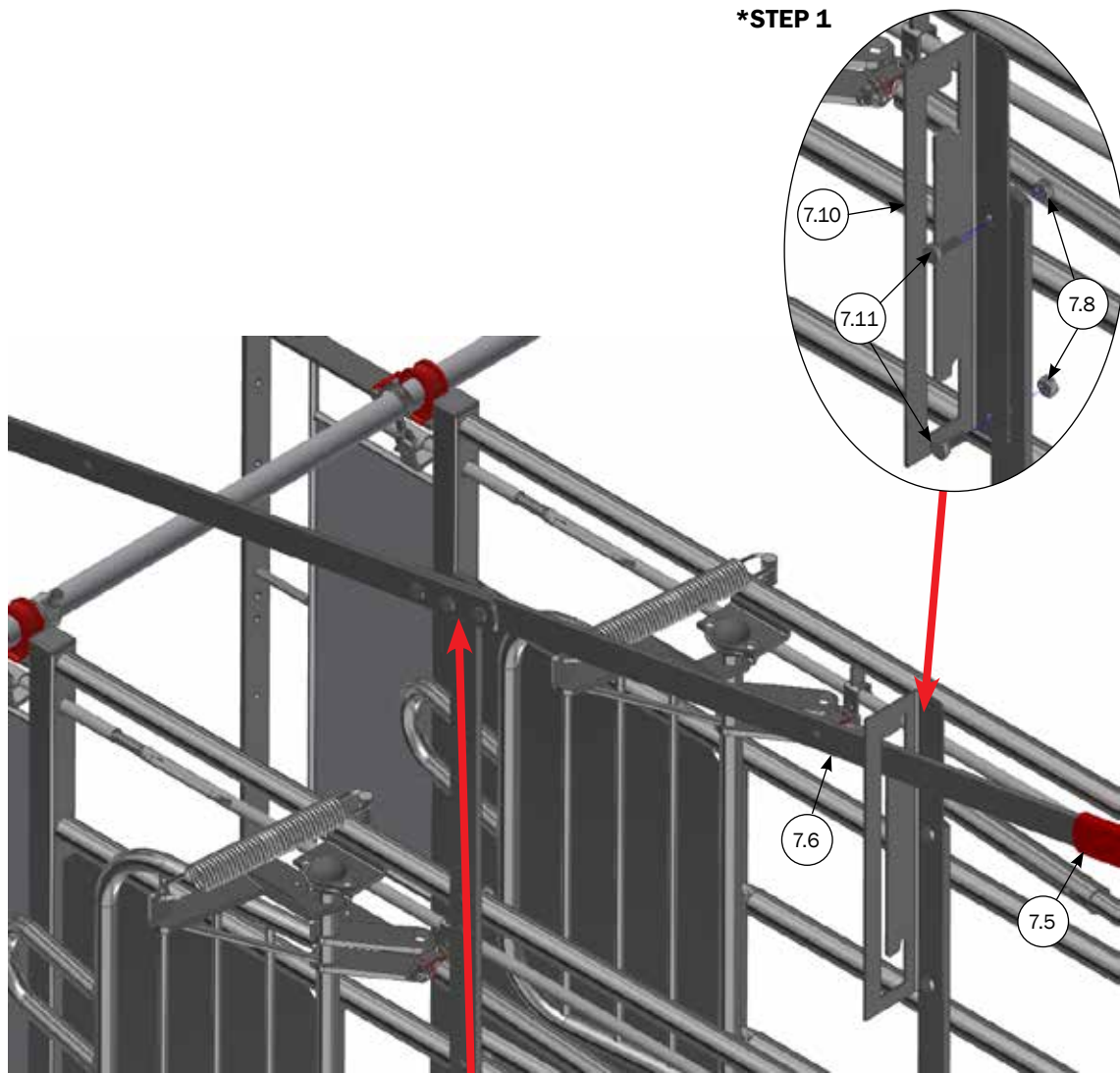

* For parts list look at page 22
M-6214_GB

MOUNTING OF GEARLEVER AND EXCHANGE FOR OPEN/CLOSE ROD

*STEP 1

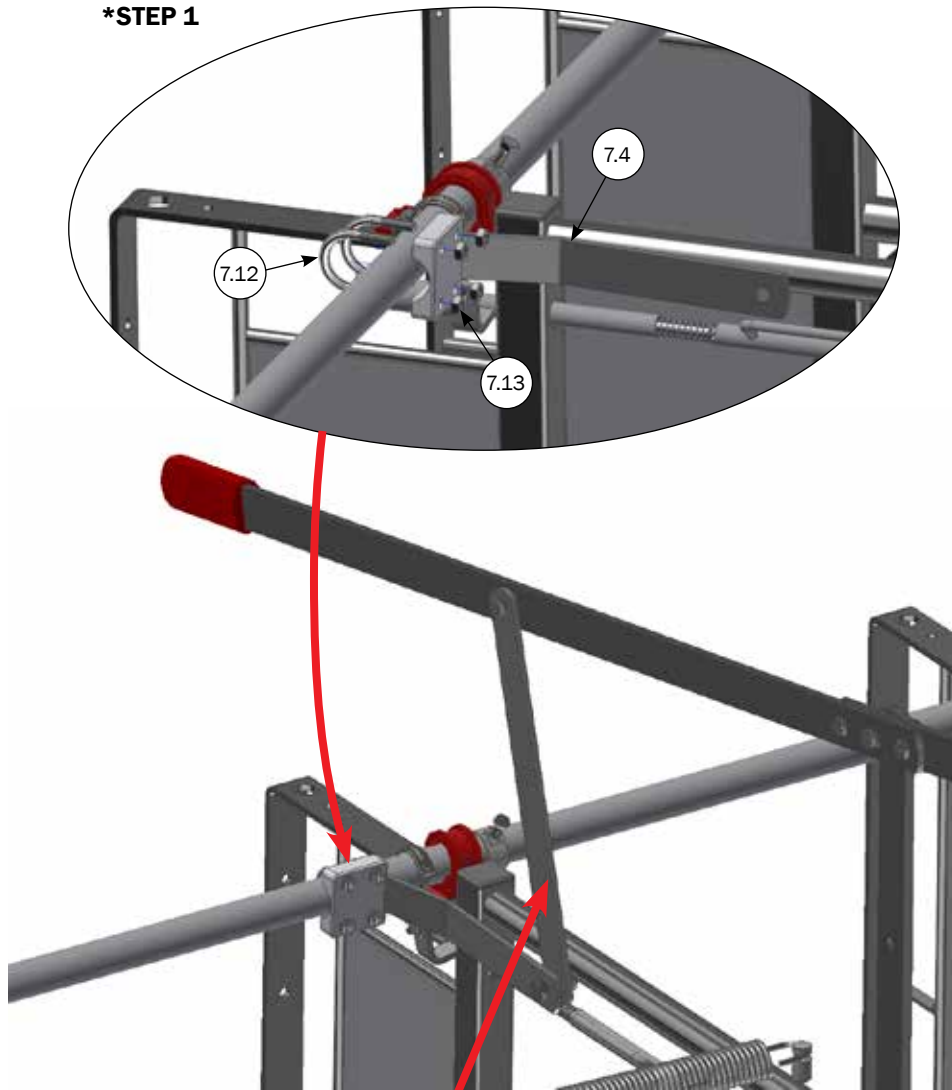

*STEP 2

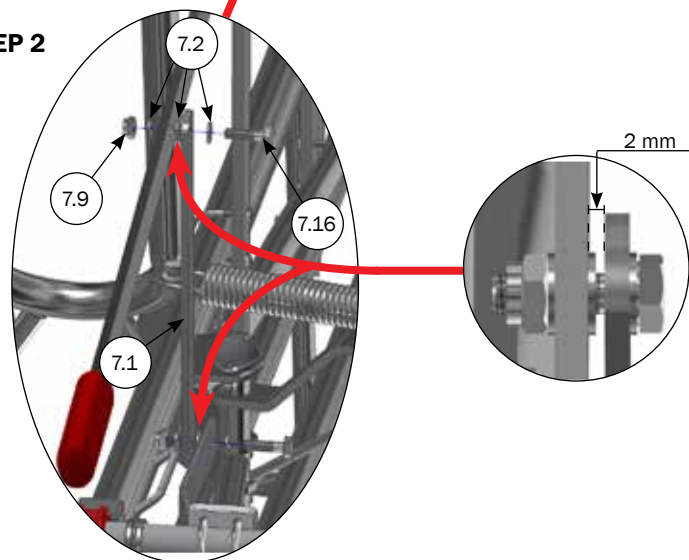

* For parts list look at page 22

M-6214_GB

ACO FUNKI A/S · Kirkevænget 5 · DK-7400 Herning · Tel. +45 97 11 96 00 · Fax. +45 97 11 96 77 · www.acofunki.com

25/28

MOUNTING OF LOCKING RINGS

It's recommended when assembly of pipes :

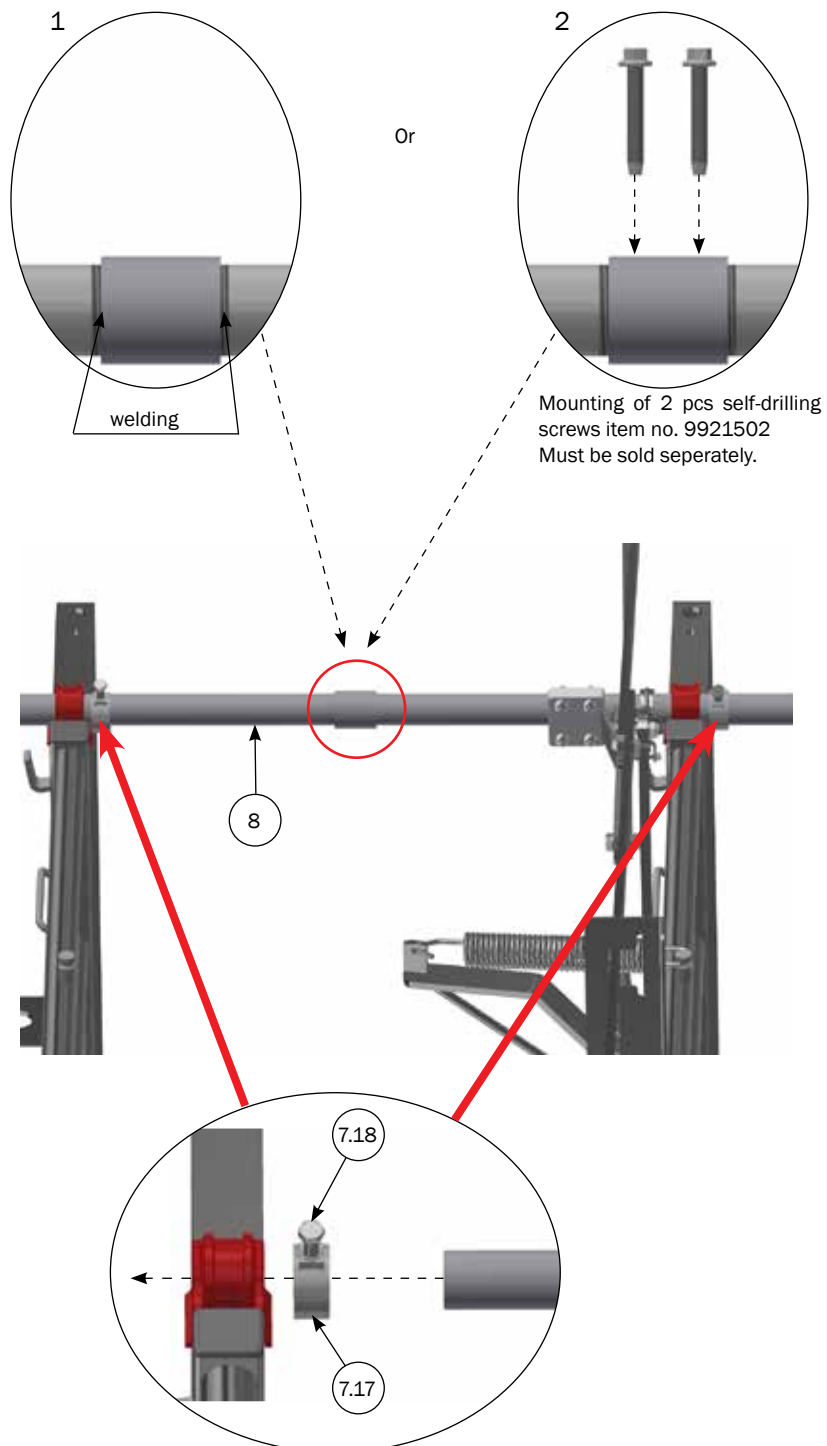

After mounting of **Pos. nr. 7.17** the pipe **must** be locked sideways.

PARTS LIST			
NO.	PCS.	ITEM NO.	DESCRIPTION
8		1900240	PIPE 1' GALVANIZED, 6 METER WSPLICING SLEEVE, PRICE PER PIECE, LENGTH 6 METER

* For parts list look at page 22

M-6214_GB

TEST OF OPENING SYSTEM MANUELLY FOR FREE ACCESS BOX

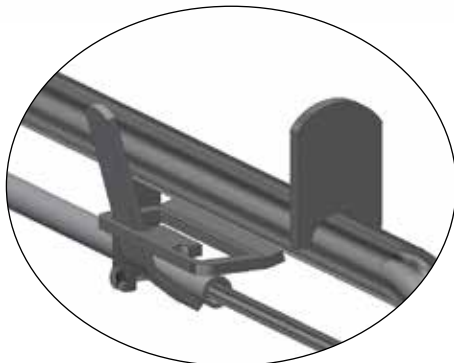
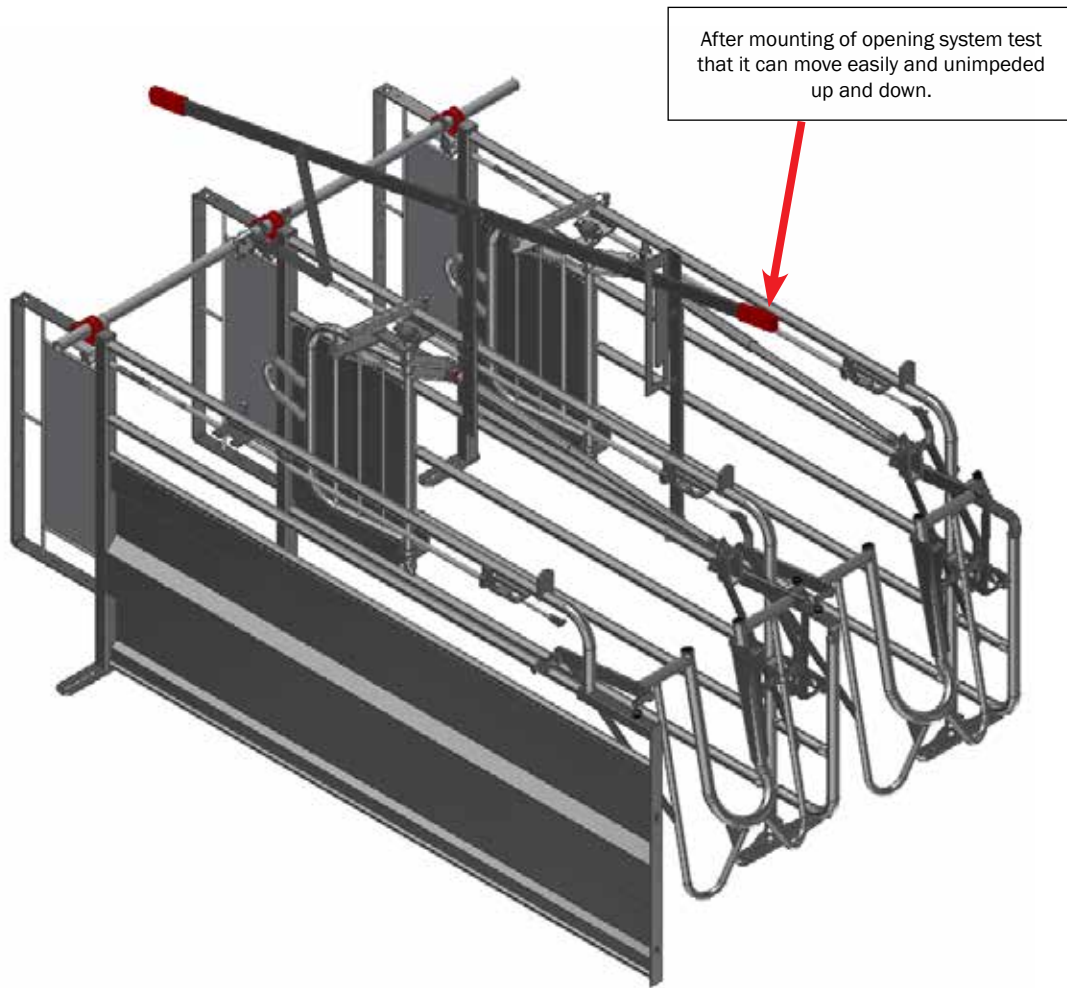

Handle position for single box when closed.

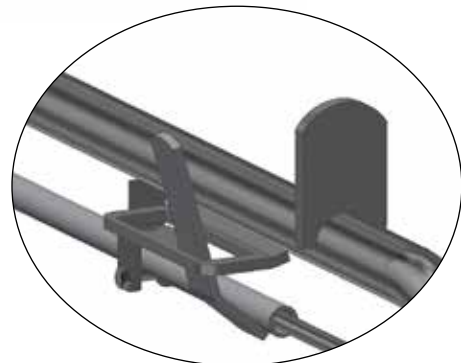

Handle position for single box when open.



All the boxes open.

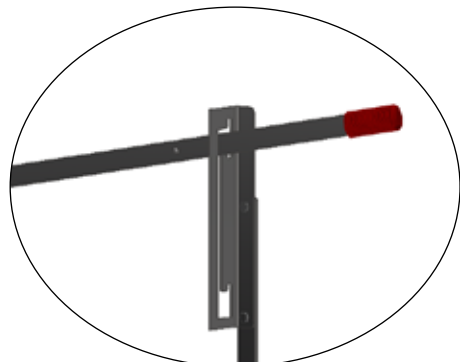

All the boxes locked regardless handle position.

MOUNTING OF OPENING SYSTEM AIR CYLINDRE

For mounting of front bars look at mounting instruction : M-6183

***STEP 1**

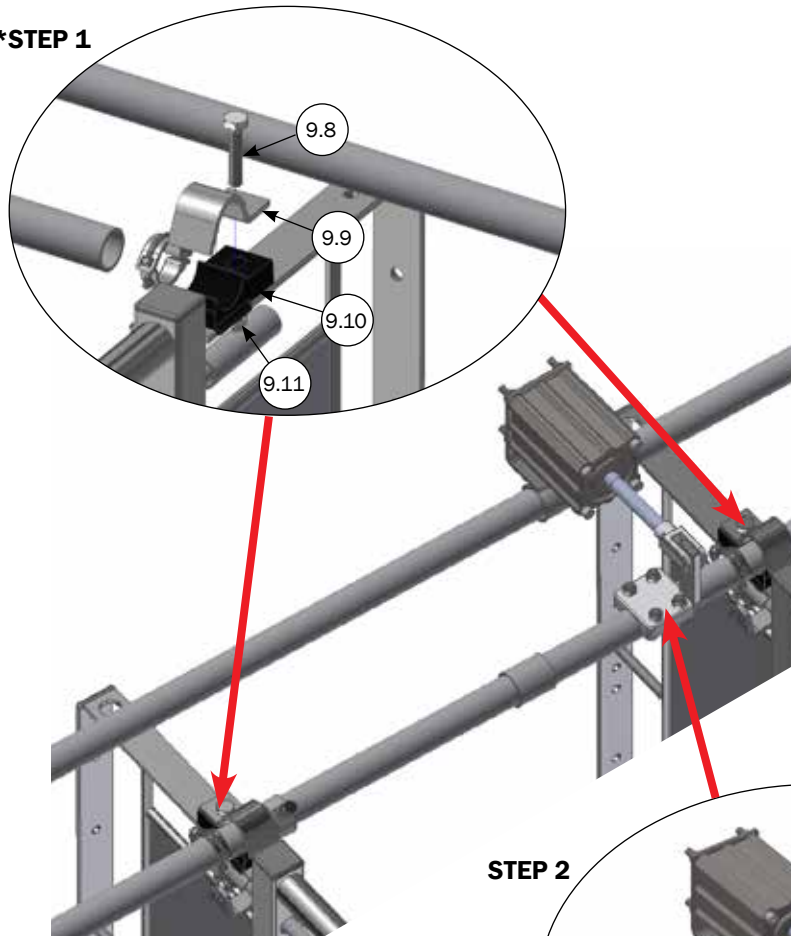

STEP 2

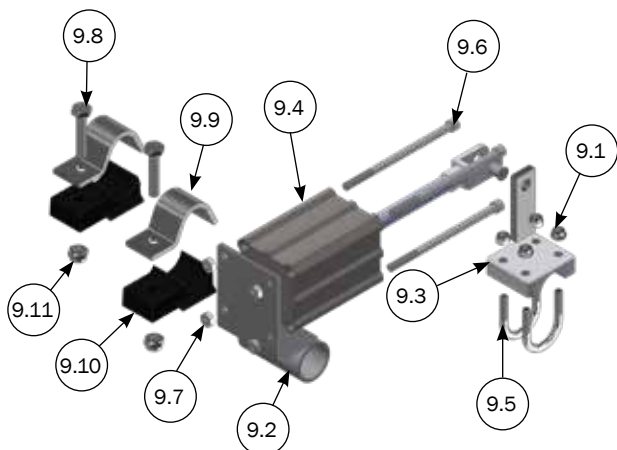
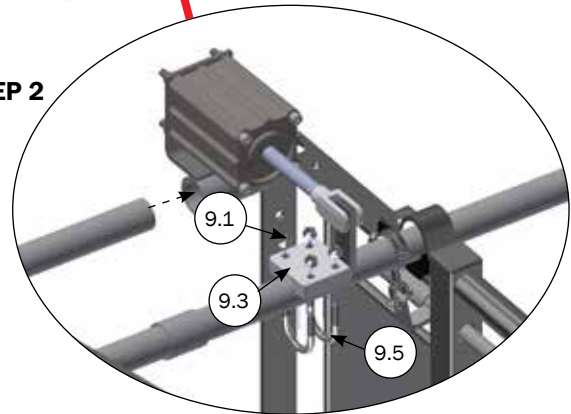

PARTS LIST

NO.	PCS.	ITEM NO.	DESCRIPTION
9	1	62156	OPENINGSYSTEM AIR CYLINDRE FREE ACCESS 2008
9.1	4	33908001	LOCK NUT M8 A2 DIN 985
9.2	1	59417	BRACKET PNEUMATIC CYLINDER FREE ACCESS
9.3	1	59416	BRACKET PNEUMATIC CYLINDER FREE ACCESS
9.4	1	59408	AIR CYL. INCL. FORT FOR OPENER SYST. FRE
9.5	2	90100062	U-BOLT 1' STAINLESS
9.6	4	67373	8 X 140 INSEX CH FZB
9.7	4	33208014	NUT M8 FZV DIN 934
9.8	2	30310050	SET SCREW M10X50 A2 DIN 933
9.9	2	16375	PIPE RETAINER 1' WITHOUT BOLT
9.10	2	58515	PLASTICBEARING F/1 JOINT OPENING BAR
9.11	2	33900029	LOCK NUT M10 A2 DIN 985

* Pos 2.4 og 2.17 (look at page 4) is not in use when the air cylinder is mounted .

M-6214_GB