

Subtractions concerning FUNKI FIBER projects

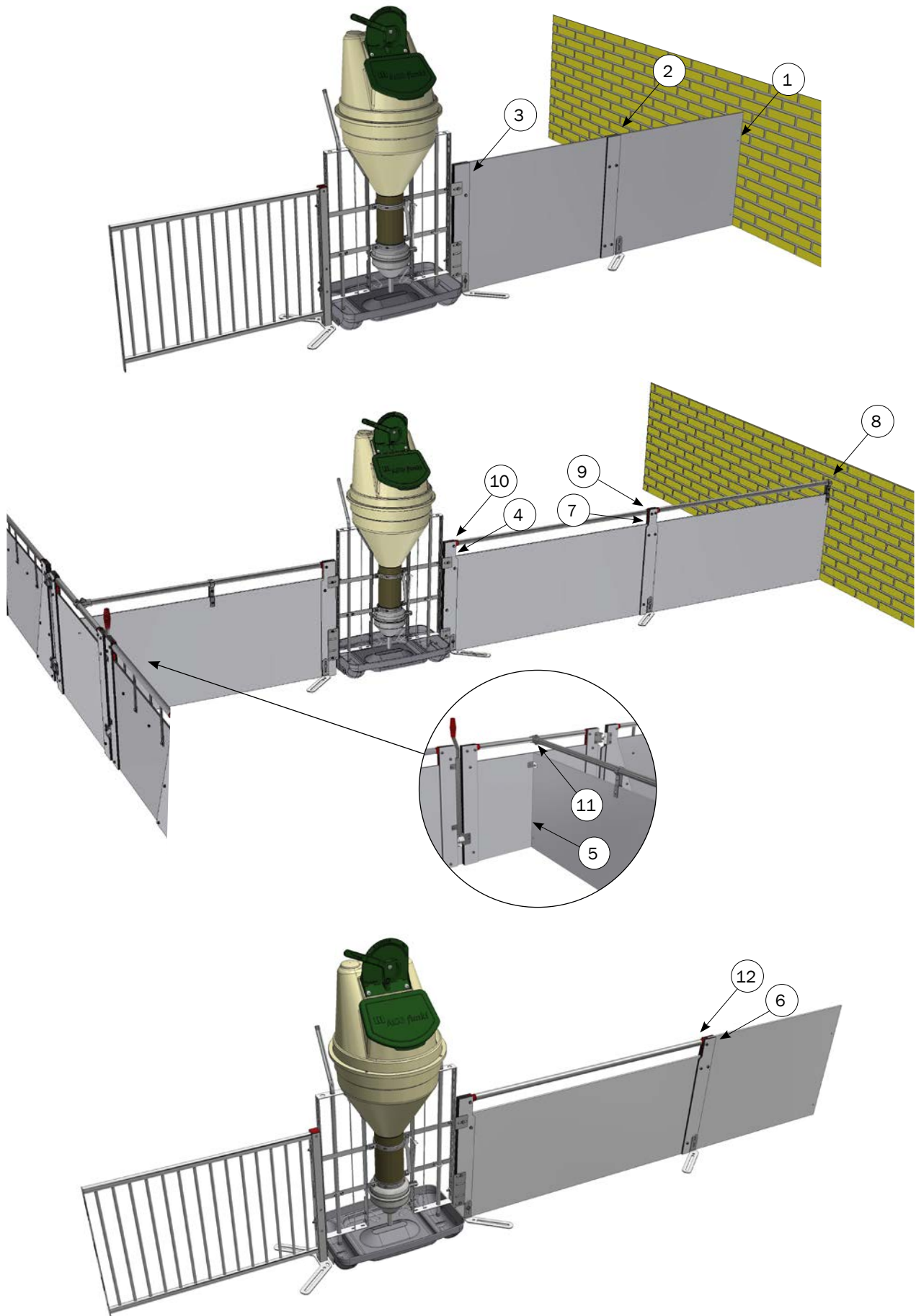

Subtractions concerning FUNKI FIBER projects

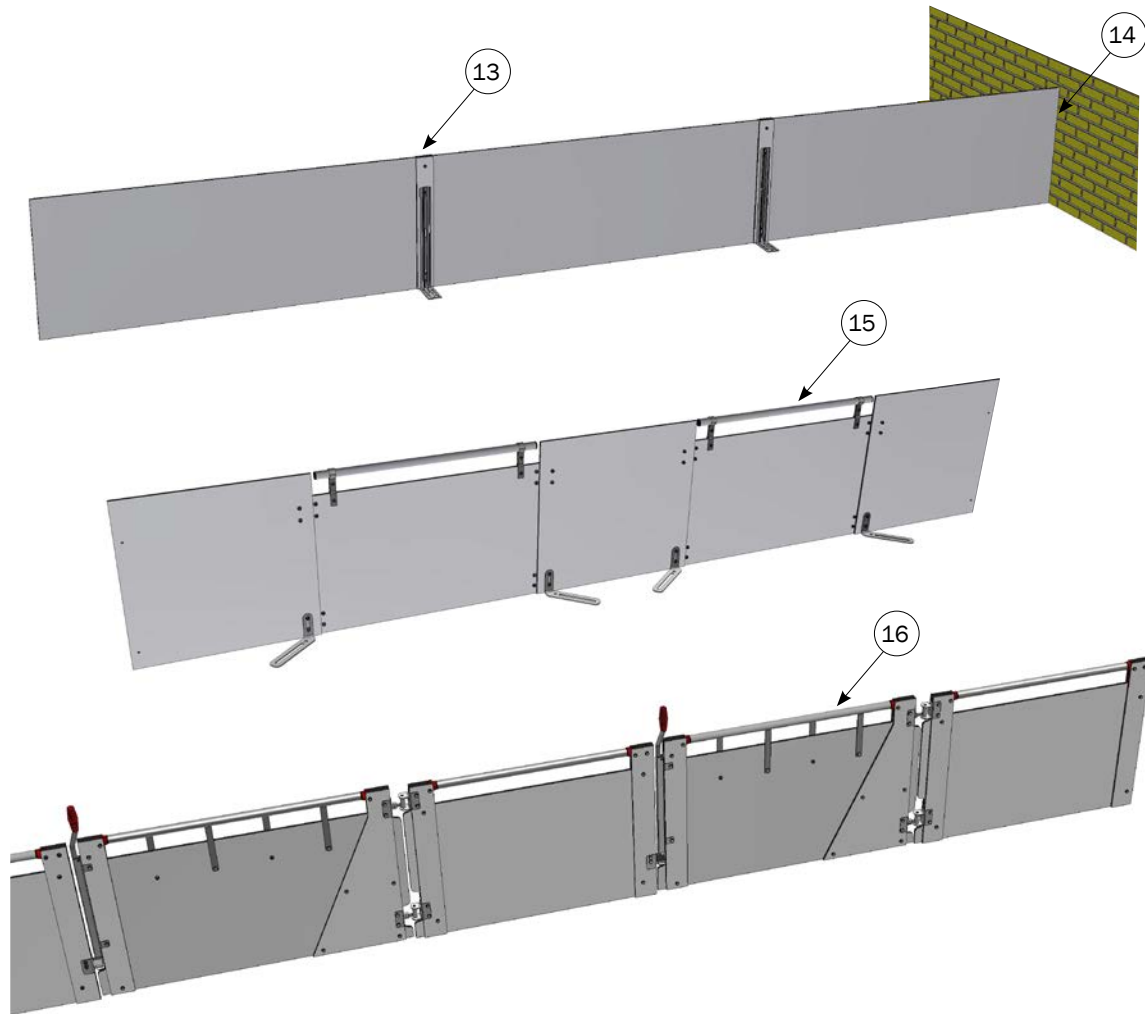

ADAPTATION VALUES

No.	Description	Adaptation (mm)
1	Partition against wall	0
2	Partition against post (e.g. 4300433)	0
3	Partition against post for feeder (e.g. 4300442)	- 46
4	Partition against post (pipe - partition against feeder) (e.g. 4300445)	- 46
5	Partition against front part (measured on the inside). (= Pipe inside + 12 mm)	0
6	Partition against combination post (pipe - partition) (e.g. 4300440)	0
7	Partition against post (pipe against pipe) (e.g. 4300438)	0
8	Pipe against wall	- 10
9	Pipe against post (e.g. 4300438)	- 49
10	Pipe against post for feeder (e.g. 4300445)	- 95
11	Pipe against front part (measured on the inside). (= Pipe inside ÷ 23 mm)	- 35
12	Pipe against combination post (pipe - partition) (e.g. 4300440)	- 49
13	Washing wall against post (e.g. 4310448)	- 19
14	Washing wall against wall	0
15	Length of full-width gate, front part to front part	+ 30 (Opening)
16	Length of variable gate, post to post	- 20 (Opening)