

| M-1018-GB |

ASSEMBLY INSTRUCTION

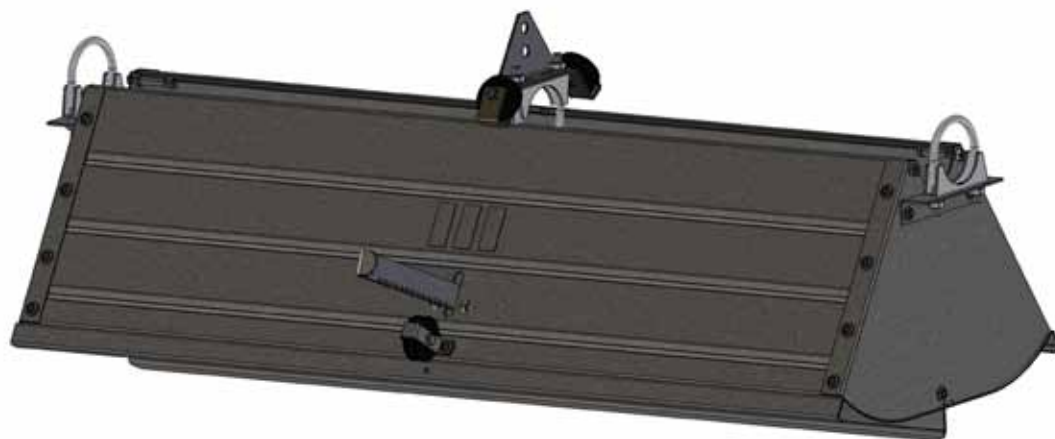

VD 100

Feed dispenser



ACO FUNKI A/S
Kirkevænget 5
DK-7400 Herning

Tel. +45 9711 9600
www.acofunki.com
www.egebjerg.com

FUNKI

Danish Design | German Quality | Global Experience

ART. NR. 0223-240 OVERVIEW

ASSEMBLING OF THE FEED DISPENSOR SHALL FOLLOW THE ILLUSTRATED STEPS IN THIS INSTRUCTION.

NB!

Volume dispenser VD 100 is delivered unasssembled.

All screws and nuts are collected in a plastic bag.

Plastic bag and steel parts are delivered in one box.

STEEL PARTS

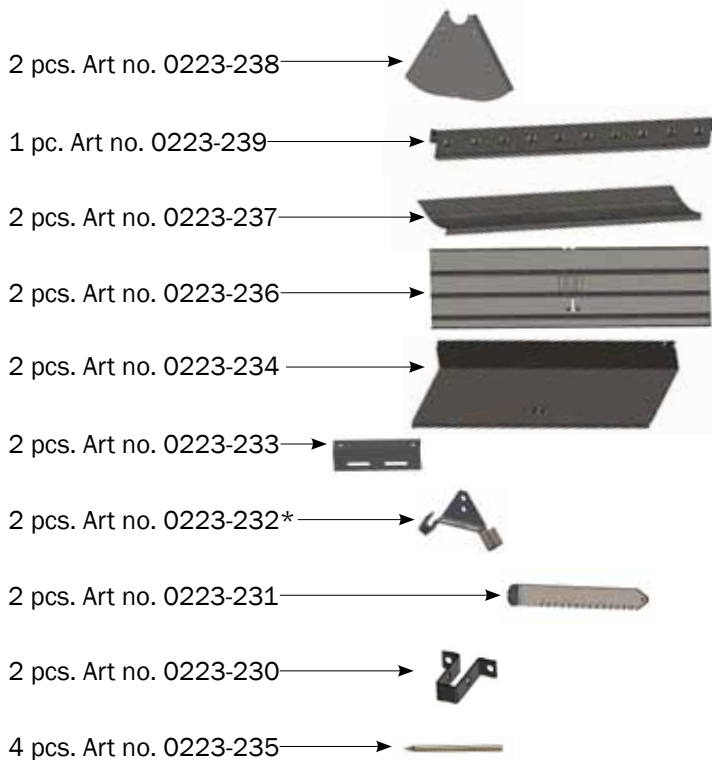

OTHER PARTS

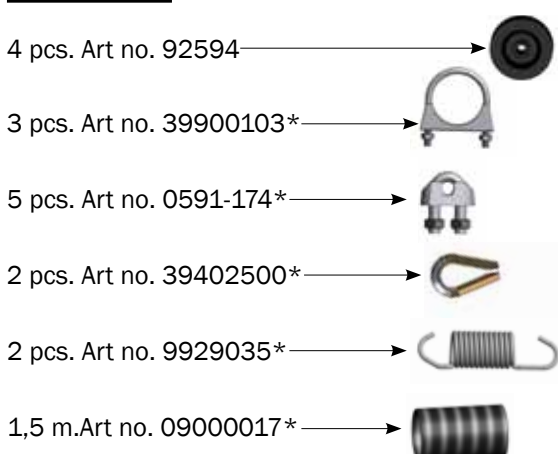

SCREWS AND NUTS



*Parts are used for mounting feed dispenser on feeding pipe.

1

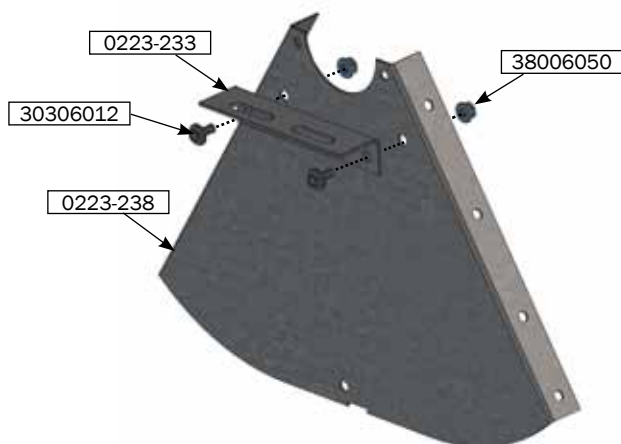

2

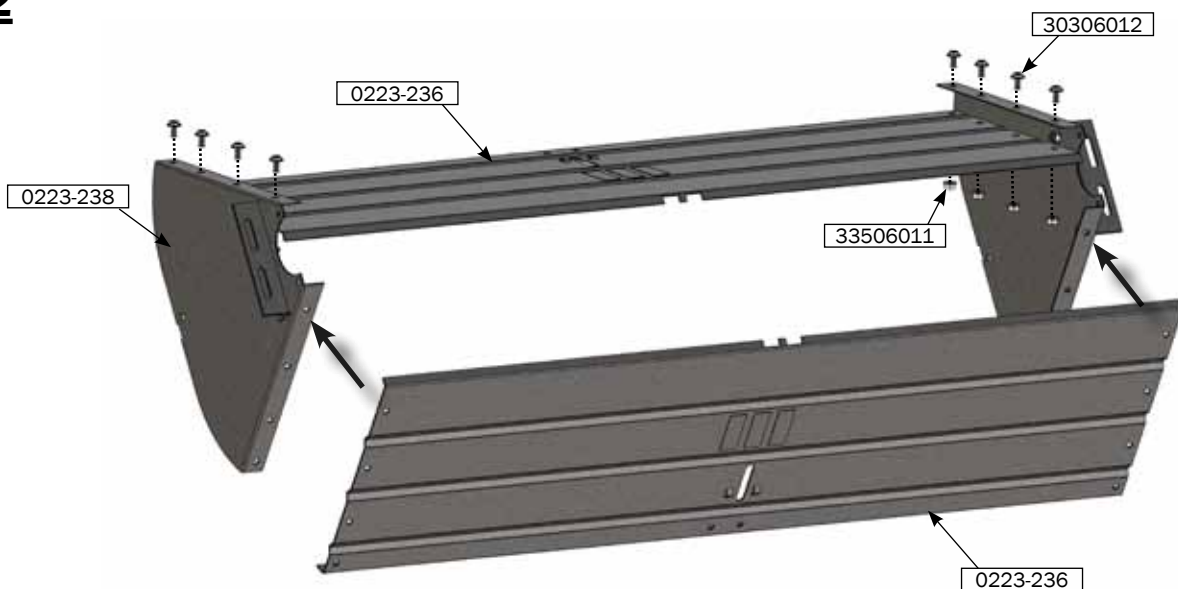

3

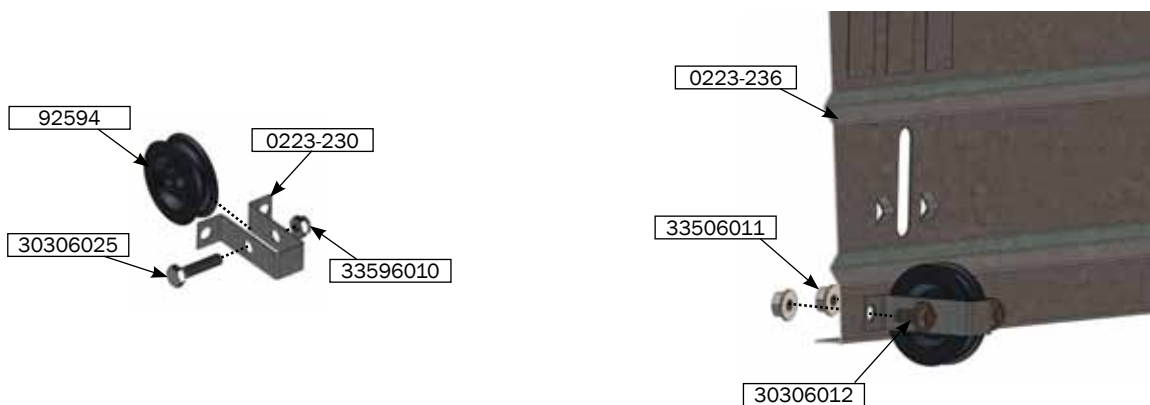

4

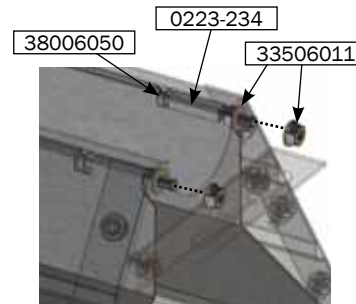
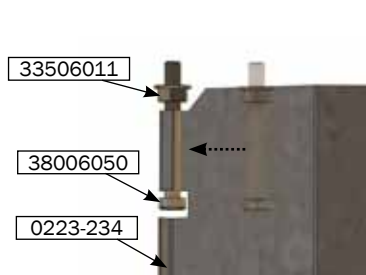
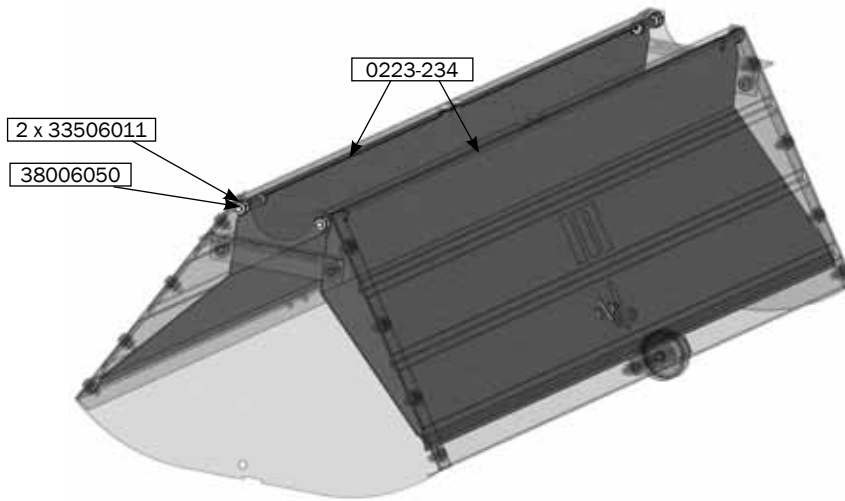

The screws must be adjusted so there is 1 mm air in both sides.

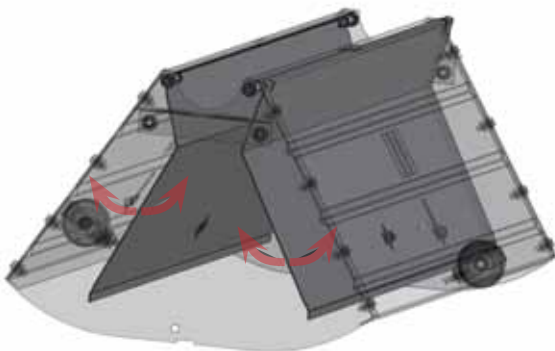

Check that the inner flaps are able to swing without any obstructions.

5

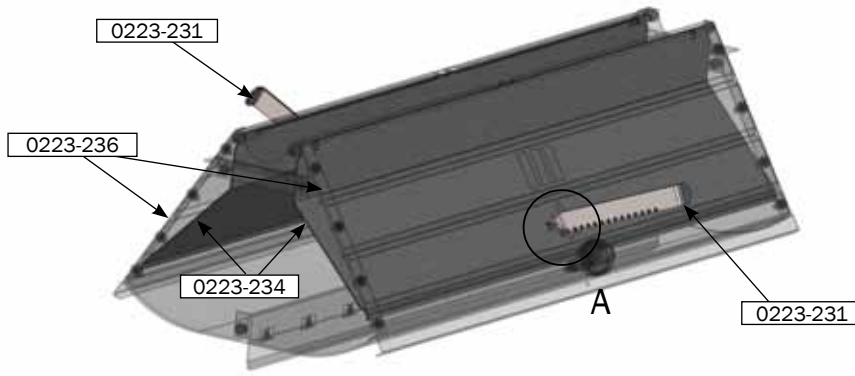

A

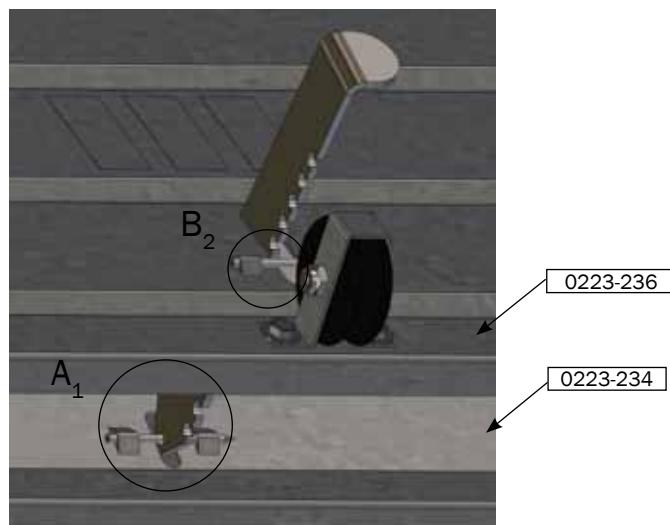

A₁

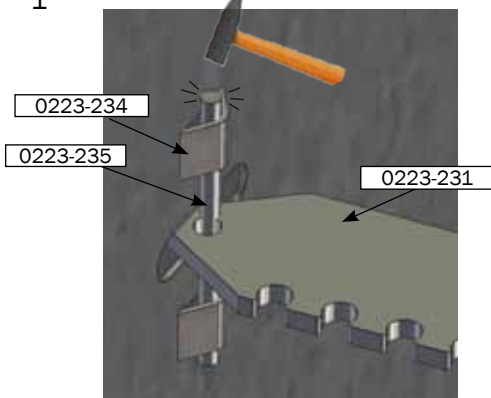

B₂

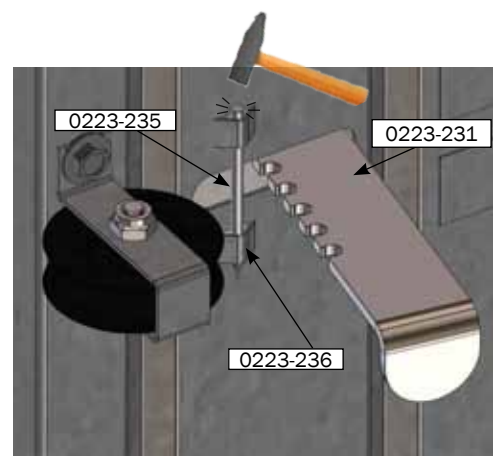

6

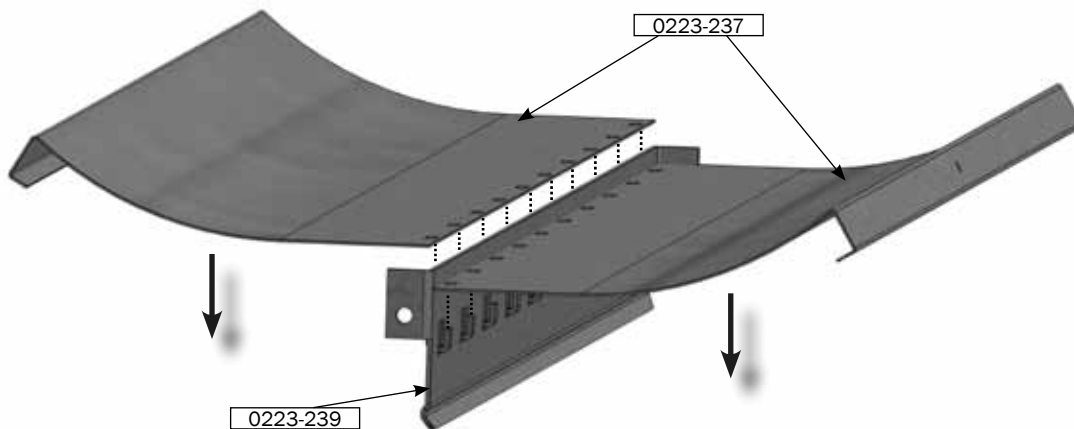
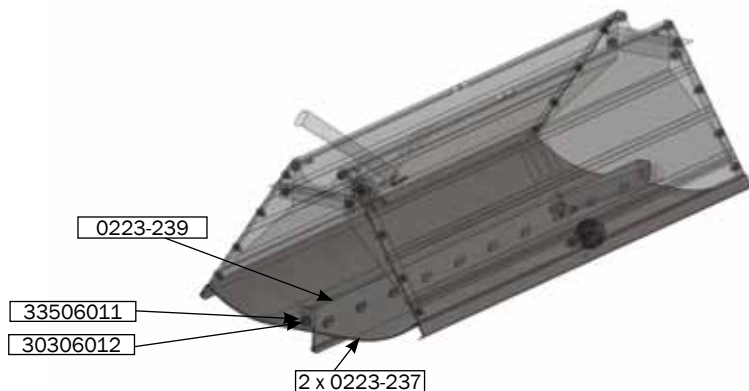

7

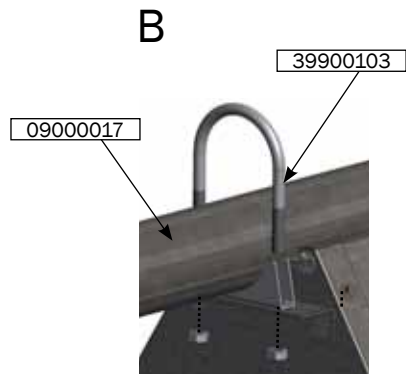
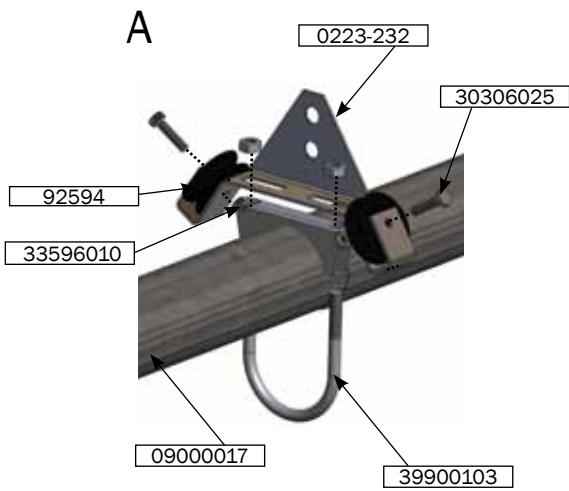
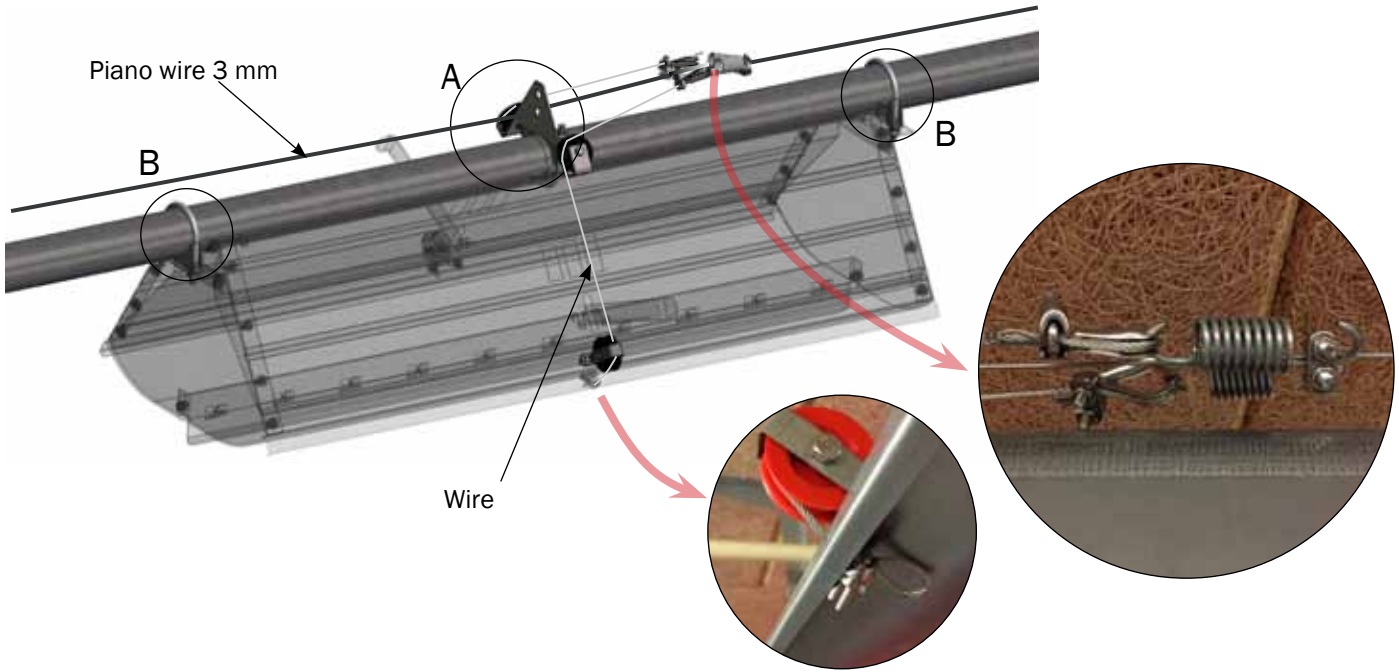

Parts for mounting VD 100 on pipe

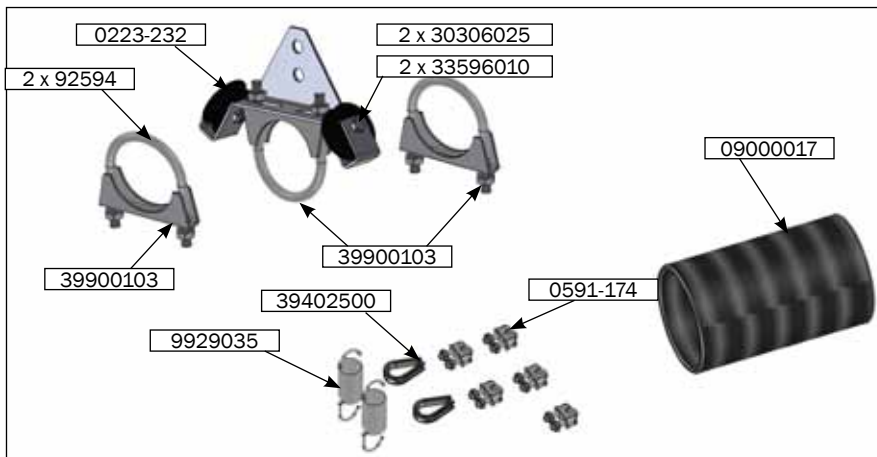

VD100 MOUNTING ON FEEDING PIPE

WIRE DIRECTION

Wire left montage

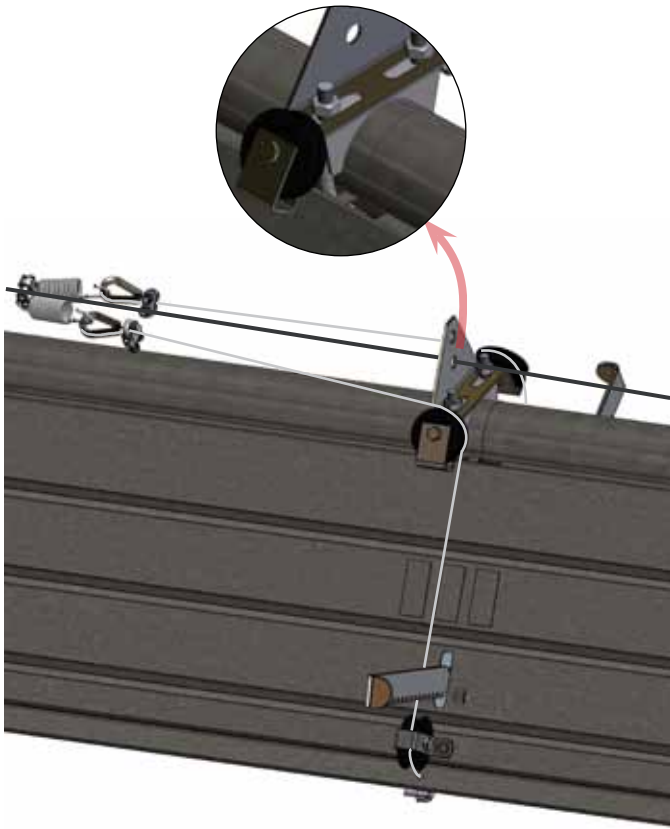

Wire right montage

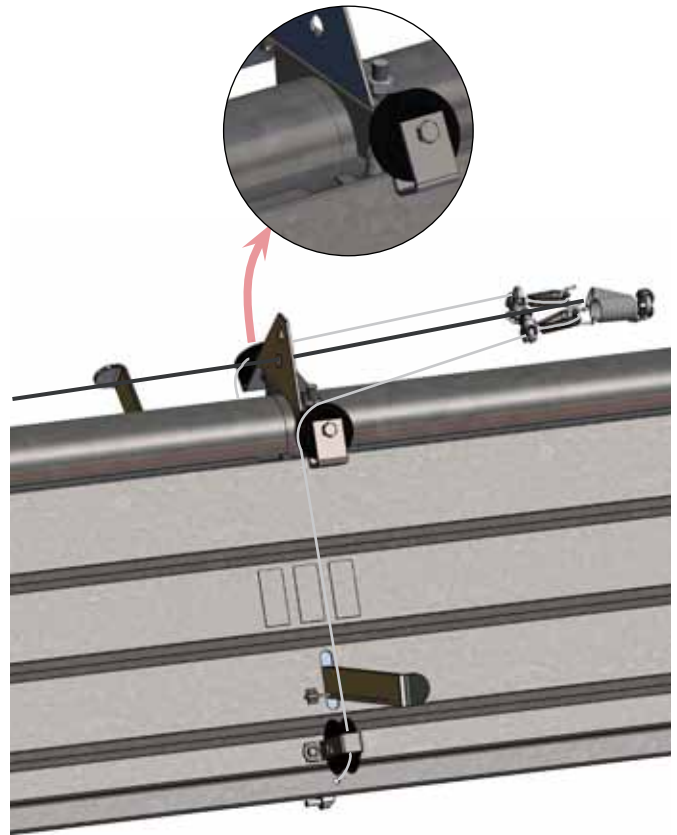

DRILLING OUTLET HOLES IN Ø60 MM FEEDING PIPE

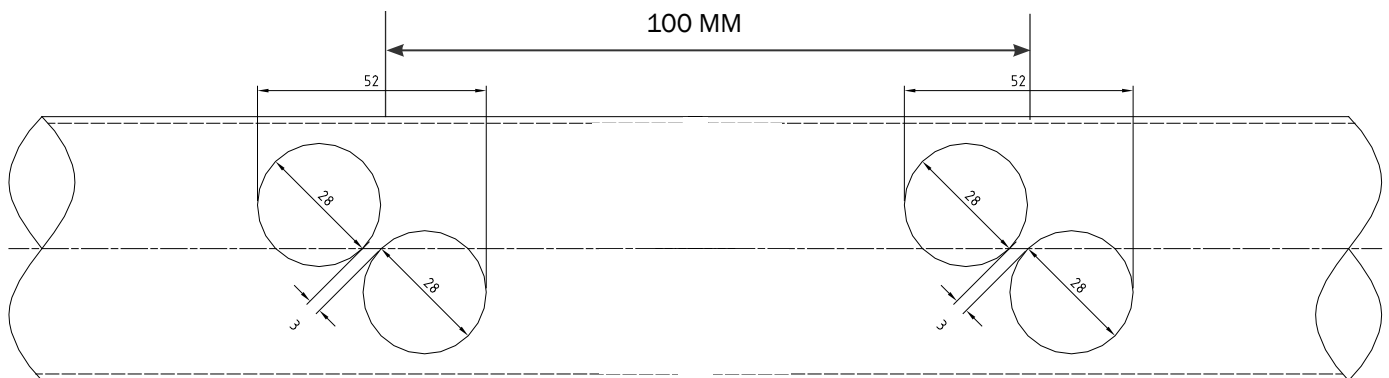

For optimum transport duct emptying two Ø28 mm holes should be drilled. The holes should be staggered in relation to each other.

There should be drilled 9 holes set every 100 mm per feed dispenser.

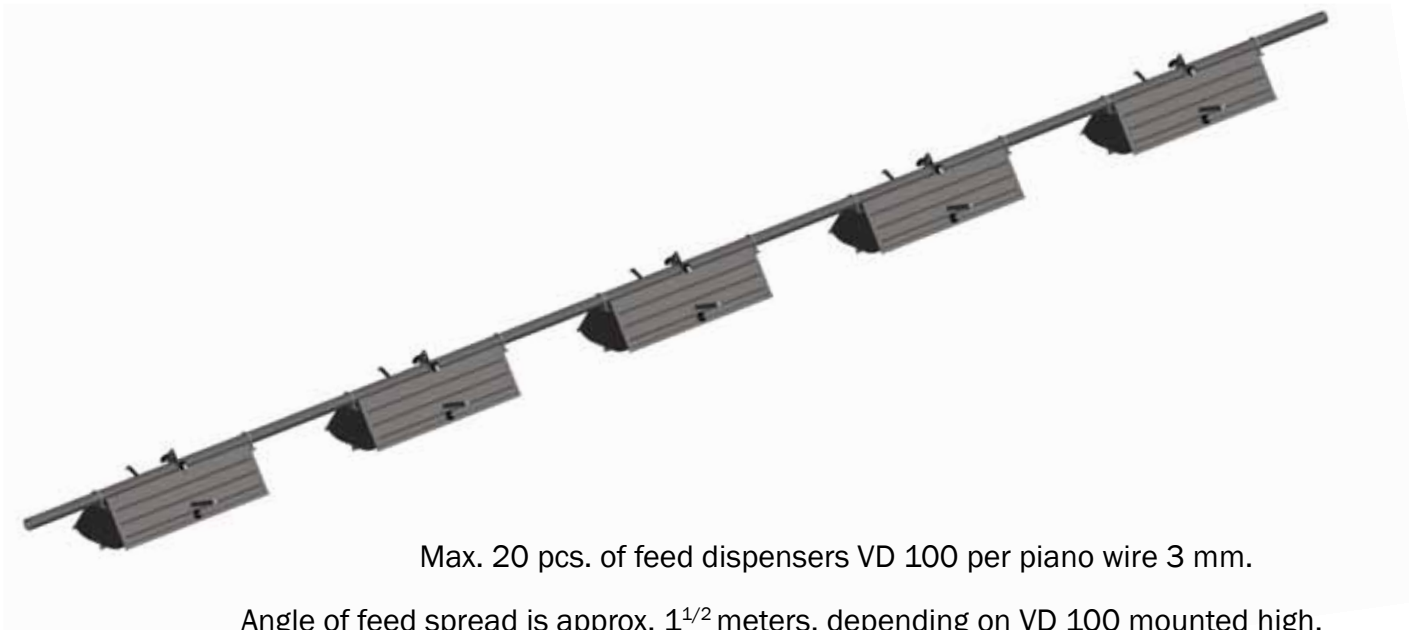

Max. 20 pcs. of feed dispensers VD 100 per piano wire 3 mm.
 Angle of feed spread is approx. 1^{1/2} meters, depending on VD 100 mounted high.

Suggested mounting measurements

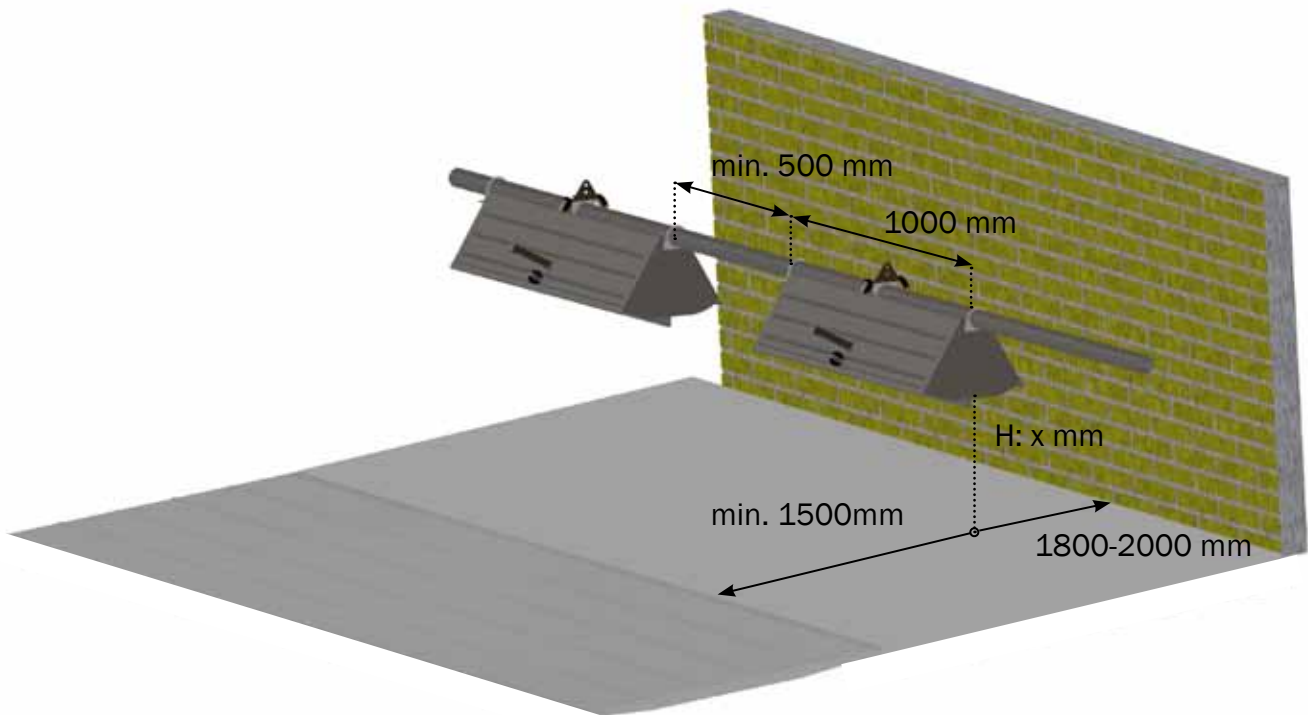

VD100 MOUNTING TO THE CEILING

VD100 must be mounted to the ceiling with wire as it is shown on pictures.

